



AIR-COOLED SCROLL CHILLERS

RENEWAL PARTS

Supersedes: 150.72-RP1 (114)

Form 150.72-RP1 (1117)

MODELS YLAA0070 - YLAA0175 DESIGN SERIES A, B & C DEVELOPMENT LEVEL A

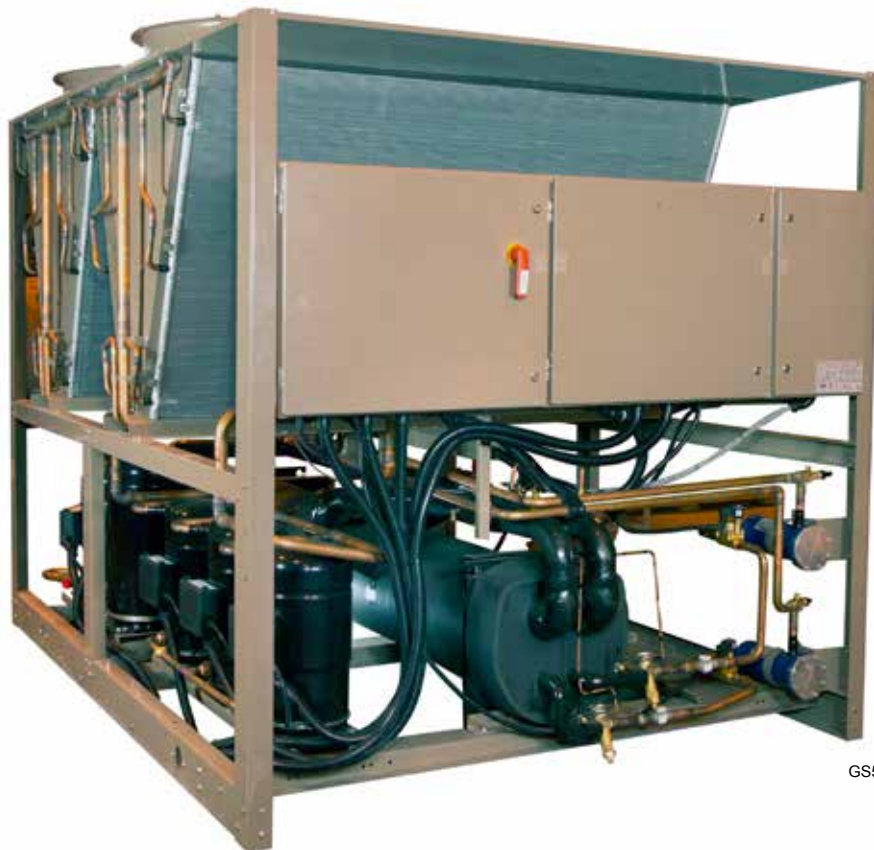

GS560418

**R-410A
70 - 175 TON
60 Hz**



Issue Date:
November 17, 2017



IMPORTANT!

READ BEFORE PROCEEDING!

GENERAL SAFETY GUIDELINES

This equipment is a relatively complicated apparatus. During installation, operation maintenance or service, individuals may be exposed to certain components or conditions including, but not limited to: refrigerants, materials under pressure, rotating components, and both high and low voltage. Each of these items has the potential, if misused or handled improperly, to cause bodily injury or death. It is the obligation and responsibility of operating/service personnel to identify and recognize these inherent hazards, protect themselves, and proceed safely in completing their tasks. Failure to comply with any of these requirements could result in serious damage to the equipment and the property in

which it is situated, as well as severe personal injury or death to themselves and people at the site.

This document is intended for use by owner-authorized rigging, installation, and operating/service personnel. It is expected that these individuals possess independent training that will enable them to perform their assigned tasks properly and safely. It is essential that, prior to performing any task on this equipment, this individual shall have read and understood the on-product labels, this document and any referenced materials. This individual shall also be familiar with and comply with all applicable industry and governmental standards and regulations pertaining to the task in question.

SAFETY SYMBOLS

The following symbols are used in this document to alert the reader to specific situations:



Indicates a possible hazardous situation which will result in death or serious injury if proper care is not taken.



Identifies a hazard which could lead to damage to the machine, damage to other equipment and/or environmental pollution if proper care is not taken or instructions and are not followed.



Indicates a potentially hazardous situation which will result in possible injuries or damage to equipment if proper care is not taken.

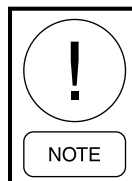

Highlights additional information useful to the technician in completing the work being performed properly.



External wiring, unless specified as an optional connection in the manufacturer's product line, is not to be connected inside the control cabinet. Devices such as relays, switches, transducers and controls and any external wiring must not be installed inside the micro panel. All wiring must be in accordance with Johnson Controls' published specifications and must be performed only by a qualified electrician. Johnson Controls will NOT be responsible for damage/problems resulting from improper connections to the controls or application of improper control signals. Failure to follow this warning will void the manufacturer's warranty and cause serious damage to property or personal injury.

CHANGEABILITY OF THIS DOCUMENT

In complying with Johnson Controls' policy for continuous product improvement, the information contained in this document is subject to change without notice. Johnson Controls makes no commitment to update or provide current information automatically to the manual or product owner. Updated manuals, if applicable, can be obtained by contacting the nearest Johnson Controls Service office or accessing the Johnson Controls QuickLIT website at <http://cgproducts.johnsoncontrols.com>.

It is the responsibility of rigging, lifting, and operating/service personnel to verify the applicability of these documents to the equipment. If there is any question

regarding the applicability of these documents, rigging, lifting, and operating/service personnel should verify whether the equipment has been modified and if current literature is available from the owner of the equipment prior to performing any work on the chiller.

CHANGE BARS

Revisions made to this document are indicated with a line along the left or right hand column in the area the revision was made. These revisions are to technical information and any other changes in spelling, grammar or formatting are not included.

HOW TO USE RENEWAL PARTS MANUALS

Johnson Controls offers an assortment of replacements parts for Johnson Controls, YORK and UPG units. Each replacement part is manufactured and fitted for a specific model. This Replacement Parts Manual is for standard Johnson Controls units. Chiller units built with special options, modifications, or conversions are not covered in this manual.

This Replacement Parts Manual provides Johnson Controls chiller replacement parts by part numbers, descriptions, quantities and drawing figures. To determine the correct replacement part, locate the item on drawing figure and refer to the parts list for the part number, description and quantity.

NOTE: Provide a unit model number, unit serial number and part number when requesting a quotation or placing an order. Failure to include this information may delay processing of your request.

Model and Serial Number Locations:

- **Unit** - Namplate on side of Control Panel
- **Compressor** - Namplate on Compressor Housing
- **VSD** - Namplate on VSD Panel

Contact the following sources to order parts.

NORTH AMERICA

Baltimore Parts Center

Contrators within USA

Telephone: (800)-932-1701

Equipment Owners within USA who maintain their own equipment

Telephone: (800)-482-2778

Email: cg-baltimore-parts-customer@jci.com

For parts availability and ordering YORK HVAC

Parts within the USA please use the following link:

http://www.johnsoncontrols.com/content/us/en/products/building_efficiency/products-and-systems/integrated_hvac_systems/parts_center/baltimorepartscenter.html

EUROPE

HVAC Parts Centre (Europe)

Telephone: +44 (0) 1268 246 400

Email: ALLParts@jci.com

UNIT NOMENCLATURE NAMEPLATE ENGINEERING DATA

BASIC PART NUMBER

YLAA0091SE46XAA

| 1 | 2 | 3 | 4 | 5 | 6 | 7 | 8 | 9 | 10 | 11 | 12 | 13 | 14 | 15 |
|---|---|---|---|--|---|---|---|---|-------------|--|----|----|--|----|
| BASE PRODUCT TYPE | | | | NOMINAL CAPACITY | | | | UNIT DESIGNATOR | REFRIGERANT | VOLTAGE/STARTER | | | DESIGN/DEVELOPMENT LEVEL | |
| Y | L | A | | # | # | # | # | S | E | 1 | 7 | | A | |
| : YORK : Chiller : Air Cooled A : Scroll | | | | Tons 0070 0080 0090 0091 0101 0115 0120 0135 0150 0155 | | | | Standard Efficiency High Efficiency Heat Pump Standard Efficiency (Round Tube) High Efficiency (Round Tube) | :R-410A | :200/3/60 :230/3/60 :380/3/60 :460/3/60 :380-415/3/50 :575/3/60 X :Across the Line | | | :Design Series A :Design Series B :Engineering Change or PIN Level | |

PART NUMBER – LETTER CODES

| 16 17 18 19 POWER FIELD | 20 21 22 23 24 25 26 27 28 CONTROLS FIELD | 29 30 31 32 33 34 35 36 37 COMPRESSOR / PIPING FIELD |
|---|--|---|
| X X : MP Terminal Block S X : SP Terminal Block S D : SP NF Disconnect Switch B X : SP Circuit Breaker D B : SP NF Disc Sw w/ Ind. Sys. CB M X : MP TB w/ Ind. Sys. CB M D : MP NF Disconnect Switch X : No Transformer Required T : Transformer 115/24V (factory) Q : Special Transformer Required X : No Power Factor Capacitor C : Power Factor Capacitor Q : Special Power Factor Capacitor | X : No Ambient Kit L : Low Ambient Kit (factory) H : High Ambient Kit (factory) A : High & Low Ambient Kit (factory) T : BAS/EMS Temp. Reset / Offset S : Spanish LCD & Keypad Display F : French LCD & Keypad Display G : German LCD & Keypad Display I : Italian LCD & Keypad Display H : Hungarian LCD & Keypad Display L : Polish LCD & Keypad Display P : Portuguese LCD & Keypad Display B : Both Disc & Suct Transducer Readout L : N. American Safety Code (cUL/cETL) C : European Safety Code (CE) C : Motor Current Module O : OptiView Remote Panel S : Sequence Control & Automatic Lead Transfer | # : Low Temp. Brine (LBrT) C : Chicago Relief Code S : Service Isolation Valve B : Both Chicago & Isolat. 1 : Hot Gas By-Pass (# circuits) H : Heater (Standard) |

MP = Multiple Point
SP = Single Point
NF = Non-Fused
TB = Terminal Block
CB = Circuit Breaker

| 38 39 40 41 42 43 44 EVAP. FIELD | 45 46 47 CONDENSER FIELD | 48 49 50 51 52 53 54 CABINET FIELD |
|--|--|---|
| X :150# PSI DWP 3 :300# PSI DWP D :Double Thick Insulation V :Victaulic Flange S :One Flow Switch T :Two Flow Switches U :Three Flow Switches D :One Diff. Press. Switch E :Two Diff. Press. Switches F :Three Diff. Press. Switches A :ASME Press Vessel Codes E :PED Press Vessel Codes R :Remote Cooler | X : Aluminum C : Copper B : Black Fin P : Phenolic X : TEAO Fan Motors | 1 : Wire (Full Unit) Encl. Panels (factory) 3 : Wire/Louvered Encl. Panels (factory) 5 : Louvered (Cond. Only) Encl. Panels (factory) 7 : Louvered (Full Unit) Encl. Panels (factory) 9 : End Louver (Hail Guard) Enc. Panels (factory) B : Acoustic Sound Blanket E : Acoustic Enclosure L : Ultra Quiet Fans G : High Airflow Fans H : High Static Fans T : Two Speed Fans 1 : 1" Deflection S : Seismic N : Neoprene Pads |
| 61 PLANT OF MANUFACTURE R : Monterrey S : Sabadell CUR : Curitiba, Brazil MEX : Mexico, ES MTY : Monterrey, BE SAT : San Antonio, Texas | | |

NOTES:
 1. Q :DENOTES SPECIAL / S.Q.
 2. # :DENOTES STANDARD
 3. X :w/in OPTIONS FIELD, DENOTES NO OPTION SELECTED
 4. Agency Files (i.e. U.L. / ETL; CE; ARI; ETC.) will contain info. based on the first 14 characters only.
 5. Plant of manufacture to include PIN 56 upon entering the chiller order.

LIST OF TABLES

| | |
|---|----|
| TABLE 1 - Evaporator Components - 150 PSIG | 7 |
| TABLE 2 - Microchannel Condenser Coil Components - Design Series "A" | 10 |
| TABLE 3 - Condenser Coil Components - Design Series "B" | 12 |
| TABLE 4 - Fan Components | 14 |
| TABLE 5 - Refrigerant Piping Components | 15 |
| TABLE 6 - Hot Gas By-Pass Components..... | 18 |
| TABLE 7 - Compressor Part Numbers - R-410A | 19 |
| TABLE 8 - Recommended Compressor Oil Type | 22 |
| TABLE 9 - Compressor Heater And Sound Blanket Part Numbers | 22 |
| TABLE 10 - Compressor Components..... | 22 |
| TABLE 11 - Control Panel And Power Panel Identifiers | 24 |
| TABLE 12 - Power Panel Components - YLAA0070 | 28 |
| TABLE 13 - Power Panel Components - YLAA0080 | 29 |
| TABLE 14 - Power Panel Components - YLAA0090 | 30 |
| TABLE 15 - Power Panel Components - YLAA0091 | 31 |
| TABLE 16 - Power Panel Components - YLAA0100 & YLAA0101 | 32 |
| TABLE 17 - Power Panel Components - YLAA0115..... | 33 |
| TABLE 18 - Power Panel Components - YLAA0135 & YLAA0141 | 34 |
| TABLE 19 - Power Panel Components - YLAA0120 & YLAA0125..... | 35 |
| TABLE 20 - Power Panel Components YLAA0150..... | 36 |
| TABLE 21 - Power Panel Components - YLAA0155 & YLAA0156 | 37 |
| TABLE 22 - Power Panel Components - YLAA0170 & YLAA0175..... | 38 |
| TABLE 23 - Lug Kits (Circuit Breaker Or Non-Fused Disconnect Switch) | 39 |
| TABLE 24 - Power Panel Fuse Table..... | 39 |
| TABLE 25 - Control Panel Components | 41 |
| TABLE 26 - Sensor Harness Wiring - YLAA0070, 0080, 0090, 0101, 0135, 0150 & YLAAA0155 | 42 |
| TABLE 27 - Sensor Harness Wiring - YLAA0091, 0115 & YLAAA0120..... | 42 |
| TABLE 28 - Transducers, Pressure Cutouts And Temp Sensors..... | 45 |
| TABLE 29 - Transducer And Thermistor Wire Harness Connectors - Field Replacement Part Numbers..... | 46 |
| TABLE 30 - Vibration Isolators Part Numbers..... | 47 |
| TABLE 31 - Field Installed Options Part Numbers..... | 48 |
| TABLE 32 - Control Transformer Kit | 48 |
| TABLE 33 - Enclosure Kit Options | 49 |
| TABLE 34 - Wire Enclosure | 50 |
| TABLE 35 - Louvered Enclosure..... | 51 |
| TABLE 36 - Recommended Spare Parts - YLAA0070-YLAA0175 Chillers | 52 |

LIST OF FIGURES

| | |
|---|----|
| FIGURE 1 - Evaporator Components..... | 9 |
| FIGURE 2 - Microchannel Condenser Coil Components - Design Series "A"..... | 10 |
| FIGURE 3 - Microchannel Condenser Coil Components - Design Series "A" | 11 |
| FIGURE 4 - Condenser Coil Components Design Series "B" - YLA0091, YLA0101, YLA0115 & YLA0120 Shown..... | 13 |
| FIGURE 5 - Fan Components..... | 14 |
| FIGURE 6 - Refrigerant Piping Components - Models YLA0070, YLA0080 & YLA0090 Shown..... | 17 |
| FIGURE 7 - Hot Gas By-Pass Components..... | 18 |
| FIGURE 8 - Compressor Layouts..... | 21 |
| FIGURE 9 - Compressor..... | 22 |
| FIGURE 10 - Panel Door Lock And Key..... | 23 |
| FIGURE 11 - Panel Part Number Sticker..... | 26 |
| FIGURE 12 - Power Panel Components..... | 27 |
| FIGURE 13 - Control Panel Components..... | 40 |
| FIGURE 14 - Control Panel Components..... | 41 |
| FIGURE 15 - Harness Layout..... | 43 |
| FIGURE 16 - Harness Layout..... | 44 |
| FIGURE 17 - Sensor Housing & Pin Socket Part Numbers..... | 44 |
| FIGURE 18 - Transducers, Pressure Cutouts And Temp Sensors..... | 45 |
| FIGURE 19 - Transducer And Thermistor Wire Harness Connectors - Field Replacement Part Numbers..... | 46 |
| FIGURE 20 - Wire Enclosure - Models YLA0070, YLA0080 & YLA0090 Shown..... | 50 |
| FIGURE 21 - Louvered Enclosure..... | 51 |

EVAPORATOR COMPONENTS

TABLE 1 - EVAPORATOR COMPONENTS - 150 PSIG

| ITEM | QUANTITY | DESCRIPTION | DWP | YLAA0070 | YLAA0080 | FIGURE |
|------|----------|-------------------------------------|-----|---------------|---------------|--------|
| 1 | 1 | Cooler, Fully Insulated with Heater | ALL | 375-75061-001 | 375-75064-001 | 1 |
| | | Cooler, less Heater & Insulation | | 375-75062-000 | 375-75065-000 | 1 |
| 2 | 1 | Head, Connection End | ALL | 375-71203-000 | 375-67289-000 | 1 |
| 3 | 1 | Head, Back End | ALL | 075-71205-000 | 075-65741-003 | 1 |
| 4 | 1 | Baffle, Connection End | ALL | 375-71206-000 | 375-67287-000 | 1 |
| 5 | 1 | Baffle, Back End | ALL | 375-71208-000 | 375-67288-000 | 1 |
| 6 | 8 | Gasket, Baffle and Head | ALL | 075-71210-000 | 075-65741-004 | 1 |
| 7 | 1 | Heater, Cooler 180 Watt | ALL | 025-22690-000 | 025-22690-000 | 1 |
| | 1 | Heater, Cooler 280 Watt | | 025-22691-000 | 025-22691-000 | 1 |
| 9 | 2 | Well, Thermo | ALL | 026-32328-000 | 026-32328-000 | 1 |
| 10 | - | Insulation (3/4"x49"x65") | ALL | 010-05997-000 | 010-05997-000 | 1 |
| | - | Insulation (1 1/2"x49"x65") | | 010-05998-000 | 010-05998-000 | 1 |
| 11 | 2 | Sensor, Water Temperature | ALL | 025-47669-000 | 025-47669-000 | 1 |
| 12 | 1 | Adhesive (Use with #6) | ALL | 013-03311-000 | 031-03311-000 | 1 |

| ITEM | QUANTITY | DESCRIPTION | DWP | YLAA0090 | YLAA0091, 0100, 0101, 0115 AND YLAA0125 | FIGURE |
|------|----------|-------------------------------------|-----|---------------|--|--------|
| 1 | 1 | Cooler, Fully Insulated with Heater | ALL | 375-75058-001 | 375-75055-001 | 1 |
| | | Cooler, less Heater & Insulation | | 375-75059-000 | 375-75056-000 | 1 |
| 2 | 1 | Head, Connection End | ALL | 375-67628-000 | 375-71454-000 | 1 |
| 3 | 1 | Head, Back End | ALL | 075-67624-002 | 075-71457-000 | 1 |
| 4 | 1 | Baffle, Connection End | ALL | 375-67626-000 | 375-71458-000 | 1 |
| 5 | 1 | Baffle, Back End | ALL | 075-67627-000 | 375-71460-000 | 1 |
| 6 | 4 | Gasket, Baffle and Head | ALL | 075-67624-003 | 075-71467-000 | 1 |
| 7 | 1 | Heater, Cooler 180 Watt | ALL | 025-22690-000 | 025-22690-000 | 1 |
| | 1 | Heater, Cooler 280 Watt | | 025-22691-000 | 025-22691-000 | 1 |
| 9 | 2 | Well, Thermo | ALL | 026-32328-000 | 026-32328-000 | 1 |
| 10 | - | Insulation (3/4"x49"x65") | ALL | 010-05997-000 | 010-05997-000 | 1 |
| | - | Insulation (1 1/2"x49"x65") | | 010-05998-000 | 010-05998-000 | 1 |
| 11 | 2 | Sensor, Water Temperature | ALL | 025-47669-000 | 025-47669-000 | 1 |
| 12 | 1 | Adhesive (Use with #6) | ALL | 013-03311-000 | 031-03311-000 | 1 |

EVAPORATOR COMPONENTS (CONT'D)

TABLE 1 - EVAPORATOR COMPONENTS - 150 PSIG (CONT'D)

| ITEM | QUANTITY | DESCRIPTION | DWP | YLAA0120, 0141 AND YLAA0155 | YLAA0135, 0150, 0156 AND YLAA0170 | FIGURE |
|------|----------|-------------------------------------|-----|--------------------------------|---|--------|
| 1 | 1 | Cooler, Fully Insulated with Heater | ALL | 375-75067-001 | 375-74998-001 | 1 |
| | | Cooler, less Heater & Insulation | | 375-75068-000 | 375-74999-000 | 1 |
| 2 | 1 | Head, Connection End | ALL | 375-72131-000 | 375-75006-000 | 1 |
| 3 | 1 | Head, Back End | ALL | 075-72132-001 | 075-75010-000 | 1 |
| 4 | 1 | Baffle, Connection End | ALL | 375-71834-000 | 375-75002-000 | 1 |
| 5 | 1 | Baffle, Back End | ALL | 075-72130-000 | 375-75004-000 | 1 |
| 6 | 8 | Gasket, Baffle and Head | ALL | 075-72133-000 | 075-49360-000 | 1 |
| 7 | 1 | Heater, Cooler 180 Watt | ALL | 025-22690-000 | 025-22690-000 | 1 |
| | 1 | Heater, Cooler 280 Watt | | 025-22691-000 | 025-22691-000 | 1 |
| 9 | 2 | Well, Thermo | ALL | 026-32328-000 | 026-32328-000 | 1 |
| 10 | - | Insulation (3/4"x49"x65") | ALL | 010-05997-000 | 010-05997-000 | 1 |
| | - | Insulation (1 1/2"x49"x65") | | 010-05998-000 | 010-05998-000 | 1 |
| 11 | 2 | Sensor, Water Temperature | ALL | 025-47669-000 | 025-47669-000 | 1 |
| 12 | 1 | Adhesive (Use with #6) | ALL | 013-03311-000 | 031-03311-000 | 1 |

| ITEM | QUANTITY | DESCRIPTION | DWP | YLAA0175 | FIGURE |
|------|----------|-------------------------------------|-----|---------------|--------|
| 1 | 1 | Cooler, Fully Insulated with Heater | ALL | 375-76135-001 | 1 |
| | | Cooler, less Heater & Insulation | | 375-76136-000 | 1 |
| 2 | 1 | Head, Connection End | ALL | 375-67887-000 | 1 |
| 3 | 1 | Head, Back End | ALL | 075-67892-002 | 1 |
| 4 | 1 | Baffle, Connection End | ALL | 375-67888-000 | 1 |
| 5 | 1 | Baffle, Back End | ALL | 375-67891-000 | 1 |
| 6 | 8 | Gasket, Baffle and Head | ALL | 075-84276-000 | 1 |
| 7 | 2 | Heater, Cooler 280 Watt | ALL | 025-22691-000 | 1 |
| 9 | 2 | Well, Thermo | ALL | 026-32328-000 | 1 |
| 10 | - | Insulation (3/4"x49"x65") | ALL | 010-05997-000 | 1 |
| | - | Insulation (1 1/2"x49"x65") | | 010-05998-000 | 1 |
| 11 | 2 | Sensor, Water Temperature | ALL | 025-47669-000 | 1 |
| 12 | 1 | Adhesive (Use with #6) | ALL | 013-03311-000 | 1 |
| 12 | 1 | Adhesive (Use with #6) | ALL | 013-03311-000 | 1 |

EVAPORATOR COMPONENTS (CONT'D)

Service Note:
Pin location 38 in Model Number will be "X" for 150# DWP Cooler .
Pin location 38 in Model Number will be "3" for 300# DWP Cooler

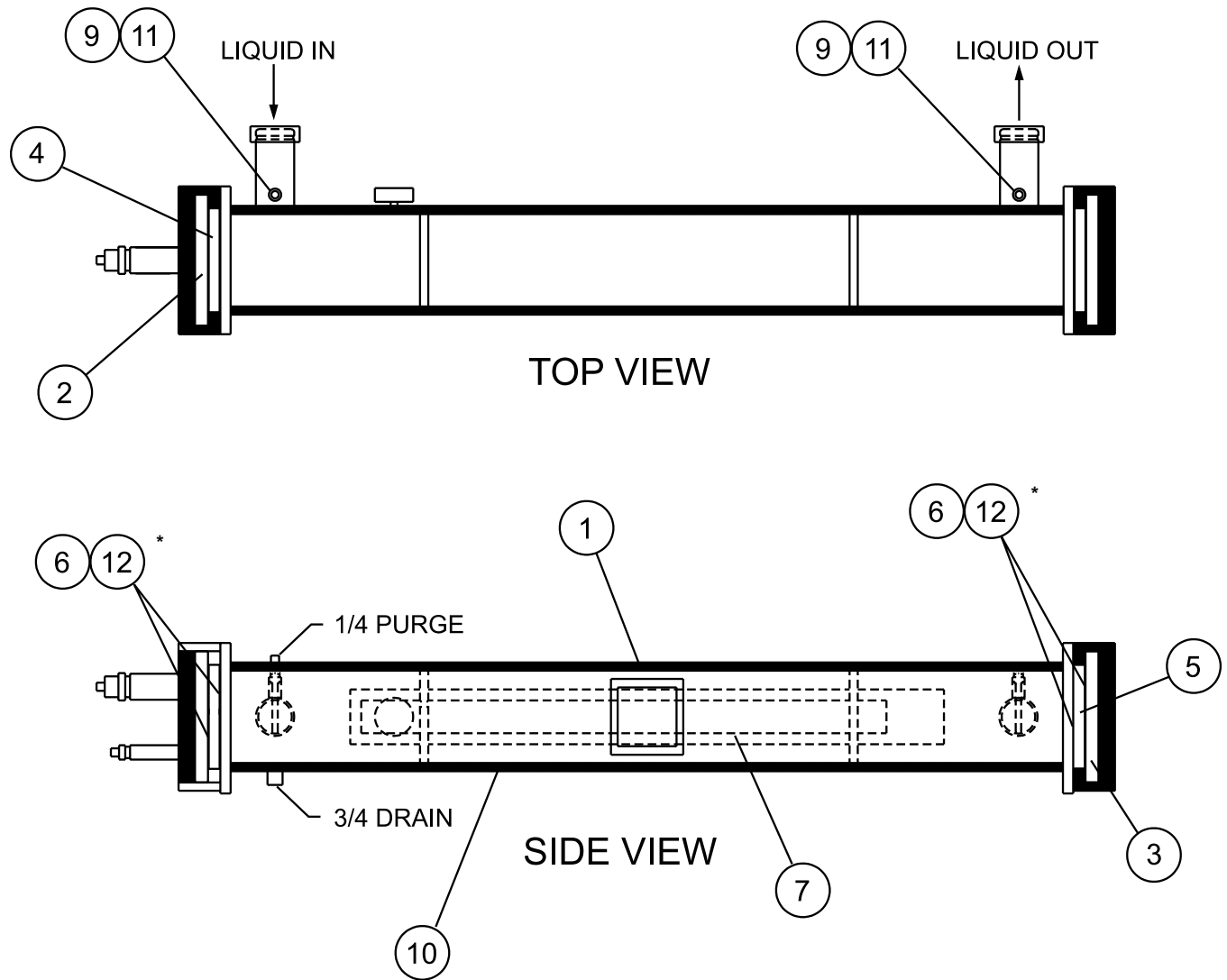

* Service Note: Torque 55 ft. lbs.
± 5 ft. lbs

30968-000

FIGURE 1 - EVAPORATOR COMPONENTS

CONDENSER COIL COMPONENTS CHILLER MODEL YLAA – DESIGN SERIES "A" OR "C" (MICROCHANNEL)

TABLE 2 - MICROCHANNEL CONDENSER COIL COMPONENTS - DESIGN SERIES "A"

| ITEM | DESCRIPTION | YORK PART NUMBER | QUANTITY | FIGURE |
|------|------------------------|------------------|----------|--------|
| 1 | Receiver, 6" Diameter | 026-45013-000 | 1 | 2 |
| 2 | Coil | 026-45535-000 | 2 | 2 |
| 3 | Pipe, Coil To Receiver | 075-77930-001 | 1 | 3 |
| 4 | Pipe, Coil To Receiver | 075-77930-002 | 1 | 3 |
| 5 | Pipe, Coil To Receiver | 075-77930-003 | 1 | 3 |
| 6 | Pipe, Coil To Receiver | 075-77930-003 | 1 | 3 |
| 7 | Clamp, Header | 075-74862-007 | 8 | 3 |
| 8 | Bushing | 028-15821-000 | 2 | 2 |

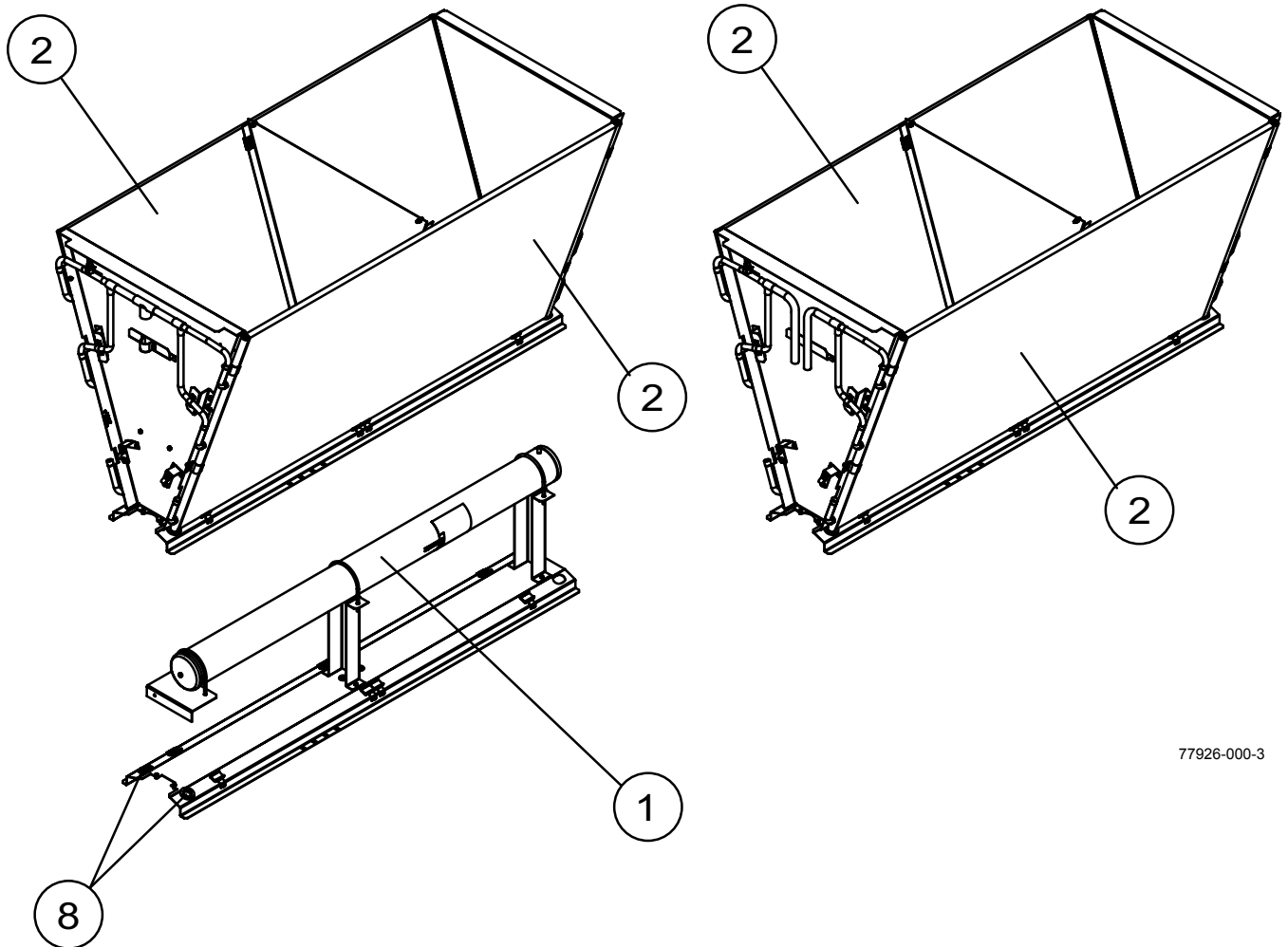

77926-000-3

FIGURE 2 - MICROCHANNEL CONDENSER COIL COMPONENTS - DESIGN SERIES "A"

CONDENSER COIL COMPONENTS (CONT'D) CHILLER MODEL YLAA –DESIGN SERIES "A" OR "C" (MICROCHANNEL)

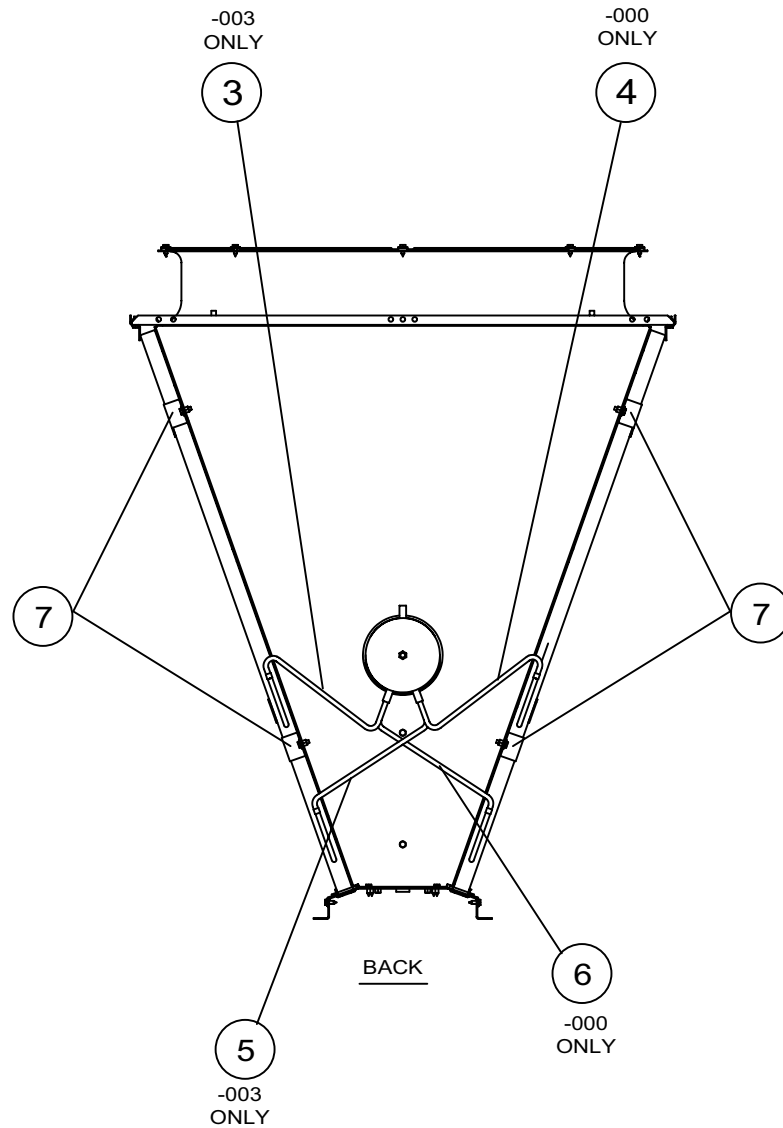

77926-000-1a

FIGURE 3 - MICROCHANNEL CONDENSER COIL COMPONENTS - DESIGN SERIES "A"

CONDENSER COIL COMPONENTS (CONT'D) CHILLER MODEL YLAA – DESIGN SERIES "B" (TUBE AND FIN)

TABLE 3 - CONDENSER COIL COMPONENTS - DESIGN SERIES "B"

| ITEM | DESCRIPTION | YLAA0070, YLAA0080 AND YLAA0090 | YLAA0091, YLAA0115 AND YLAA0120 | YLAA0101 | YLAA0135, YLAA0150 AND YLAA0155 | FIGURE |
|-----------------------------------|-------------|---------------------------------------|---------------------------------------|--------------------------|---------------------------------------|--------|
| ALUMINUM FIN COILS - 'PIN 45 = X' | | | | | | |
| 2 | Coil* | 375-75763-101 (Qty 2) | 375-75763-101 (Qty 3) | 375-75763-101 (Qty 3) | 375-75763-101 (Qty 4) | 4 |
| 3 | | 375-75763-102 (Qty 2) | 375-75763-102 (Qty 3) | 375-75763-102 (Qty 3) | 375-75763-102 (Qty 4) | 4 |
| BLACK FIN COILS - 'PIN 45 = B' | | | | | | |
| 2 | Coil* | 375-75763-105 (Qty 2) | 375-75763-105 (Qty 3) | 375-75763-105 (Qty 3) | 375-75763-105 (Qty 4) | 4 |
| 3 | | 375-75763-106 (Qty 2) | 375-75763-106 (Qty 3) | 375-75763-106 (Qty 3) | 375-75763-106 (Qty 4) | 4 |
| PHENOLIC COILS - 'PIN 45 = P' | | | | | | |
| 2 | Coil* | 375-75763-107 (Qty 2) | 375-75763-107 (Qty 3) | 375-75763-107 (Qty 3) | 375-75763-107 (Qty 4) | 4 |
| 3 | | 375-75763-108 (Qty 2) | 375-75763-108 (Qty 3) | 375-75763-108 (Qty 3) | 375-75763-108 (Qty 4) | 4 |
| COPPER COILS - 'PIN 45 = C' | | | | | | |
| 2 | Coil* | 375-75763-103 (Qty 2) | 375-75763-103 (Qty 3) | 375-75763-103 (Qty 3) | 375-75763-103 (Qty 4) | 4 |
| 3 | | 375-75763-104 (Qty 2) | 375-75763-104 (Qty 3) | 375-75763-104 (Qty 3) | 375-75763-104 (Qty 4) | 4 |

*NOTE: Coils include coil and headers.

CONDENSER COIL COMPONENTS (CONT'D) CHILLER MODEL YLAA – DESIGN SERIES "B" (TUBE AND FIN)

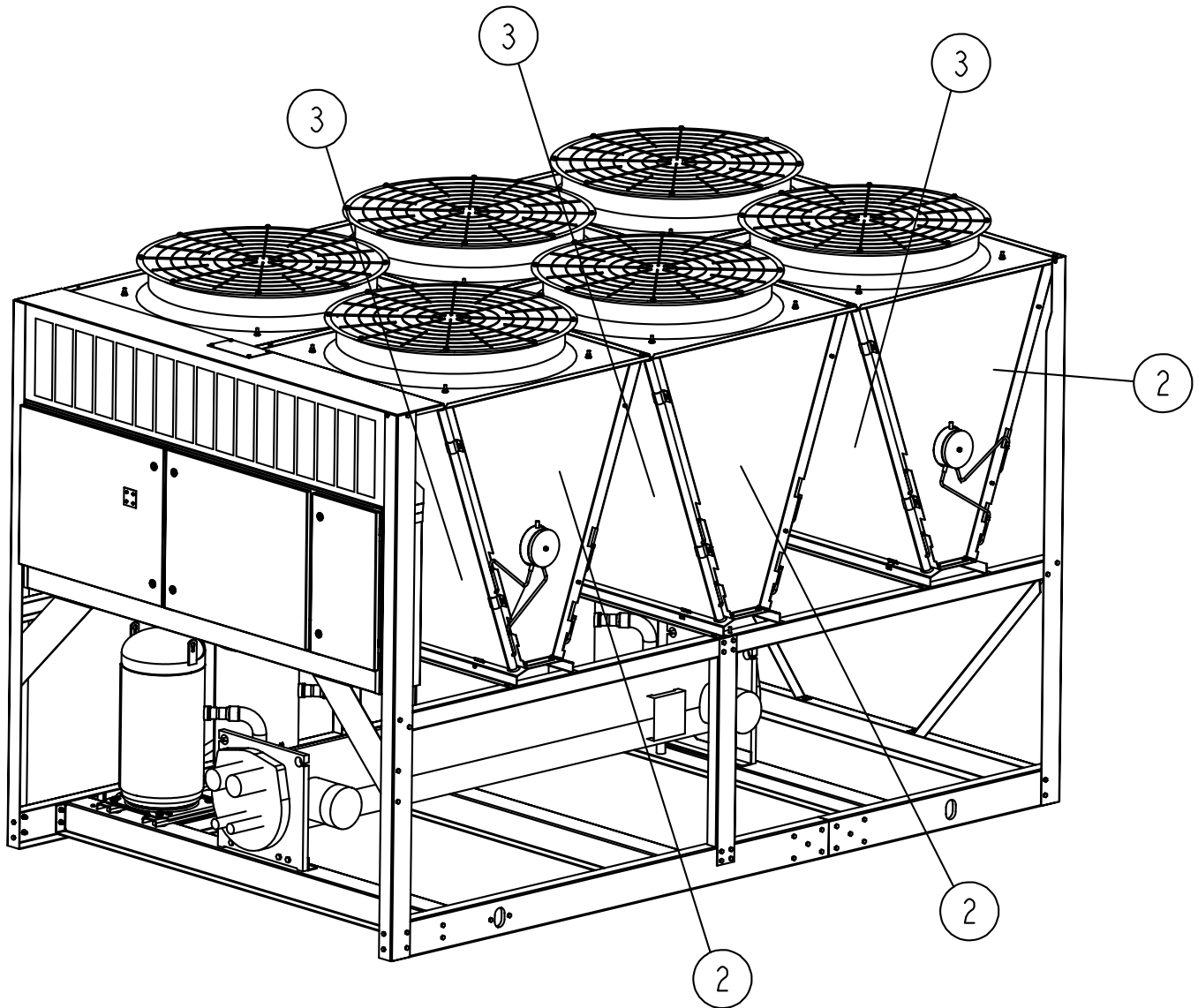

77927-2a

FIGURE 4 - CONDENSER COIL COMPONENTS DESIGN SERIES "B" - YLAA0091, YLAA0101, YLAA0115 & YLAA0120 SHOWN

FAN COMPONENTS

TABLE 4 - FAN COMPONENTS

| ITEM | DESCRIPTION | VOLTAGE CODE | FAN TYPE | | FIGURE |
|----------------|---|--------------|----------------------------|----------------------------|--------|
| | | | STANDARD 7/8", 1160 RPM | LOW NOISE 7/8", 850 RPM | |
| 1 ^S | Motor, Fan 2 HP (YLAA0070-YLAA0175) | -17 | 024-36873-103 | 024-34980-102 | 5 |
| | | -28 | 024-36873-106 | 024-34980-102 | |
| | | -40 | 024-36873-104 | 024-34980-105 | |
| | | -46 | 024-36873-107 | 024-34980-101 | |
| | | -58 | 024-36873-102 | 024-34980-104 | |
| 2 ^S | Blade | All | 026-41594-000 | 026-41942-000 | 5 |
| 3 | Guard | All | 026-35605-000 | | 5 |
| 4 | Orifice | All | 026-45002-000 | | 5 |
| 5 | Support | All | 026-41937-000 | 026-45533-000 | 5 |
| 6 | Support, Ring | All | 026-36367-000 | | 5 |
| 7 | Screw, Cap (M8x125) | All | 021-18494-000 | | 5 |
| 8 | Spacer | All | 075-40484-000 | | 5 |
| 9 | Hub, Square | All | 026-41939-002 | 026-41939-005 | 5 |

^S = Recommended Spare Parts

Service Note: Fan Hub to Shaft Joint should be sealed with protective coating - use RUST VETO 344 - a solvent type, rust preventative coating.

71386-000

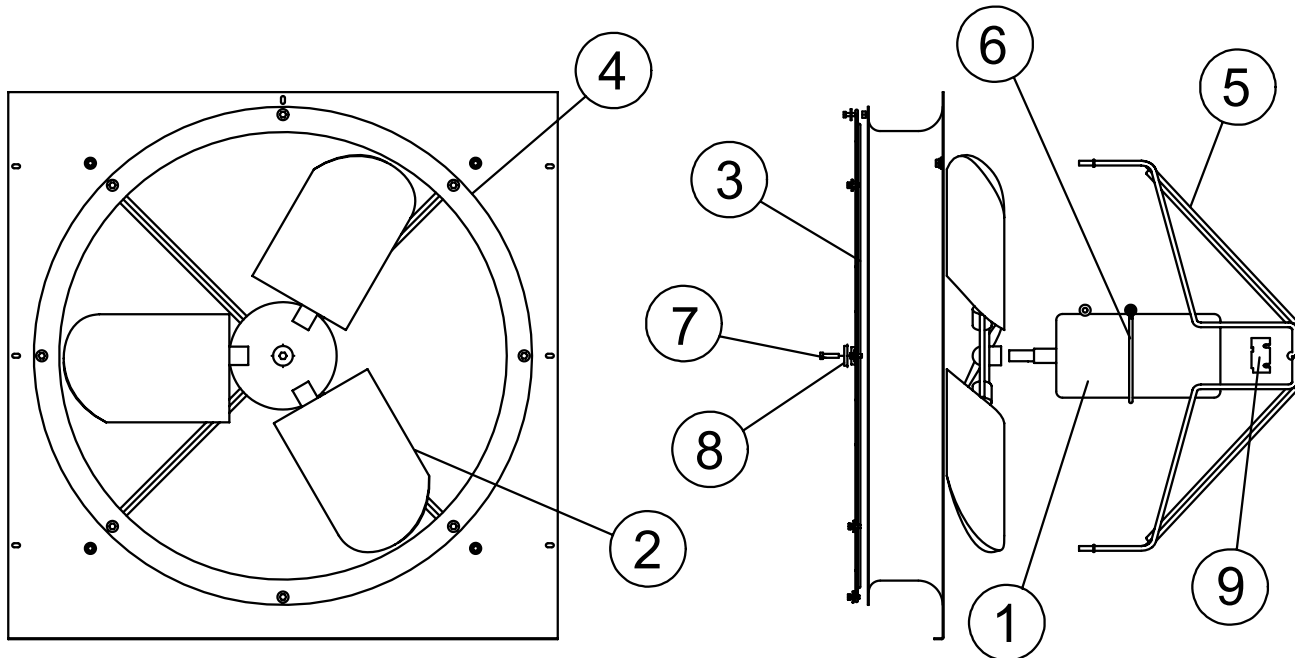

Service Note: Pin Location 52 in Model Number will be "X" for Standard Fan, or "L" for Low Noise Fan. See page 4.

FIGURE 5 - FAN COMPONENTS

REFRIGERANT PIPING COMPONENTS CHILLER MODEL YLAA – DESIGN SERIES "A", "B" & "C"

TABLE 5 - REFRIGERANT PIPING COMPONENTS

| ITEM | SYS. | DESCRIPTION | YLAA0070 | YLAA0080 | YLAA00090 | FIGURE |
|------------------|------|--------------------------|---------------|---------------|---------------|--------|
| 105 | Both | Valve, Ball (Discharge) | 022-08883-000 | 022-08883-000 | 022-08883-000 | 6 |
| 112 ^s | 1 | Valve, Thermal Expansion | 025-40666-000 | 025-40666-000 | 025-40681-000 | 6 |
| 113 ^s | 2 | Valve, Thermal Expansion | 025-40666-000 | 025-40681-000 | 025-40681-000 | 6 |
| 114 | Both | Moisture Indicator | 026-14125-000 | 026-14125-000 | 026-14125-000 | 6 |
| 115 | Both | Valve, Liquid Stop | 022-10022-000 | 022-10022-000 | 022-10022-000 | 6 |
| 116 | Both | Valve, Solenoid | 025-41743-000 | 025-41743-000 | 025-41743-000 | 6 |
| 118 | Both | Dehydrator, Body | 026-43984-002 | 026-43984-002 | 026-43984-002 | 6 |
| 119 ^s | Both | Core, Dehydrator | 026-37540-000 | 026-37540-000 | 026-37540-000 | 6 |
| 122 | Both | Valve, Angle Stop | 022-03836-000 | 022-03836-000 | 022-03836-000 | 6 |
| 123 | Both | Valve, Charging | 022-09754-000 | 022-09754-000 | 022-09754-000 | 6 |
| 141 | Both | Valve, Ball (Suction) | 022-09753-000 | 022-09753-000 | 022-09753-000 | 6 |
| 148 | Both | Valve, Transducer | 022-11735-000 | 022-11735-000 | 022-11735-000 | 6 |
| 200 | Both | Valve, Relief (400 psi) | 022-11704-000 | 022-11704-000 | 022-11704-000 | 6 |
| 201 | Both | Tube, Relief | 375-37978-000 | 375-37978-000 | 375-37978-000 | 6 |
| 202 | All | Valve, Relief (650 psi) | 022-10682-001 | 022-10682-001 | 022-10682-001 | 6 |
| 203 | All | Tube, Relief | 375-37975-000 | 375-37975-000 | 375-37975-000 | 6 |

| ITEM | SYS. | DESCRIPTION | YLAA0091 | YLAA0100 AND YLAA0101 | YLAA0115, 0120 AND YLAA0125 | FIGURE |
|------------------|------|--------------------------|---------------|--------------------------|--------------------------------|--------|
| 105 | Both | Valve, Ball (Discharge) | 022-08883-000 | 022-08883-000 | 022-08883-000 | 6 |
| 112 ^s | 1 | Valve, Thermal Expansion | 025-40681-000 | 025-40681-000 | 025-40900-008 | 6 |
| 113 ^s | 2 | Valve, Thermal Expansion | 025-40681-000 | 025-40900-008 | 025-40900-008 | 6 |
| 114 | Both | Moisture Indicator | 026-14125-000 | 026-14125-000 | 026-14125-000 | 6 |
| 115 | Both | Valve, Liquid Stop | 022-10022-000 | 022-10022-000 | 022-10022-000 | 6 |
| 116 | Both | Valve, Solenoid | 025-41743-000 | 025-41743-000 | 025-41743-000 | 6 |
| 118 | Both | Dehydrator, Body | 026-43984-002 | 026-43984-002 | 026-43984-002 | 6 |
| 119 ^s | Both | Core, Dehydrator | 026-37540-000 | 026-37540-000 | 026-37540-000 | 6 |
| 122 | Both | Valve, Angle Stop | 022-03836-000 | 022-03836-000 | 022-03836-000 | 6 |
| 123 | Both | Valve, Charging | 022-09754-000 | 022-09754-000 | 022-09754-000 | 6 |
| 141 | Both | Valve, Ball (Suction) | 022-09753-000 | 022-09753-000 | 022-09753-000 | 6 |
| 148 | Both | Valve, Transducer | 022-11735-000 | 022-11735-000 | 022-11735-000 | 6 |
| 200 | Both | Valve, Relief (400 psi) | 022-11704-000 | 022-11704-000 | 022-11704-000 | 6 |
| 201 | Both | Tube, Relief | 375-37978-000 | 375-37978-000 | 375-37978-000 | 6 |
| 202 | All | Valve, Relief (650 psi) | 022-10682-001 | 022-10682-001 | 022-10682-001 | 6 |
| 203 | All | Tube, Relief | 375-37975-000 | 375-37975-000 | 375-37975-000 | 6 |

REFRIGERANT PIPING COMPONENTS (CONT'D) CHILLER MODEL YLAA – DESIGN SERIES "A", "B" & "C"

TABLE 5 - REFRIGERANT PIPING COMPONENTS (CONT'D)

| ITEM | SYS. | DESCRIPTION | YLAA0135 | YLAA0141, 0150, 0155 AND YLAA0156 | YLAA0170 AND YLAA0175 | FIGURE |
|------------------|------|--------------------------|---------------|---|--------------------------|--------|
| 105 | 1 | Valve, Ball (Discharge) | 022-08883-000 | 022-08883-000 | 022-09752-000 | 6 |
| | 2 | | 022-09752-000 | 022-09752-000 | | |
| 112 ^s | 1 | Valve, Thermal Expansion | 025-40900-004 | 025-40900-004 | 025-40900-004 | 6 |
| 113 ^s | 2 | | 025-40681-000 | 025-40900-008 | | |
| 114 | 1 | Moisture Indicator | 026-14125-000 | 026-14125-000 | 026-20574-000 | 6 |
| | 2 | | 026-20574-000 | 026-20574-000 | | |
| 115 | 1 | Valve, Liquid Stop | 022-10022-000 | 022-10022-000 | 022-09778-000 | 6 |
| | 2 | | 022-09778-000 | 022-09778-000 | | |
| 116 | 1 | Valve, Solenoid | 025-41743-000 | 025-41743-000 | 025-42090-000 | 6 |
| | 2 | | 025-42090-000 | 025-42090-000 | | |
| 118 | 1 | Dehydrator, Body | 026-43984-002 | 026-43984-002 | 026-43984-003 | 6 |
| | 2 | | 026-43984-003 | 026-43984-003 | | |
| 119 ^s | Both | Core, Dehydrator | 026-37540-000 | 026-37540-000 | 026-37540-000 | 6 |
| 122 | Both | Valve, Angle Stop | 022-03836-000 | 022-03836-000 | 022-03836-000 | 6 |
| 123 | Both | Valve, Charging | 022-09754-000 | 022-09754-000 | 022-09754-000 | 6 |
| 141 | 1 | Valve, Ball (Suction) | 022-09753-000 | 022-09753-000 | 022-11325-000 | 6 |
| | 2 | | 022-11325-000 | 022-11325-000 | | |
| 148 | Both | Valve, Transducer | 022-11735-000 | 022-11735-000 | 022-11735-000 | 6 |
| 200 | Both | Valve, Relief (400 psi) | 022-11704-000 | 022-11704-000 | 022-11704-000 | 6 |
| 201 | Both | Tube, Relief | 375-37978-000 | 375-37978-000 | 375-37978-000 | 6 |
| 202 | All | Valve, Relief (650 psi) | 022-10682-001 | 022-10682-001 | 022-10682-001 | 6 |
| 203 | All | Tube, Relief | 375-37975-000 | 375-37975-000 | 375-37975-000 | 6 |

^s = Recommended Spare Parts

REFRIGERANT PIPING COMPONENTS (CONT'D) CHILLER MODEL YLAA – DESIGN SERIES "A", "B" & "C"

TABLE 6 - HOT GAS BY-PASS COMPONENTS

| ITEM | MODEL | DESCRIPTION | PART NUMBER | QUANTITY | FIGURE |
|------|-------|-----------------|---------------|----------|--------|
| 7 | All | Valve, Stop | 022-03836-000 | 1 | 7 |
| 9 | | Valve, Hot Gas | 025-40962-000 | 1 | 7 |
| 11 | | Valve, Solenoid | 025-41558-000 | 1 | 7 |
| 18 | | Valve, Ball | 022-11742-000 | 1 | 7 |

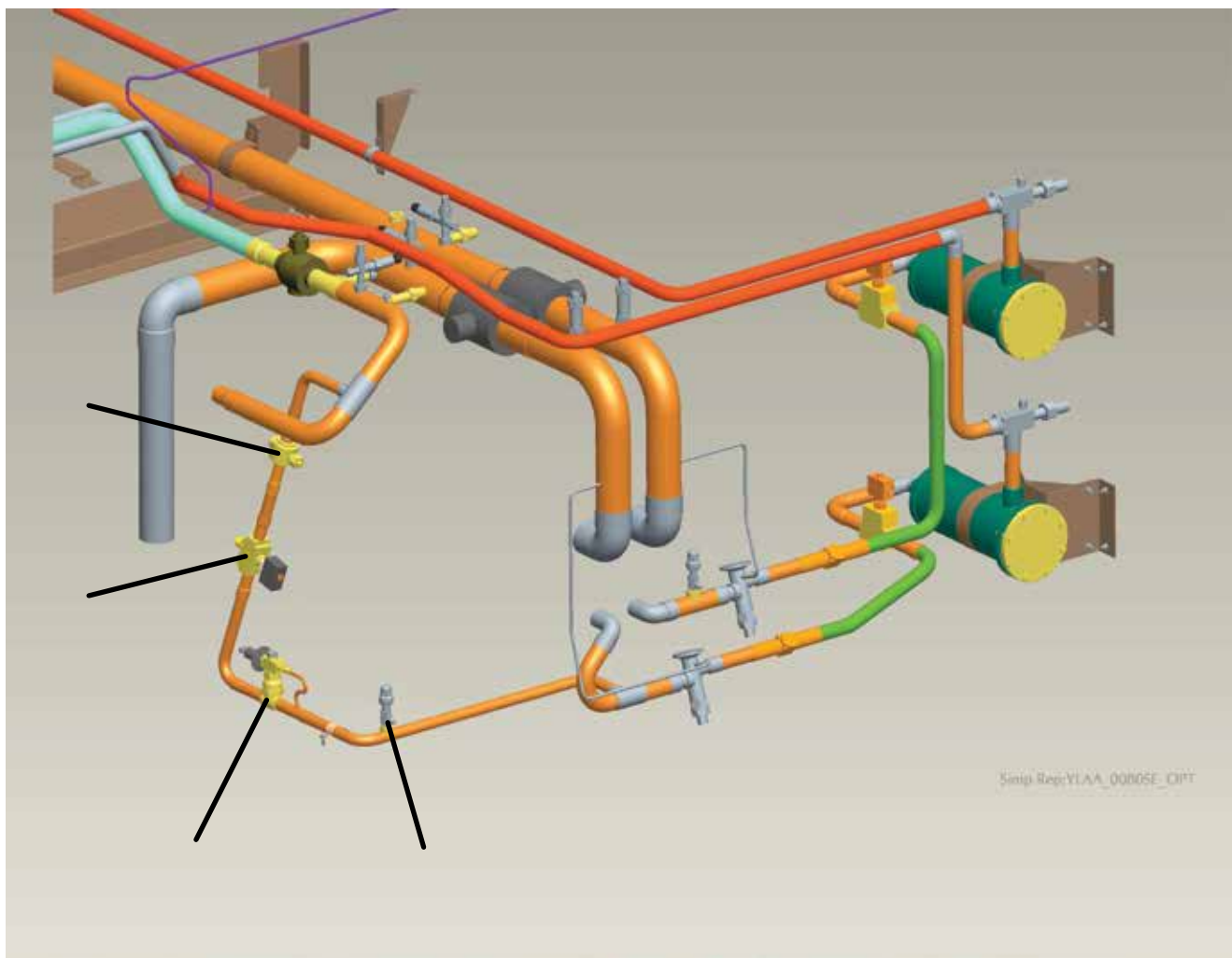

76061-000-2

FIGURE 7 - HOT GAS BY-PASS COMPONENTS

COMPRESSOR

TABLE 7 - COMPRESSOR PART NUMBERS - R-410A

| MODEL | SYSTEM #1 COMPRESSOR | | | SYSTEM #2 COMPRESSOR | | | | | | |
|-----------------------------|----------------------|---------------|----------|----------------------|---------------|----------|-----|---------------|----------|-----|
| | VOLTAGE CODE | PART # | MODEL # | QTY | PART # | MODEL # | QTY | PART # | MODEL # | QTY |
| YLAA0070 | -17 | 015-04055-101 | ZP154KCE | 3 | 015-04055-101 | ZP154KCE | 3 | N/A | N/A | N/A |
| | -28 | 015-04055-101 | | 3 | 015-04055-101 | | | | | |
| | -40 | 015-04055-102 | | 3 | 015-04055-102 | | | | | |
| | -46 | 015-04055-104 | | 3 | 015-04055-104 | | | | | |
| | -58 | 015-04055-105 | | 3 | 015-04055-105 | | | | | |
| YLAA0080 | -17 | 015-04045-101 | ZP180KCE | 3 | 015-04055-101 | ZP154KCE | 3 | N/A | N/A | N/A |
| | -28 | 015-04045-101 | | 3 | 015-04055-101 | | | | | |
| | -40 | 015-04045-102 | | 3 | 015-04055-102 | | | | | |
| | -46 | 015-04045-104 | | 3 | 015-04055-104 | | | | | |
| | -58 | 015-04045-105 | | 3 | 015-04055-105 | | | | | |
| YLAA0090 | -17 | 015-04045-101 | ZP180KCE | 3 | 015-04052-101 | ZP385KCE | 1 | 015-04045-101 | ZP180KCE | 1 |
| | -28 | 015-04045-101 | | 3 | 015-04052-101 | | 1 | 015-04045-101 | | |
| | -40 | 015-04045-102 | | 3 | 015-04052-102 | | 1 | 015-04045-102 | | |
| | -46 | 015-04045-104 | | 3 | 015-04052-104 | | 1 | 015-04045-104 | | |
| | -58 | 015-04045-105 | | 3 | 015-04052-105 | | 1 | 015-04045-105 | | |
| YLAA0091 | -17 | 015-04052-101 | ZP385KCE | 2 | 015-04045-101 | ZP180KCE | 2 | N/A | N/A | N/A |
| | -28 | 015-04052-101 | | 2 | 015-04045-101 | | | | | |
| | -40 | 015-04052-102 | | 2 | 015-04045-102 | | | | | |
| | -46 | 015-04052-104 | | 2 | 015-04045-104 | | | | | |
| | -58 | 015-04052-105 | | 2 | 015-04045-105 | | | | | |
| YLAA0100 AND YLAA0101 | -17 | 015-04045-101 | ZP180KCE | 3 | 015-04052-101 | ZP385KCE | 2 | N/A | N/A | N/A |
| | -28 | 015-04045-101 | | 3 | 015-04052-101 | | | | | |
| | -40 | 015-04045-102 | | 3 | 015-04052-102 | | | | | |
| | -46 | 015-04045-104 | | 3 | 015-04052-104 | | | | | |
| | -58 | 015-04045-105 | | 3 | 015-04052-105 | | | | | |

COMPRESSOR (CONT'D)

TABLE 7 - COMPRESSOR PART NUMBERS - R-410A (CONT'D)

| MODEL | VOLTAGE CODE | SYSTEM #1 COMPRESSOR | | | SYSTEM #2 COMPRESSOR | | | | | QTY |
|--|--------------|----------------------|----------|-----|----------------------|----------|-----|--------|----------|---------------|
| | | PART # | MODEL # | QTY | PART # | MODEL # | QTY | PART # | MODEL # | |
| YLAA0115 | -17 | 015-04052-101 | ZP385KCE | 2 | 015-04052-101 | ZP385KCE | 2 | N/A | N/A | N/A |
| | -28 | 015-04052-101 | | 2 | 015-04052-101 | | | | | |
| | -40 | 015-04052-102 | | 2 | 015-04052-102 | | | | | |
| | -46 | 015-04052-104 | | 2 | 015-04052-104 | | | | | |
| | -58 | 015-04052-105 | | 2 | 015-04052-105 | | | | | |
| YLAA0120 AND YLAA0125 | -17 | 015-04052-101 | ZP385KCE | 2 | 015-04052-101 | ZP385KCE | 2 | N/A | N/A | N/A |
| | -28 | 015-04052-101 | | 2 | 015-04052-101 | | | | | |
| | -40 | 015-04052-102 | | 2 | 015-04052-102 | | | | | |
| | -46 | 015-04052-104 | | 2 | 015-04052-104 | | | | | |
| | -58 | 015-04052-105 | | 2 | 015-04052-105 | | | | | |
| YLAA0135 AND YLAA0141 | -17 | 015-04052-101 | ZP385KCE | 3 | 015-04052-101 | ZP385KCE | 1 | N/A | ZP180KCE | 1 |
| | -28 | 015-04052-101 | | 3 | 015-04052-101 | | 1 | | | 015-04045-101 |
| | -40 | 015-04052-102 | | 3 | 015-04052-102 | | 1 | | | 015-04045-102 |
| | -46 | 015-04052-104 | | 3 | 015-04052-104 | | 1 | | | 015-04045-104 |
| | -58 | 015-04052-105 | | 3 | 015-04052-105 | | 1 | | | 015-04045-105 |
| YLAA0150, YLAA0155 AND YLAA0156 | -17 | 015-04052-101 | ZP385KCE | 3 | 015-04052-101 | ZP385KCE | 2 | N/A | N/A | N/A |
| | -28 | 015-04052-101 | | 3 | 015-04052-101 | | 2 | | | |
| | -40 | 015-04052-102 | | 3 | 015-04052-102 | | 2 | | | |
| | -46 | 015-04052-104 | | 3 | 015-04052-104 | | 2 | | | |
| | -58 | 015-04052-105 | | 3 | 015-04052-105 | | 2 | | | |
| YLAA0170 AND YLAA0175 | -17 | 015-04052-101 | ZP385KCE | 3 | 015-04052-101 | ZP385KCE | 3 | N/A | N/A | N/A |
| | -28 | 015-04052-101 | | 3 | 015-04052-101 | | 3 | | | |
| | -40 | 015-04052-102 | | 3 | 015-04052-102 | | 3 | | | |
| | -46 | 015-04052-104 | | 3 | 015-04052-104 | | 3 | | | |
| | -58 | 015-04052-105 | | 3 | 015-04052-105 | | 3 | | | |

COMPRESSOR (CONT'D)

72257-001c

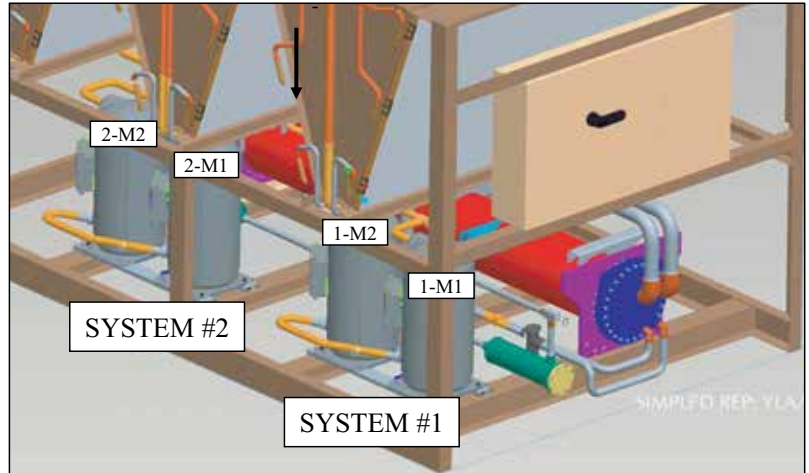

YLAA0091, YLAA0115 and YLAA0120

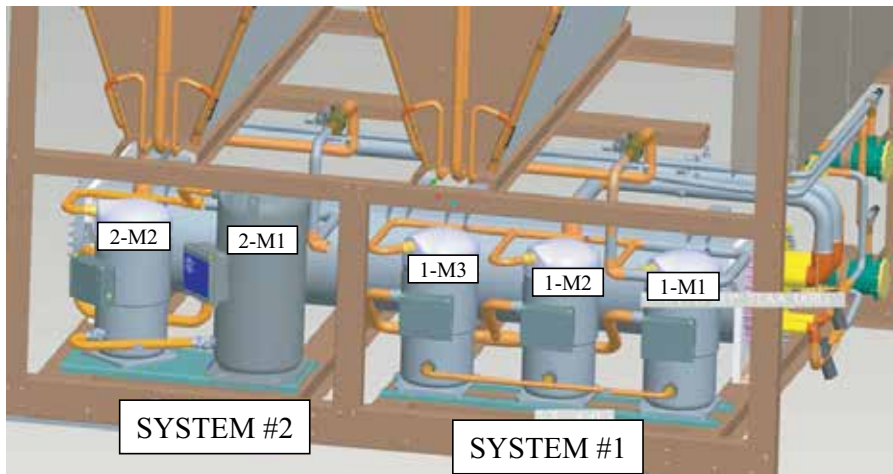

72257-002c

YLAA0090, YLAA0101, YLAA0135, YLAA0150 and YLAA0155

72257-003c

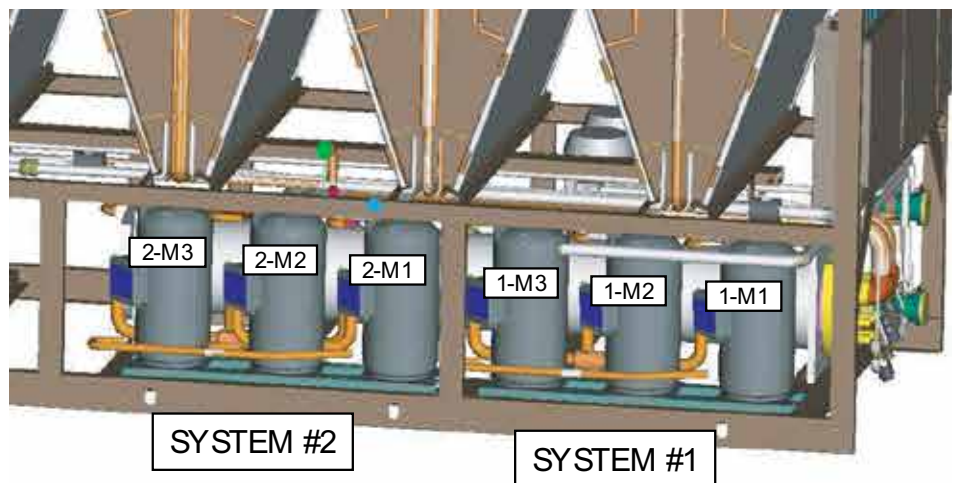

YLAA0070 and YLAA0080

FIGURE 8 - COMPRESSOR LAYOUTS

COMPRESSOR (CONT'D)

TABLE 8 - RECOMMENDED COMPRESSOR OIL TYPE

| ITEM | REF. | DESCRIPTION | (6) 1 GALLON | 5 GALLON |
|------------------|--------|----------------------------|---------------|---------------|
| OIL ^s | R-410A | Oil, Compressor (Type 'V') | 011-00948-000 | 011-00949-000 |

^s = Recommended Spare Parts

TABLE 9 - COMPRESSOR HEATER AND SOUND BLANKET PART NUMBERS

| COMPRESSOR PART NUMBER | HEATER PART NUMBER | QUANTITY PER COMPRESSOR | SOUND BLANKET PART NUMBER | QUANTITY PER COMPRESSOR |
|------------------------|--------------------|-------------------------|---------------------------|-------------------------|
| 015-04045-xxx | 025-37888-000 | 1 | 010-06507-002 | 1 |
| 015-04055-xxx | 025-40351-000 | 1 | 010-06507-007 | 1 |
| 015-04052-xxx | 025-37853-000 | 1 | 010-06507-000 | 1 |

TABLE 10 - COMPRESSOR COMPONENTS

| ITEM | REF. NO. | DESCRIPTION | YORK NO. |
|------|-------------|------------------|---------------|
| A | 071-0520-05 | Module Protector | 025-38995-000 |
| B | 005-0892-00 | Cover, T-Box | 025-38996-000 |

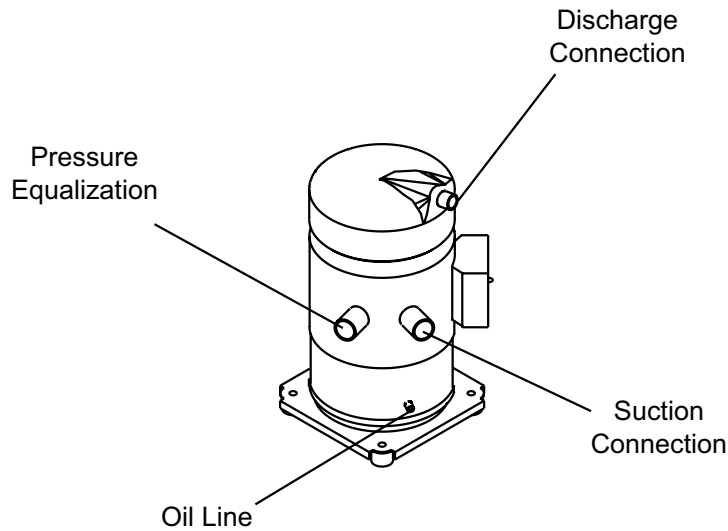

50459-1

FIGURE 9 - COMPRESSOR

CONTROL PANEL AND POWER PANEL CONFIGURATIONS

Power panels and option panels are offered in several different configurations using three (3) major components:

1. TERMINAL BLOCKS
2. CIRCUIT BREAKERS
3. NON-FUSED DISCONNECT SWITCHES

The most basic chiller power wiring configuration uses TERMINAL BLOCKS in the power panels, and an options panel with no power wire termination hardware. The model pin number locations 16 and 17 would be X and X to reflect this basic combination. Identify model pin number locations 16 and 17 to identify the chiller power wiring connections and hardware listed below.

| PIN 16 & 17 LETTER CODE IDENTIFIERS | | OPTION PANEL AND POWER PANEL CONFIGURATIONS |
|---|----------|---|
| S | X | Single Point Supply Terminal Block |
| S | D | Single Point Supply Non-Fused Disconnect Switch |
| B | X | Single Point Supply Circuit Breaker |

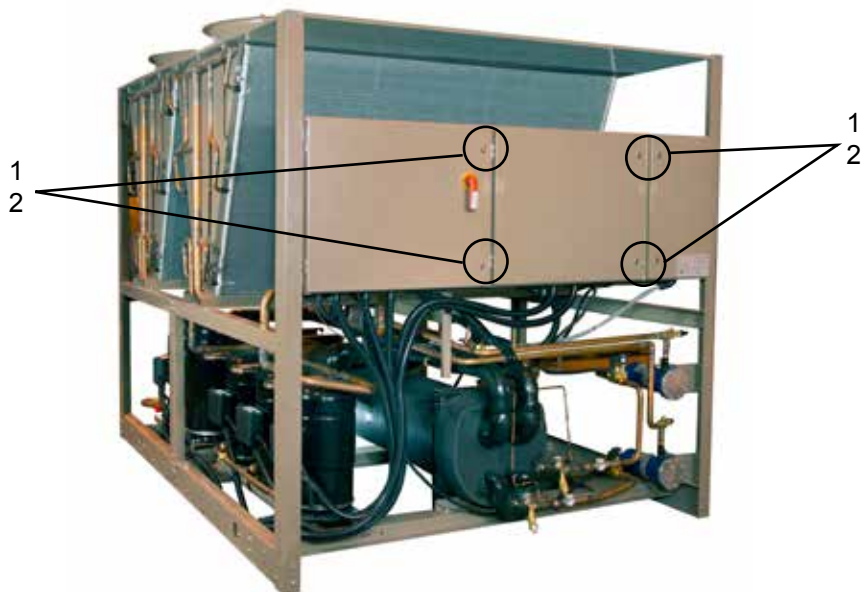

| ITEM # | DESCRIPTION | YORK NO. |
|--------|-------------|---------------|
| 1 | Door Lock | 021-32078-000 |
| 2 | Key | 021-32231-000 |

FIGURE 10 - PANEL DOOR LOCK AND KEY

CONTROL PANEL AND POWER PANEL COMPONENTS

TABLE 11 - CONTROL PANEL AND POWER PANEL IDENTIFIERS

| MODEL | VOLTAGE CODE | SINGLE POINT TERMINAL BLOCK (SX) | SINGLE POINT NON-FUSED DISCONNECT SWITCH (SD) | SINGLE POINT CIRCUIT BREAKER (BX) | SINGLE POINT NON-FUSED DISCONNECT SWITCH W/ IND. SYS. CIRCUIT BREAKERS (DB) |
|-----------------------|--------------|----------------------------------|---|-----------------------------------|---|
| YLAA0070 | 17 | 371-05245-101 | 371-05245-201 | 371-05245-301 | 371-05245-401 |
| | 28 | 371-05245-102 | 371-05245-202 | 371-05245-302 | 371-05245-402 |
| | 40 | 371-05245-103 | 371-05245-203 | 371-05245-303 | 371-05245-403 |
| | 46 | 371-05245-104 | 371-05245-204 | 371-05245-304 | 371-05245-404 |
| | 58 | 371-05245-105 | 371-05245-205 | 371-05245-305 | 371-05245-405 |
| YLAA0080 | 17 | 371-05245-107 | 371-05245-207 | 371-05245-307 | 371-05245-407 |
| | 28 | 371-05245-108 | 371-05245-208 | 371-05245-308 | 371-05245-408 |
| | 40 | 371-05245-109 | 371-05245-209 | 371-05245-309 | 371-05245-409 |
| | 46 | 371-05245-110 | 371-05245-210 | 371-05245-310 | 371-05245-410 |
| | 58 | 371-05245-111 | 371-05245-211 | 371-05245-311 | 371-05245-411 |
| YLAA0090 | 17 | 371-05246-101 | 371-05246-201 | 371-05246-301 | 371-05246-401 |
| | 28 | 371-05246-102 | 371-05246-202 | 371-05246-302 | 371-05246-402 |
| | 40 | 371-05246-103 | 371-05246-203 | 371-05246-303 | 371-05246-403 |
| | 46 | 371-05246-104 | 371-05246-204 | 371-05246-304 | 371-05246-404 |
| | 58 | 371-05246-105 | 371-05246-205 | 371-05246-305 | 371-05246-405 |
| YLAA0091 | 17 | 371-05244-101 | 371-05244-201 | 371-05244-301 | 371-05244-401 |
| | 28 | 371-05244-102 | 371-05244-202 | 371-05244-302 | 371-05244-402 |
| | 40 | 371-05244-103 | 371-05244-203 | 371-05244-303 | 371-05244-403 |
| | 46 | 371-05244-104 | 371-05244-204 | 371-05244-304 | 371-05244-404 |
| | 58 | 371-05244-105 | 371-05244-205 | 371-05244-305 | 371-05244-405 |
| YLAA0100 AND YLAA0101 | 17 | 371-05246-107 | 371-05246-207 | 371-05246-307 | 371-05246-407 |
| | 28 | 371-05246-108 | 371-05246-208 | 371-05246-308 | 371-05246-408 |
| | 40 | 371-05246-109 | 371-05246-209 | 371-05246-309 | 371-05246-409 |
| | 46 | 371-05246-110 | 371-05246-210 | 371-05246-310 | 371-05246-410 |
| | 58 | 371-05246-111 | 371-05246-211 | 371-05246-311 | 371-05246-411 |

To Identify Replacement Part Numbers, Select Panel Identifier Number From The *Table 11 on page 24* Or From The Panel Identifier Label Shown in *Figure 11 on page 26*, Then Refer To The 'Control And Power Panel Components' Tables 12 through 22 starting on page 28.

CONTROL PANEL AND POWER PANEL COMPONENTS (CONT'D)

TABLE 11 – CONTROL PANEL AND POWER PANEL IDENTIFIERS (CONT'D)

| MODEL | VOLTAGE CODE | SINGLE POINT TERMINAL BLOCK (SX) | SINGLE POINT NON-FUSED DISCONNECT SWITCH (SD) | SINGLE POINT CIRCUIT BREAKER (BX) | SINGLE POINT NON-FUSED DISCONNECT SWITCH W/ IND. SYS. CIRCUIT BREAKERS (DB) |
|-----------------------|--------------|----------------------------------|---|-----------------------------------|---|
| YLAA0115 | 17 | 371-05244-107 | 371-05244-207 | 371-05244-307 | 371-05244-407 |
| | 28 | 371-05244-108 | 371-05244-208 | 371-05244-308 | 371-05244-408 |
| | 40 | 371-05244-109 | 371-05244-209 | 371-05244-309 | 371-05244-409 |
| | 46 | 371-05244-110 | 371-05244-210 | 371-05244-310 | 371-05244-410 |
| | 58 | 371-05244-111 | 371-05244-211 | 371-05244-311 | 371-05244-411 |
| YLAA0120 AND YLAA0125 | 17 | 371-05244-107 | 371-05244-207 | 371-05244-307 | 371-05244-407 |
| | 28 | 371-05244-108 | 371-05244-208 | 371-05244-308 | 371-05244-408 |
| | 40 | 371-05244-109 | 371-05244-209 | 371-05244-309 | 371-05244-409 |
| | 46 | 371-05244-110 | 371-05244-210 | 371-05244-310 | 371-05244-410 |
| | 58 | 371-05244-111 | 371-05244-211 | 371-05244-311 | 371-05244-411 |
| YLAA0135 AND YLAA0141 | 17 | 371-05246-113 | 371-05246-213 | 371-05246-313 | 371-05246-413 |
| | 28 | 371-05246-114 | 371-05246-214 | 371-05246-314 | 371-05246-414 |
| | 40 | 371-05246-115 | 371-05246-215 | 371-05246-315 | 371-05246-415 |
| | 46 | 371-05246-116 | 371-05246-216 | 371-05246-316 | 371-05246-416 |
| | 58 | 371-05246-117 | 371-05246-217 | 371-05246-317 | 371-05246-417 |
| YLAA0150 | 17 | 371-05246-119 | 371-05246-219 | 371-05246-319 | 371-05246-419 |
| | 28 | 371-05246-120 | 371-05246-220 | 371-05246-320 | 371-05246-420 |
| | 40 | 371-05246-121 | 371-05246-221 | 371-05246-321 | 371-05246-421 |
| | 46 | 371-05246-122 | 371-05246-222 | 371-05246-322 | 371-05246-422 |
| | 58 | 371-05246-123 | 371-05246-223 | 371-05246-323 | 371-05246-423 |
| YLAA0155 AND YLAA0156 | 17 | 371-05246-119 | 371-05246-219 | 371-05246-319 | 371-05246-419 |
| | 28 | 371-05246-120 | 371-05246-220 | 371-05246-320 | 371-05246-420 |
| | 40 | 371-05246-121 | 371-05246-221 | 371-05246-321 | 371-05246-421 |
| | 46 | 371-05246-122 | 371-05246-222 | 371-05246-322 | 371-05246-422 |
| | 58 | 371-05246-123 | 371-05246-223 | 371-05246-323 | 371-05246-423 |
| YLAA0170 AND YLAA0175 | 17 | 371-05247-101 | 371-05247-201 | 371-05247-301 | 371-05247-401 |
| | 28 | 371-05247-102 | 371-05247-202 | 371-05247-302 | 371-05247-402 |
| | 40 | 371-05247-103 | 371-05247-203 | 371-05247-303 | 371-05247-403 |
| | 46 | 371-05247-104 | 371-05247-204 | 371-05247-304 | 371-05247-404 |
| | 58 | 371-05247-105 | 371-05247-205 | 371-05247-305 | 371-05247-405 |

To Identify Replacement Part Numbers, Select Panel Identifier Number From The *Table 11 on page 24* Or From The Panel Identifier Label Shown in *Figure 11 on page 26*, Then Refer To The 'Control And Power Panel Components' Tables 12 through 22 starting on page 28.

POWER PANEL COMPONENTS



***Service Note:** Locate the PANEL NUMBER sticker on the upper right hand corner of the power panel, see Figure 11, then refer to the appropriate parts list for that number.

DSCN0003

FIGURE 11 - PANEL PART NUMBER STICKER

POWER PANEL COMPONENTS (CONT'D)

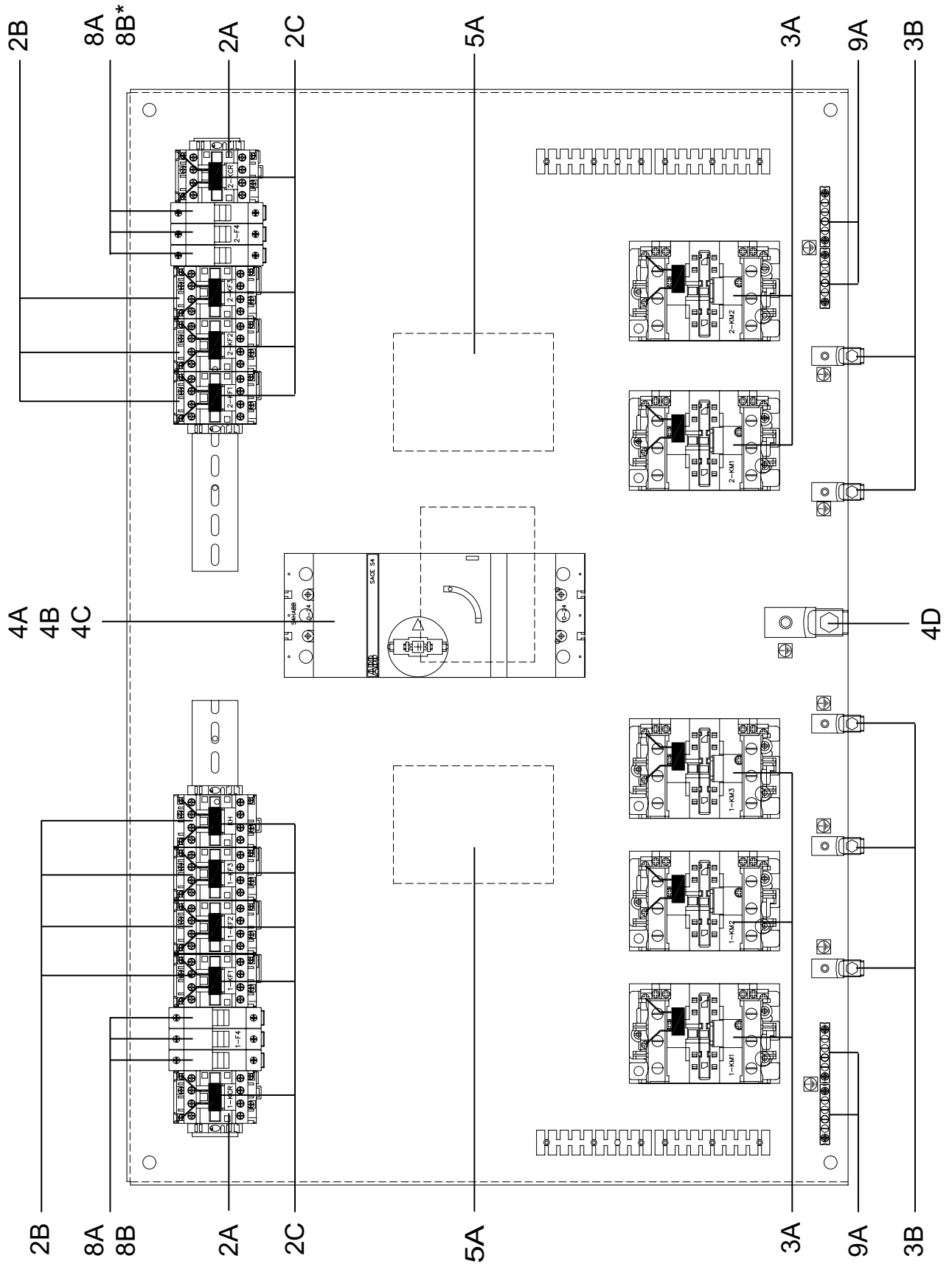

211028-3

FIGURE 12 - POWER PANEL COMPONENTS

POWER PANEL COMPONENTS (CONT'D)

TABLE 12 - POWER PANEL COMPONENTS - YLAA0070

| ITEM | QTY. | DESCRIPTION | SINGLE POINT TERMINAL BLOCK (SX) | SINGLE POINT NON-FUSED DISCONNECT SWITCH (SD) | SINGLE POINT CIRCUIT BREAKER (BX) | SINGLE POINT NON-FUSED DISCONNECT SWITCH W/ IND. SYSTEM CIRCUIT BREAKERS (DB) |
|-----------------------|------|---------------------------------------|----------------------------------|---|-----------------------------------|---|
| 2A^S | 3 | Fan Control Relay | 371-05245-10x | 371-05245-20x | 371-05245-30x | 371-05245-40x |
| 2B^S | 4 | Fan Contactor (-17, -28 & -40) | 024-35526-000 | 024-35526-000 | 024-35526-000 | 024-35526-000 |
| | | Fan Contactor (-17, -28 & -40) | 024-35444-000 (12A)** | 024-35444-000 (12A)** | 024-35444-000 (12A)** | 024-35444-000 (12A)** |
| | | Fan Contactor (-46 & -58) | 024-35441-000 (9A)** | 024-35441-000 (9A)** | 024-35441-000 (9A)** | 024-35441-000 (9A)** |
| 2C | 13 | Surge Suppressor | 031-00808-000 | 031-00808-000 | 031-00808-000 | 031-00808-000 |
| 3A | 6 | Compressor Contactor (-17) | 024-35470-000 (80A)** | 024-35470-000 (80A)** | 024-35470-000 (80A)** | 024-35470-000 (80A)** |
| | | Compressor Contactor (-28) | 024-35470-000 (80A)** | 024-35470-000 (80A)** | 024-35470-000 (80A)** | 024-35470-000 (80A)** |
| | | Compressor Contactor (-40, -46 & -58) | 024-35467-000 (65A)** | 024-35467-000 (65A)** | 024-35467-000 (65A)** | 024-35467-000 (65A)** |
| 3B | 6 | Ground Lug | 025-34088-000 | 025-34088-000 | 025-34088-000 | 025-34088-000 |
| 4A | 1 | Terminal Block | 025-39410-000 | N/A | N/A | N/A |
| | | Circuit Breaker (-17 & -28) | N/A | N/A | 025-34424-000 | N/A |
| | | Circuit Breaker (-40, -46 & -58) | N/A | N/A | 025-34419-000 | N/A |
| 4B | 1 | Non-Fused Disc. Sw. (-17 & -28) | N/A | 024-30965-000 | N/A | 024-30965-000 |
| | | Non-Fused Disc. Sw. (-40, -46 & -58) | N/A | 024-30963-000 | N/A | 024-30963-000 |
| 4C | 3 | Safety Cover (use w/ TB) | 025-39393-000 | N/A | N/A | N/A |
| 4D | 1 | Oper. Mech. (use w/ CB or NFDS) | N/A | 024-31878-000 | 024-31878-000 | 024-31878-000 |
| 5A | 1 | Ground Lug | 025-34089-000 | 025-34089-000 | 025-34089-000 | 025-34089-000 |
| | | Ind. Sys. Circuit Breaker (Sys. 1) | N/A | N/A | N/A | 025-34419-000 |
| 8A | 2 | Fuse Holder | 025-37863-000 | 025-37863-000 | 025-37863-000 | 025-37863-000 |
| 8B | 6 | Fuse | See Fuse Table on Page 36 | | | |
| 9A | 4 | Ground Bar | 025-35685-000 | 025-35685-000 | 025-35685-000 | 025-35685-000 |

*Recommended Spare Part
See Figure 12 on page 27.

Note: Lug Kits for Circuit Breakers or Non-Fused Disconnect Switches - See LUG KIT TABLE on Page 38.

*Service Note: Locate the PANEL PART NUMBER sticker on the upper right hand corner of the power panel, see Figure 11 on page 26, then refer to the appropriate parts list for that number.

**Service Note: Make a visual inspection of the contactors in order to select the correct replacement part.

- 024-35441-000 (9A) R11-D0910-G7
- 024-35444-000 (12A) R11-D1210-G7
- 024-35447-000 (18A) R11-D1810-G7
- 024-35451-000 (25A) R11-D2510-G7
- 024-35462-000 (50A) R11-D5011-G7
- 024-35467-000 (65A) R11-D6511-G7
- 024-35470-000 (80A) R11-D8011-G7
- 024-35473-000 (95A) R11-D9511-G7
- 024-34294-000 (150A) TE-LC1D150-F7

POWER PANEL COMPONENTS (CONT'D)

TABLE 13 - POWER PANEL COMPONENTS - YLAA0080

| ITEM | QTY. | DESCRIPTION | SINGLE POINT TERMINAL BLOCK (SX) | SINGLE POINT NON-FUSED DISCONNECT SWITCH (SD) | SINGLE POINT CIRCUIT BREAKER (BX) | SINGLE POINT NON-FUSED DISCONNECT SWITCH W/ IND. SYSTEM CIRCUIT BREAKERS (DB) |
|-----------------------|------|------------------------------------|----------------------------------|---|-----------------------------------|---|
| 2A^S | 3 | Fan Control Relay | 371-05245-10x 024-35526-000 | 371-05245-20x 024-35526-000 | 371-05245-30x 024-35526-000 | 371-05245-40x 024-35526-000 |
| 2B^S | 4 | Fan Contactor (-17, -28 & -40) | 024-35444-000 (12A)** | 024-35444-000 (12A)** | 024-35444-000 (12A)** | 024-35444-000 (12A)** |
| 2C | 13 | Fan Contactor (-46 & -58) | 024-35441-000 (9A)** | 024-35441-000 (9A)** | 024-35441-000 (9A)** | 024-35441-000 (9A)** |
| 3A | 6 | Surge Suppressor | 031-00808-000 | 031-00808-000 | 031-00808-000 | 031-00808-000 |
| | 6 | Compressor Contactor (-17) | 024-35470-000 (80A)** | 024-35470-000 (80A)** | 024-35470-000 (80A)** | 024-35470-000 (80A)** |
| | 4 | Compressor Contactor (-28) | 024-35470-000 (80A)** | 024-35470-000 (80A)** | 024-35470-000 (80A)** | 024-35470-000 (80A)** |
| | 2 | Compressor Contactor (-40) | 024-35467-000 (65A)** | 024-35467-000 (65A)** | 024-35467-000 (65A)** | 024-35467-000 (65A)** |
| | 3 | Compressor Contactor (-46) | 024-35467-000 (65A)** | 024-35467-000 (65A)** | 024-35467-000 (65A)** | 024-35467-000 (65A)** |
| | 3 | Compressor Contactor (-58) | 024-35462-000 (50A)** | 024-35462-000 (50A)** | 024-35462-000 (50A)** | 024-35462-000 (50A)** |
| 3B | 6 | Compressor Contactor (-46 & -58) | 024-35462-000 (50A)** | 024-35462-000 (50A)** | 024-35462-000 (50A)** | 024-35462-000 (50A)** |
| 4A | 6 | Ground Lug | 025-34088-000 | 025-34088-000 | 025-34088-000 | 025-34088-000 |
| | 1 | Terminal Block | 025-39410-000 | N/A | N/A | N/A |
| 4B | 1 | Circuit Breaker (-17 & -28) | N/A | N/A | 025-34424-000 | N/A |
| | 1 | Circuit Breaker (-40, -46 & -58) | N/A | N/A | 025-34419-000 | N/A |
| | 1 | Non-Fused Disc. Sw. (-17 & -28) | N/A | 024-30965-000 | N/A | 024-30965-000 |
| | | Non-Fused Disc. Sw. (-40) | N/A | 024-30964-000 | N/A | 024-30964-000 |
| 4C | 1 | Non-Fused Disc. Sw. (-46 & -58) | N/A | 024-30963-000 | N/A | 024-30963-000 |
| | 3 | Safety Cover (use w/ TB) | 025-39393-000 | N/A | N/A | N/A |
| 4D | 1 | Oper. Mech. (use w/ CB or NFDS) | N/A | 024-31878-000 | 024-31878-000 | 024-31878-000 |
| 5A | 1 | Ground Lug | 025-34089-000 | 025-34089-000 | 025-34089-000 | 025-34089-000 |
| | 1 | Ind. Sys. Circuit Breaker (Sys. 1) | N/A | N/A | N/A | 025-34419-000 |
| 8A | 1 | Ind. Sys. Circuit Breaker (Sys. 2) | N/A | N/A | N/A | 024-31842-000 |
| 8B | 2 | Fuse Holder | 025-37863-000 | 025-37863-000 | 025-37863-000 | 025-37863-000 |
| 9A | 6 | Fuse | See Fuse Table on Page 36 | | | |
| | 4 | Ground Bar | 025-35685-000 | 025-35685-000 | 025-35685-000 | 025-35685-000 |

^SRecommended Spare Part
See Figure 12 on page 27.

**Service Note: Make a visual inspection of the contactors in order to select the correct replacement part.

- 024-35441-000 (9A) R11-D0910-G7
- 024-35444-000 (12A) R11-D1210-G7
- 024-35447-000 (18A) R11-D1810-G7
- 024-35451-000 (25A) R11-D2510-G7
- 024-35462-000 (50A) R11-D5011-G7
- 024-35467-000 (65A) R11-D6511-G7
- 024-35470-000 (80A) R11-D8011-G7
- 024-35473-000 (95A) R11-D9511-G7
- 024-34294-000 (150A) TE-LC1D150-F7

Note: Lug Kits for Circuit Breakers or Non-Fused Disconnect Switches - See LUG KIT TABLE on Page 38.

*Service Note: Locate the PANEL PART NUMBER sticker on the upper right hand corner of the power panel, see Figure 11 on page 26, then refer to the appropriate parts list for that number.

POWER PANEL COMPONENTS (CONT'D)

TABLE 14 - POWER PANEL COMPONENTS - YLAA0090

| ITEM | QTY. | DESCRIPTION | SINGLE POINT TERMINAL BLOCK (SX) | SINGLE POINT NON-FUSED DISCONNECT SWITCH (SD) | SINGLE POINT CIRCUIT BREAKER (BX) | SINGLE POINT NON-FUSED DISCONNECT SWITCH W/ IND. SYSTEM CIRCUIT BREAKERS (DB) |
|-----------------------|------|---|----------------------------------|---|-----------------------------------|---|
| 2A^S | 3 | Fan Control Relay | 371-05246-10x | 371-05246-20x | 371-05246-30x | 371-05246-40x |
| | | | 024-35526-000 | 024-35526-000 | 024-35526-000 | 024-35526-000 |
| 2B^S | 4 | Fan Contactor (-17, -28 & -40) | 024-35444-000 (12A)** | 024-35444-000 (12A)** | 024-35444-000 (12A)** | 024-35444-000 (12A)** |
| | | | 024-35441-000 (9A)** | 024-35441-000 (9A)** | 024-35441-000 (9A)** | 024-35441-000 (9A)** |
| 2C | 14 | Surge Suppressor | 031-00808-000 | 031-00808-000 | 031-00808-000 | 031-00808-000 |
| | 4 | | 024-35470-000 (80A)** | 024-35470-000 (80A)** | 024-35470-000 (80A)** | 024-35470-000 (80A)** |
| | 1 | Compressor Contactor (-17) | 024-34294-000 (150A)** | 024-34294-000 (150A)** | 024-34294-000 (150A)** | 024-34294-000 (150A)** |
| | 4 | Compressor Contactor (-28) | 024-35470-000 (80A)** | 024-35470-000 (80A)** | 024-35470-000 (80A)** | 024-35470-000 (80A)** |
| 3A | 1 | | 024-35473-000 (95A)** | 024-35473-000 (95A)** | 024-35467-000 (65A)** | 024-35467-000 (65A)** |
| | 4 | Compressor Contactor (-40) | 024-35467-000 (65A)** | 024-35467-000 (65A)** | 024-35467-000 (65A)** | 024-35467-000 (65A)** |
| | 1 | | 024-35473-000 (95A)** | 024-35462-000 (50A)** | 024-35462-000 (50A)** | 024-35462-000 (50A)** |
| | 4 | Compressor Contactor (-46 & -58) | 024-35462-000 (50A)** | 024-35462-000 (50A)** | 024-35462-000 (50A)** | 024-35462-000 (50A)** |
| | 1 | | 024-35470-000 (80A)** | 024-35470-000 (80A)** | 024-35470-000 (80A)** | 024-35470-000 (80A)** |
| 3B | 5 | Ground Lug | 025-34088-000 | 025-34088-000 | 025-34088-000 | 025-34088-000 |
| | 1 | Terminal Block (-17 & -28) | 025-32536-000 | N/A | N/A | N/A |
| | | Terminal Block (-40, -46 & -58) | 025-34910-000 | N/A | N/A | N/A |
| | 1 | Circuit Breaker (-17 & -28) | N/A | N/A | 025-34424-000 | N/A |
| 4A | 1 | Circuit Breaker (-40, -46 & -58) | N/A | N/A | 025-34419-000 | N/A |
| | 1 | Non-Fused Disc. Sw. (-17 & -28) | N/A | 024-30965-000 | N/A | 024-30965-000 |
| | 1 | Non-Fused Disc. Sw. (-40) | N/A | 024-30964-000 | N/A | 024-30964-000 |
| | | Non-Fused Disc. Sw. (-46 & -58) | N/A | 024-30963-000 | N/A | 024-30963-000 |
| 4B | 3 | Safety Cover (use w/ TB -17 & -28) | 025-39397-000 | N/A | N/A | N/A |
| | | Safety Cover (use w/ TB -40, -46 & -58) | 025-39393-000 | N/A | N/A | N/A |
| 4C | 1 | Oper. Mech. (use w/ CB or NFDS) | N/A | 024-31878-000 | 024-31878-000 | 024-31878-000 |
| 4D | 1 | Ground Lug | 025-34089-000 | 025-34089-000 | 025-34089-000 | 025-34089-000 |
| 5A | 1 | Ind. Sys. Circuit Breaker (Sys. 1) | N/A | N/A | N/A | 025-34419-000 |
| | 1 | Ind. Sys. Circuit Breaker (Sys. 2) | N/A | N/A | N/A | 024-31842-000 |
| 8A | 2 | Fuse Holder | 025-37863-000 | 025-37863-000 | 025-37863-000 | 025-37863-000 |
| 8B | 6 | Fuse | | See Fuse Table on Page 36 | | |
| 9A | 4 | Ground Bar | 025-35685-000 | 025-35685-000 | 025-35685-000 | 025-35685-000 |

*Recommended Spare Part. See Figure 12 on page 27.

Note: Lug Kits for Circuit Breakers or Non-Fused Disconnect Switches - See LUG KIT TABLE on Page 38.

**Service Note:
Make a visual inspection of the contactors in order to select the correct replacement part.

024-35441-000 (9A) R11-D0910-G7 | 024-35444-000 (12A) R11-D1210-G7
 024-35447-000 (18A) R11-D1810-G7 | 024-35451-000 (25A) R11-D2510-G7
 024-35462-000 (50A) R11-D5011-G7 | 024-35467-000 (65A) R11-D6511-G7
 024-35470-000 (80A) R11-D8011-G7 | 024-35473-000 (95A) R11-D9511-G7
 024-34294-000 (150A) TE-LC1D150-F7

*Service Note: Locate the PANEL PART NUMBER sticker on the upper right hand corner of the power panel, see Figure 11 on page 26, then refer to the appropriate parts list for that number.

POWER PANEL COMPONENTS (CONT'D)

TABLE 15 - POWER PANEL COMPONENTS - YLAA0091

| ITEM | QTY. | DESCRIPTION | SINGLE POINT TERMINAL BLOCK (SX) | SINGLE POINT NON-FUSED DISCONNECT SWITCH (SD) | SINGLE POINT CIRCUIT BREAKER (BX) | SINGLE POINT NON-FUSED DISCONNECT SWITCH W/ IND. SYSTEM CIRCUIT BREAKERS (DB) |
|-----------------------|------|---|----------------------------------|---|-----------------------------------|---|
| 2A^S | 3 | Fan Control Relay | 371-05244-10x | 371-05244-20x | 371-05244-30x | 371-05244-40x |
| | | | 024-35526-000 | 024-35526-000 | 024-35526-000 | 024-35526-000 |
| 2B^S | 6 | Fan Contactor (-17, -28 & -40) | 024-35444-000 (12A)** | 024-35444-000 (12A)** | 024-35444-000 (12A)** | 024-35444-000 (12A)** |
| | | Fan Contactor (-46 & -58) | 024-35441-000 (9A)** | 024-35441-000 (9A)** | 024-35441-000 (9A)** | 024-35441-000 (9A)** |
| 2C | 13 | Surge Suppressor | 031-00808-000 | 031-00808-000 | 031-00808-000 | 031-00808-000 |
| | 2 | Compressor Contactor (-17 & -28) | 024-34294-000 (150A)** | 024-34294-000 (150A)** | 024-34294-000 (150A)** | 024-34294-000 (150A)** |
| | 2 | | 024-35470-000 (80A)** | 024-35470-000 (80A)** | 024-35470-000 (80A)** | 024-35470-000 (80A)** |
| 3A | 2 | Compressor Contactor (-40) | 024-35467-000 (65A)** | 024-35467-000 (65A)** | 024-35467-000 (65A)** | 024-35467-000 (65A)** |
| | 2 | | 024-35473-000 (D9511)** | 024-35473-000 (95A)** | 024-35462-000 (50A)** | 024-35462-000 (50A)** |
| | 2 | Compressor Contactor (-46 & -58) | 024-35462-000 (50A)** | 024-35462-000 (50A)** | 024-35462-000 (50A)** | 024-35462-000 (50A)** |
| | 2 | | 024-35470-000 (80A)** | 024-35470-000 (80A)** | 024-35470-000 (80A)** | 024-35470-000 (80A)** |
| 3B | 4 | Ground Lug | 025-34088-000 | 025-34088-000 | 025-34088-000 | 025-34088-000 |
| | 1 | Terminal Block (-17 & -28) | 025-32536-000 | N/A | N/A | N/A |
| | | Terminal Block (-40, -46 & -58) | 025-34910-000 | N/A | N/A | N/A |
| 4A | 1 | Circuit Breaker (-17 & -28) | N/A | N/A | 025-34425-000 | N/A |
| | | Circuit Breaker (-40, -46 & -58) | N/A | N/A | 025-34424-000 | N/A |
| | 1 | Non-Fused Disc. Sw. (-17 & -28) | N/A | 024-30965-000 | N/A | 024-30965-000 |
| | | Non-Fused Disc. Sw. (-40) | N/A | 024-30964-000 | N/A | 024-30964-000 |
| | | Non-Fused Disc. Sw. (-46 & -58) | N/A | 024-30963-000 | N/A | 024-30963-000 |
| 4B | 3 | Safety Cover (use w/ TB -17 & -28) | 025-39397-000 | N/A | N/A | N/A |
| | | Safety Cover (use w/ TB -40, -46 & -58) | 025-39393-000 | N/A | N/A | N/A |
| 4C | 1 | Oper. Mech. (use w/ CB or NFDs) | N/A | 024-31878-000 | 024-31878-000 | 024-31878-000 |
| 4D | 1 | Ground Lug | 025-34089-000 | 025-34089-000 | 025-34089-000 | 025-34089-000 |
| 5A | 1 | Ind. Sys. Circuit Breaker (Sys. 1) | N/A | N/A | N/A | 025-34419-000 |
| | 1 | Ind. Sys. Circuit Breaker (Sys. 2) | N/A | N/A | N/A | 025-34419-000 |
| 8A | 2 | Fuse Holder | 025-37863-000 | 025-37863-000 | 025-37863-000 | 025-37863-000 |
| 8B | 6 | Fuse | See Fuse Table on Page 36 | | | |
| 9A | 4 | Ground Bar | 025-35685-000 | 025-35685-000 | 025-35685-000 | 025-35685-000 |

^SRecommended Spare Part. See Figure 12 on page 27.

Note: Lug Kits for Circuit Breakers or Non-Fused Disconnect Switches - See LUG KIT TABLE on Page 38.

**Service Note:

Make a visual inspection of the contactors in order to select the correct replacement part.

024-35441-000 (9A) R11-D0910-G7 | 024-35444-000 (12A) R11-D1210-G7
 024-35447-000 (18A) R11-D1810-G7 | 024-35451-000 (25A) R11-D2510-G7
 024-35462-000 (50A) R11-D5011-G7 | 024-35467-000 (65A) R11-D6511-G7
 024-35470-000 (80A) R11-D8011-G7 | 024-35473-000 (95A) R11-D9511-G7
 024-34294-000 (150A) TE-LC1D150-F7

*Service Note: Locate the PANEL PART NUMBER sticker on the upper right hand corner of the power panel, see Figure 11 on page 26, then refer to the appropriate parts list for that number.

POWER PANEL COMPONENTS (CONT'D)

TABLE 16 - POWER PANEL COMPONENTS - YLAA0100 & YLAA0101

| ITEM | QTY. | DESCRIPTION | SINGLE POINT TERMINAL BLOCK (SX) | SINGLE POINT NON-FUSED DISCONNECT SWITCH (SD) | SINGLE POINT CIRCUIT BREAKER (BX) | SINGLE POINT NON-FUSED DISCONNECT SWITCH W/ IND. SYSTEM CIRCUIT BREAKERS (DB) |
|------|------|---|----------------------------------|---|-----------------------------------|---|
| 2As | 3 | Fan Control Relay | 371-05246-10X | 371-05246-20X | 371-05246-30X | 371-05246-40X |
| | | | 024-35526-000 | 024-35526-000 | 024-35526-000 | 024-35526-000 |
| 2Bs | 4 | Fan Contactor (-17, -28 & -40) | 024-35444-000 (12A)** | 024-35444-000 (12A)** | 024-35444-000 (12A)** | 024-35444-000 (12A)** |
| | 1 | | 024-35447-000 (18A)** | 024-35447-000 (18A)** | 024-35447-000 (18A)** | 024-35447-000 (18A)** |
| | 3 | Fan Contactor (-46 & -58) | 024-35444-000 (12A)** | 024-35444-000 (12A)** | 024-35444-000 (12A)** | 024-35444-000 (12A)** |
| | 2 | | 024-35441-000 (9A)** | 024-35441-000 (9A)** | 024-35441-000 (9A)** | 024-35441-000 (9A)** |
| 2C | 14 | Surge Suppressor | 031-00808-000 | 031-00808-000 | 031-00808-000 | 031-00808-000 |
| | 3 | Compressor Contactor (-17 & -28) | 024-35470-000 (80A)** | 024-35470-000 (80A)** | 024-35470-000 (80A)** | 024-35470-000 (80A)** |
| | 2 | | 024-34294-000 (150A)** | 024-34294-000 (150A)** | 024-34294-000 (150A)** | 024-34294-000 (150A)** |
| 3A | 3 | Compressor Contactor (-40) | 024-35467-000 (65A)** | 024-35467-000 (65A)** | 024-35467-000 (65A)** | 024-35467-000 (65A)** |
| | 2 | | 024-35473-000 (95A)** | 024-35473-000 (95A)** | 024-35473-000 (95A)** | 024-35473-000 (95A)** |
| | 3 | Compressor Contactor (-46 & -58) | 024-35462-000 (50A)** | 024-35462-000 (50A)** | 024-35462-000 (50A)** | 024-35462-000 (50A)** |
| | 2 | | 024-35470-000 (80A)** | 024-35470-000 (80A)** | 024-35470-000 (80A)** | 024-35470-000 (80A)** |
| 3B | 5 | Ground Lug | 025-34088-000 | 025-34088-000 | 025-34088-000 | 025-34088-000 |
| | 1 | Terminal Block (-17 & -28) | 025-32536-000 | N/A | N/A | N/A |
| | | Terminal Block (-40, -46 & -58) | 025-34910-000 | N/A | N/A | N/A |
| 4A | | Circuit Breaker (-17 & -28) | N/A | N/A | 025-34425-000 | N/A |
| | 1 | Circuit Breaker (-40 & -46) | N/A | N/A | 025-34424-000 | N/A |
| | | Circuit Breaker (-58) | N/A | N/A | 025-34419-000 | N/A |
| | 1 | Non-Fused Disc. Sw. (-17 & -28) | N/A | 024-30965-000 | N/A | 024-30965-000 |
| | 1 | Non-Fused Disc. Sw. (-40 & -46) | N/A | 024-30964-000 | N/A | 024-30964-000 |
| | | Non-Fused Disc. Sw. (-58) | N/A | 024-30963-000 | N/A | 024-30963-000 |
| 4B | 3 | Safety Cover (use w/ TB -17 & -28) | 025-39397-000 | N/A | N/A | N/A |
| | | Safety Cover (use w/ TB -40, -46 & -58) | 025-39393-000 | N/A | N/A | N/A |
| 4C | 1 | Oper. Mech. (use w/ CB or NFDS) | N/A | 024-31878-000 | 024-31878-000 | 024-31878-000 |
| 4D | 1 | Ground Lug | 025-34089-000 | 025-34089-000 | 025-34089-000 | 025-34089-000 |
| 5A | 1 | Ind. Sys. Circuit Breaker (Sys. 1) | N/A | N/A | N/A | 025-34419-000 |
| | 1 | Ind. Sys. Circuit Breaker (Sys. 2) | N/A | N/A | N/A | 025-34424-000 |
| 8A | 2 | Fuse Holder | 025-37863-000 | 025-37863-000 | 025-37863-000 | 025-37863-000 |
| 8B | 6 | Fuse | | | | |
| 9A | 4 | Ground Bar | 025-35685-000 | 025-35685-000 | 025-35685-000 | 025-35685-000 |

****Service Note:**
Make a visual inspection of the contactors in order to select the correct replacement part.
024-35441-000 (9A) R11-D0910-G7 | 024-35444-000 (12A) R11-D1210-G7
024-35447-000 (18A) R11-D1810-G7 | 024-35451-000 (25A) R11-D2510-G7
024-35462-000 (50A) R11-D5011-G7 | 024-35467-000 (65A) R11-D6511-G7
024-35470-000 (80A) R11-D8011-G7 | 024-35473-000 (95A) R11-D9511-G7
024-34294-000 (150A) TE-LC1D150-F7

***Service Note:** Locate the PANEL PART NUMBER sticker on the upper right hand corner of the power panel, see Figure 11 on page 26, then refer to the appropriate parts list for that number.

Recommended Spare Part. See Figure 12 on page 27.
Note: Lug Kits for Circuit Breakers or Non-Fused Disconnect Switches - See LUG KIT TABLE on Page 38.

See Fuse Table on Page 36

POWER PANEL COMPONENTS (CONT'D)

TABLE 17 - POWER PANEL COMPONENTS - YLAA0115

| ITEM | QTY. | DESCRIPTION | SINGLE POINT TERMINAL BLOCK (SX) | SINGLE POINT NON-FUSED DISCONNECT SWITCH (SD) | SINGLE POINT CIRCUIT BREAKER (BX) | SINGLE POINT NON-FUSED DISCONNECT SWITCH W/ IND. SYSTEM CIRCUIT BREAKERS (DB) |
|-----------------------|------|--|----------------------------------|---|-----------------------------------|---|
| 2A^S | 3 | Fan Control Relay | 371-05244-10X | 371-05244-20X | 371-05244-30X | 371-05244-40X |
| | | | 024-35526-000 | 024-35526-000 | 024-35526-000 | 024-35526-000 |
| 2B^S | 4 | Fan Contactor (-17 & -28) | 024-35444-000 (12A)** | 024-35444-000 (12A)** | 024-35444-000 (12A)** | 024-35444-000 (12A)** |
| | 2 | | 024-35447-000 (18A)** | 024-35447-000 (18A)** | 024-35447-000 (18A)** | 024-35447-000 (18A)** |
| | 6 | Fan Contactor (-40) | 024-35444-000 (12A)** | 024-35444-000 (12A)** | 024-35444-000 (12A)** | 024-35444-000 (12A)** |
| | 6 | Fan Contactor (-46 & -58) | 024-35441-000 (9A)** | 024-35441-000 (9A)** | 024-35441-000 (9A)** | 024-35441-000 (9A)** |
| 2C | 13 | Surge Suppressor | 031-00808-000 | 031-00808-000 | 031-00808-000 | 031-00808-000 |
| 3A | 4 | Compressor Contactor (-17 & -28) | 024-34294-000 (150A)** | 024-34294-000 (150A)** | 024-34294-000 (150A)** | 024-34294-000 (150A)** |
| | 4 | Compressor Contactor (-40) | 024-35473-000 (95A)** | 024-35473-000 (95A)** | 024-35473-000 (95A)** | 024-35473-000 (95A)** |
| | 4 | Compressor Contactor (-46 & -58) | 024-35470-000 (80A)** | 024-35470-000 (80A)** | 024-35470-000 (80A)** | 024-35470-000 (80A)** |
| | 4 | Ground Lug | 025-34088-000 | 025-34088-000 | 025-34088-000 | 025-34088-000 |
| 4A | 1 | Terminal Block (-17 & -28) | 025-32536-000 | N/A | N/A | N/A |
| | | Terminal Block (-40, -46 & -58) | 025-34910-000 | N/A | N/A | N/A |
| | 1 | Circuit Breaker (-17 & -28) | N/A | N/A | 025-34425-000 | N/A |
| | 1 | Circuit Breaker (-40, -46 & -58) | N/A | N/A | 025-34424-000 | N/A |
| 4B | 1 | Non-Fused Disc. Sw. (-17 & -28) | N/A | 024-31889-000 | N/A | 024-31889-000 |
| | 1 | Non-Fused Disc. Sw. (-40, -46 & -58) | N/A | 024-30964-000 | N/A | 024-30964-000 |
| | 3 | Safety Cover (use w/ TB -17 & -28) | 025-39397-000 | N/A | N/A | N/A |
| | 3 | Safety Cover (use w/ TB -40, -46 & -58) | 025-39393-000 | N/A | N/A | N/A |
| 4C | 1 | Oper. Mech. (use w/ CB or NFDS) | N/A | 024-31878-000 | 024-31878-000 | 024-31878-000 |
| 4D | 1 | Ground Lug | 025-34089-000 | 025-34089-000 | 025-34089-000 | 025-34089-000 |
| 5A | 2 | Ind. Sys. Circuit Breaker (-17 & -28) | N/A | N/A | N/A | 025-34424-000 |
| | 2 | Ind. Sys. Circuit Breaker (-40, -46 & -58) | N/A | N/A | N/A | 025-34419-000 |
| 8A | 2 | Fuse Holder | 025-37863-000 | 025-37863-000 | 025-37863-000 | 025-37863-000 |
| 8B | 6 | Fuse | See Fuse Table on Page 36 | | | |
| 9A | 4 | Ground Bar | 025-35685-000 | 025-35685-000 | 025-35685-000 | 025-35685-000 |

^SRecommended Spare Part. See Figure 12 on page 27.
Note: Lug Kits for Circuit Breakers or Non-Fused Disconnect Switches - See LUG KIT TABLE on Page 38.

**Service Note:
Make a visual inspection of the contactors in order to select the correct replacement part.

*Service Note: Locate the PANEL PART NUMBER sticker on the upper right hand corner of the power panel, see Figure 11 on page 26, then refer to the appropriate parts list for that number.

- 024-35441-000 (9A) R11-D0910-G7 | 024-35444-000 (12A) R11-D1210-G7
- 024-35447-000 (18A) R11-D1810-G7 | 024-35451-000 (25A) R11-D2510-G7
- 024-35462-000 (50A) R11-D5011-G7 | 024-35467-000 (65A) R11-D6511-G7
- 024-35470-000 (80A) R11-D8011-G7 | 024-35473-000 (95A) R11-D9511-G7
- 024-34294-000 (150A) TE-LC1D150-F7

POWER PANEL COMPONENTS (CONT'D)

TABLE 18 - POWER PANEL COMPONENTS - YLAA0135 & YLAA0141

| ITEM | QTY. | DESCRIPTION | SINGLE POINT TERMINAL BLOCK (SX) | SINGLE POINT NON-FUSED DISCONNECT SWITCH (SD) | SINGLE POINT CIRCUIT BREAKER (BX) | SINGLE POINT NON-FUSED DISCONNECT SWITCH W/ IND. SYSTEM CIRCUIT BREAKERS (DB) | |
|------|------|--|----------------------------------|---|-----------------------------------|---|--|
| 2As | 3 | Fan Control Relay | 371-05244-10X | 371-05244-20X | 371-05244-30X | 371-05244-40X | |
| | | | 024-35526-000 | 024-35526-000 | 024-35526-000 | 024-35526-000 | |
| | 4 | Fan Contactor (-17 & -28) | 024-35444-000 (12A)** | 024-35444-000 (12A)** | 024-35444-000 (12A)** | 024-35444-000 (12A)** | |
| 2Bs | 2 | Fan Contactor (-17 & -28) | 024-35447-000 (18A)** | 024-35447-000 (18A)** | 024-35447-000 (18A)** | 024-35447-000 (18A)** | |
| | 6 | Fan Contactor (-40) | 024-35444-000 (12A)** | 024-35444-000 (12A)** | 024-35444-000 (12A)** | 024-35444-000 (12A)** | |
| | 6 | Fan Contactor (-46 & -58) | 024-35441-000 (9A)** | 024-35441-000 (9A)** | 024-35441-000 (9A)** | 024-35441-000 (9A)** | |
| 2C | 13 | Surge Suppressor | 031-00808-000 | 031-00808-000 | 031-00808-000 | 031-00808-000 | |
| | 4 | Compressor Contactor (-17 & -28) | 024-34294-000 (150A)** | 024-34294-000 (150A)** | 024-34294-000 (150A)** | 024-34294-000 (150A)** | |
| 3A | 4 | Compressor Contactor (-40) | 024-35473-000 (95A)** | 024-35473-000 (95A)** | 024-35473-000 (95A)** | 024-35473-000 (95A)** | |
| | 4 | Compressor Contactor (-46 & -58) | 024-35470-000 (80A)** | 024-35470-000 (80A)** | 024-35470-000 (80A)** | 024-35470-000 (80A)** | |
| 3B | 4 | Ground Lug | 025-34088-000 | 025-34088-000 | 025-34088-000 | 025-34088-000 | |
| | 1 | Terminal Block (-17 & -28) | 025-32536-000 | N/A | N/A | N/A | |
| | | Terminal Block (-40, -46 & -58) | 025-34910-000 | N/A | N/A | N/A | |
| | 1 | Circuit Breaker (-17 & -28) | N/A | N/A | 025-34425-000 | N/A | |
| 4A | 1 | Circuit Breaker (-40, -46 & -58) | N/A | N/A | 025-34424-000 | N/A | |
| | 1 | Non-Fused Disc. Sw. (-17 & -28) | N/A | 024-31889-000 | N/A | 024-31889-000 | |
| | | Non-Fused Disc. Sw. (-40, -46 & -58) | N/A | 024-30964-000 | N/A | 024-30964-000 | |
| 4B | 3 | Safety Cover (use w/ TB -17 & -28) | 025-39397-000 | N/A | N/A | N/A | |
| | | Safety Cover (use w/ TB -40, -46 & -58) | 025-39393-000 | N/A | N/A | N/A | |
| 4C | 1 | Oper. Mech. (use w/ CB or NFDS) | N/A | 024-31878-000 | 024-31878-000 | 024-31878-000 | |
| 4D | 1 | Ground Lug | 025-34089-000 | 025-34089-000 | 025-34089-000 | 025-34089-000 | |
| 5A | 2 | Ind. Sys. Circuit Breaker (-17 & -28) | N/A | N/A | N/A | 025-34424-000 | |
| | 2 | Ind. Sys. Circuit Breaker (-40, -46 & -58) | N/A | N/A | N/A | 025-34419-000 | |
| 8A | 2 | Fuse Holder | 025-37863-000 | 025-37863-000 | 025-37863-000 | 025-37863-000 | |
| 8B | 6 | Fuse | See Fuse Table on Page 36 | | | | |
| 9A | 4 | Ground Bar | 025-35685-000 | 025-35685-000 | 025-35685-000 | 025-35685-000 | |

*Recommended Spare Part. See Figure 12 on page 27.

Note: Lug Kits for Circuit Breakers or Non-Fused Disconnect Switches - See LUG KIT TABLE on Page 38.

*Service Note: Locate the PANEL PART NUMBER sticker on the upper right hand corner of the power panel, see Figure 11 on page 26, then refer to the appropriate parts list for that number.

**Service Note:

Make a visual inspection of the contactors in order to select the correct replacement part.

024-35441-000 (9A) R11-D0910-G7 | 024-35444-000 (12A) R11-D1210-G7
 024-35447-000 (18A) R11-D1810-G7 | 024-35451-000 (25A) R11-D2510-G7
 024-35462-000 (50A) R11-D5011-G7 | 024-35467-000 (65A) R11-D6511-G7
 024-35470-000 (80A) R11-D8011-G7 | 024-35473-000 (95A) R11-D9511-G7
 024-34294-000 (150A) TE-LC1D150-F7

POWER PANEL COMPONENTS (CONT'D)

TABLE 19 - POWER PANEL COMPONENTS - YLAA0120 & YLAA0125

| ITEM | QTY. | DESCRIPTION | SINGLE POINT TERMINAL BLOCK (SX) | SINGLE POINT NON-FUSED DISCONNECT SWITCH (SD) | SINGLE POINT CIRCUIT BREAKER (BX) | SINGLE POINT NON-FUSED DISCONNECT SWITCH W/ IND. SYSTEM CIRCUIT BREAKERS (DB) |
|-----------------------|------|--|----------------------------------|---|-----------------------------------|---|
| 2A^S | 3 | Fan Control Relay | 371-05246-10X | 371-05246-20X | 371-05246-30X | 371-05246-40X |
| | | | 024-35526-000 | 024-35526-000 | 024-35526-000 | 024-35526-000 |
| 2B^S | 3 | Fan Contactor (-17 & -28) | 024-35444-000 (12A)** | 024-35444-000 (12A)** | 024-35444-000 (12A)** | 024-35444-000 (12A)** |
| | 3 | | 024-35447-000 (18A)** | 024-35447-000 (18A)** | 024-35447-000 (18A)** | 024-35447-000 (18A)** |
| 2C | 4 | Fan Contactor (-40) | 024-35444-000 (12A)** | 024-35444-000 (12A)** | 024-35444-000 (12A)** | 024-35444-000 (12A)** |
| | 2 | | 024-35447-000 (18A)** | 024-35447-000 (18A)** | 024-35447-000 (18A)** | 024-35447-000 (18A)** |
| 3A | 6 | Fan Contactor (-46 & -58) | 024-35444-000 (12A)** | 024-35444-000 (12A)** | 024-35444-000 (12A)** | 024-35444-000 (12A)** |
| | 14 | Surge Suppressor | 031-00808-000 | 031-00808-000 | 031-00808-000 | 031-00808-000 |
| 3B | 4 | Compressor Contactor (-17 & -28) | 024-34294-000 (150A)** | 024-34294-000 (150A)** | 024-34294-000 (150A)** | 024-34294-000 (150A)** |
| | 1 | | 024-35470-000 (80A)** | 024-35470-000 (80A)** | 024-35470-000 (80A)** | 024-35470-000 (80A)** |
| 4A | 4 | Compressor Contactor (-40) | 024-35473-000 (95A)** | 024-35473-000 (95A)** | 024-35473-000 (95A)** | 024-35473-000 (95A)** |
| | 1 | | 024-35467-000 (65A)** | 024-35467-000 (65A)** | 024-35467-000 (65A)** | 024-35467-000 (65A)** |
| 4B | 4 | Compressor Contactor (-46 & -58) | 024-35470-000 (80A)** | 024-35470-000 (80A)** | 024-35470-000 (80A)** | 024-35470-000 (80A)** |
| | 1 | | 024-35462-000 (50A)** | 024-35462-000 (50A)** | 024-35462-000 (50A)** | 024-35462-000 (50A)** |
| 4C | 5 | Ground Lug | 025-34088-000 | 025-34088-000 | 025-34088-000 | 025-34088-000 |
| | 1 | Terminal Block (-17 & -28) | 025-32536-000 | N/A | N/A | N/A |
| 4D | 1 | Terminal Block (-40, -46 & -58) | 025-34910-000 | N/A | N/A | N/A |
| | 1 | Circuit Breaker (-17 & -28) | N/A | N/A | 025-34473-000 | N/A |
| 5A | 1 | Circuit Breaker (-40, -46 & -58) | N/A | N/A | 025-34424-000 | N/A |
| | 1 | Non-Fused Disc. Sw. (-17 & -28) | N/A | 024-31889-000 | N/A | 024-31889-000 |
| 4B | 1 | Non-Fused Disc. Sw. (-40) | N/A | 024-30965-000 | N/A | 024-30965-000 |
| | 3 | Safety Cover (use w/ TB -17 & -28) | 025-39397-000 | 024-30964-000 | N/A | 024-30964-000 |
| 4C | 1 | Safety Cover (use w/ TB -40, -46 & -58) | 025-39393-000 | N/A | N/A | N/A |
| | 1 | Oper. Mech. (use w/ CB or NFDS) | N/A | 024-31878-000 | 024-31878-000 | 024-31878-000 |
| 4D | 1 | Ground Lug | 025-34089-000 | 025-34089-000 | 025-34089-000 | 025-34089-000 |
| | 2 | Ind. Sys. Circuit Breaker (-17 & -28) | N/A | N/A | N/A | 025-34424-000 |
| 5A | 2 | Ind. Sys. Circuit Breaker (-40, -46 & -58) | N/A | N/A | N/A | 025-34419-000 |
| | 2 | Fuse Holder | 025-37863-000 | 025-37863-000 | 025-37863-000 | 025-37863-000 |
| 8A | 6 | Fuse | See Fuse Table on Page 36 | | | |
| | 4 | Ground Bar | 025-35685-000 | 025-35685-000 | 025-35685-000 | 025-35685-000 |

^SRecommended Spare Part. See Figure 12 on page 27.
 Note: Lug Kits for Circuit Breakers or Non-Fused Disconnect Switches - See LUG KIT TABLE on Page 38.
^{*}Service Note: Locate the PANEL PART NUMBER sticker on the upper right hand corner of the power panel, see Figure 11 on page 26, then refer to the appropriate parts list for that number.
^{**}Service Note: Make a visual inspection of the contactors in order to select the correct replacement part.
 024-35441-000 (9A) R11-D0910-G7 | 024-35444-000 (12A) R11-D1210-G7
 024-35447-000 (18A) R11-D1810-G7 | 024-35451-000 (25A) R11-D2510-G7
 024-35462-000 (50A) R11-D5011-G7 | 024-35467-000 (65A) R11-D6511-G7
 024-35470-000 (80A) R11-D8011-G7 | 024-35473-000 (95A) R11-D9511-G7
 024-34294-000 (150A) TE-LC1D150-F7

POWER PANEL COMPONENTS (CONT'D)

TABLE 20 - POWER PANEL COMPONENTS YLAA0150

| ITEM | QTY. | DESCRIPTION | SINGLE POINT TERMINAL BLOCK (SX) | SINGLE POINT NON-FUSED DISCONNECT SWITCH (SD) | SINGLE POINT CIRCUIT BREAKER (BX) | SINGLE POINT NON-FUSED DISCONNECT SWITCH W/ IND. SYSTEM CIRCUIT BREAKERS (DB) |
|-----------------------|------|--|----------------------------------|---|-----------------------------------|---|
| 2A^S | 3 | Fan Control Relay | 371-05246-10X | 371-05246-20X | 371-05246-30X | 371-05246-40X |
| | 4 | Fan Contactor (-17 & -28) | 024-35526-000 | 024-35526-000 | 024-35526-000 | 024-35526-000 |
| | 2 | Fan Contactor (-17 & -28) | 024-35447-000 (18A)** | 024-35444-000 (12A)** | 024-35444-000 (12A)** | 024-35444-000 (12A)** |
| 2B^S | 4 | Fan Contactor (-40) | 024-35451-000 (25A)** | 024-35447-000 (18A)** | 024-35447-000 (18A)** | 024-35447-000 (18A)** |
| | 2 | Fan Contactor (-40) | 024-35444-000 (12A)** | 024-35444-000 (12A)** | 024-35444-000 (12A)** | 024-35444-000 (12A)** |
| | 6 | Fan Contactor (-46 & -58) | 024-35447-000 (18A)** | 024-35447-000 (18A)** | 024-35447-000 (18A)** | 024-35447-000 (18A)** |
| 2C | 14 | Surge Suppressor | 024-35444-000 (12A)** | 024-35444-000 (12A)** | 024-35444-000 (12A)** | 024-35444-000 (12A)** |
| | 5 | Compressor Contactor (-17 & -28) | 031-00808-000 | 031-00808-000 | 031-00808-000 | 031-00808-000 |
| 3A | 5 | Compressor Contactor (-40) | 024-34294-000 (150A)** | 024-34294-000 (150A)** | 024-34294-000 (150A)** | 024-34294-000 (150A)** |
| | 5 | Compressor Contactor (-46 & -58) | 024-35473-000 (95A)** | 024-35473-000 (95A)** | 024-35473-000 (95A)** | 024-35473-000 (95A)** |
| 3B | 5 | Ground Lug | 024-35470-000 (80A)** | 024-35470-000 (80A)** | 024-35470-000 (80A)** | 024-35470-000 (80A)** |
| | 1 | Terminal Block (-17 & -28) | 025-34088-000 | 025-34088-000 | 025-34088-000 | 025-34088-000 |
| | 1 | Terminal Block (-40, -46 & -58) | 025-32536-000 | N/A | N/A | N/A |
| 4A | 1 | Circuit Breaker (-17 & -28) | 025-34910-000 | N/A | N/A | N/A |
| | 1 | Circuit Breaker (-40, -46 & -58) | N/A | N/A | 025-34473-000 | N/A |
| | 1 | Non-Fused Disc. Sw. (-17 & -28) | N/A | N/A | 025-34424-000 | N/A |
| | 3 | Safety Cover (use w/ TB -17 & -28) | N/A | 024-31889-000 | N/A | 024-31889-000 |
| 4B | 3 | Safety Cover (use w/ TB -40, -46 & -58) | 025-39397-000 | 024-30965-000 | N/A | 024-30965-000 |
| 4C | 1 | Oper. Mech. (use w/ CB or NFDS) | 025-39393-000 | N/A | N/A | N/A |
| 4D | 1 | Ground Lug | 025-34089-000 | 024-31878-000 | 024-31878-000 | 024-31878-000 |
| | 2 | Ind. Sys. Circuit Breaker (-17 & -28) | N/A | 025-34089-000 | 025-34089-000 | 025-34089-000 |
| 5A | 1 | Ind. Sys. Circuit Breaker (-40, -46 & -58) | N/A | N/A | N/A | 025-34424-000 |
| | 1 | Fuse Holder | N/A | N/A | N/A | 025-34419-000 |
| 8A | 2 | Fuse Holder | 025-37863-000 | 025-37863-000 | 025-37863-000 | 025-37863-000 |
| 8B | 6 | Fuse | See Fuse Table on Page 36 | | | |
| 9A | 4 | Ground Bar | 025-35685-000 | 025-35685-000 | 025-35685-000 | 025-35685-000 |

^SRecommended Spare Part. See Figure 12 on page 27.

Note: Lug Kits for Circuit Breakers or Non-Fused Disconnect Switches - See LUG KIT TABLE on Page 38.

^{**}Service Note:

Make a visual inspection of the contactors in order to select the correct replacement part.

024-35441-000 (9A) R11-D0910-G7 | 024-35444-000 (12A) R11-D1210-G7
 024-35447-000 (18A) R11-D1810-G7 | 024-35451-000 (25A) R11-D2510-G7
 024-35462-000 (50A) R11-D5011-G7 | 024-35467-000 (65A) R11-D6511-G7
 024-35470-000 (80A) R11-D8011-G7 | 024-35473-000 (95A) R11-D9511-G7
 024-34294-000 (150A) TE-LC1D150-F7

*Service Note: Locate the PANEL PART NUMBER sticker on the upper right hand corner of the power panel, see Figure 11 on page 26, then refer to the appropriate parts list for that number.

POWER PANEL COMPONENTS (CONT'D)

TABLE 21 - POWER PANEL COMPONENTS - YLAA0155 & YLAA0156

| ITEM | QTY. | DESCRIPTION | SINGLE POINT TERMINAL BLOCK (SX) | SINGLE POINT NON-FUSED DISCONNECT SWITCH (SD) | SINGLE POINT CIRCUIT BREAKER (BX) | SINGLE POINT NON-FUSED DISCONNECT SWITCH W/ IND. SYSTEM CIRCUIT BREAKERS (DB) |
|-----------------------|------|--|----------------------------------|---|-----------------------------------|---|
| 2A^S | 3 | Fan Control Relay | 371-05246-10X | 371-05246-20X | 371-05246-30X | 371-05246-40X |
| | 4 | Fan Control Relay | 024-35526-000 | 024-35526-000 | 024-35526-000 | 024-35526-000 |
| 2B^S | 2 | Fan Contactor (-17 & -28) | 024-35447-000 (18A)** | 024-35444-000 (12A)** | 024-35444-000 (12A)** | 024-35444-000 (12A)** |
| | 4 | Fan Contactor (-40) | 024-35451-000 (25A)** | 024-35447-000 (18A)** | 024-35447-000 (18A)** | 024-35447-000 (18A)** |
| | 2 | Fan Contactor (-46 & -58) | 024-35444-000 (12A)** | 024-35444-000 (12A)** | 024-35444-000 (12A)** | 024-35444-000 (12A)** |
| | 6 | Fan Contactor (-46 & -58) | 024-35447-000 (18A)** | 024-35447-000 (18A)** | 024-35447-000 (18A)** | 024-35447-000 (18A)** |
| 2C | 14 | Surge Suppressor | 031-00808-000 | 031-00808-000 | 031-00808-000 | 031-00808-000 |
| | 5 | Compressor Contactor (-17 & -28) | 024-34294-000 (150A)** | 024-34294-000 (150A)** | 024-34294-000 (150A)** | 024-34294-000 (150A)** |
| 3A | 5 | Compressor Contactor (-40) | 024-35473-000 (95A)** | 024-35473-000 (95A)** | 024-35473-000 (95A)** | 024-35473-000 (95A)** |
| | 5 | Compressor Contactor (-46 & -58) | 024-35470-000 (80A)** | 024-35470-000 (80A)** | 024-35470-000 (80A)** | 024-35470-000 (80A)** |
| 3B | 5 | Ground Lug | 025-34088-000 | 025-34088-000 | 025-34088-000 | 025-34088-000 |
| | 1 | Terminal Block (-17 & -28) | 025-32536-000 | N/A | N/A | N/A |
| 4A | 1 | Terminal Block (-40, -46 & -58) | 025-34910-000 | N/A | N/A | N/A |
| | 1 | Circuit Breaker (-17 & -28) | N/A | N/A | 025-34473-000 | N/A |
| | 1 | Circuit Breaker (-40, -46 & -58) | N/A | N/A | 025-34424-000 | N/A |
| | 1 | Non-Fused Disc. Sw. (-17 & -28) | N/A | 024-31889-000 | N/A | 024-31889-000 |
| 4B | 3 | Safety Cover (use w/ TB -17 & -28) | 025-39397-000 | N/A | N/A | N/A |
| | 1 | Safety Cover (use w/ TB -40, -46 & -58) | 025-39393-000 | N/A | N/A | N/A |
| 4C | 1 | Oper. Mech. (use w/ CB or NFDS) | 025-34089-000 | 024-31878-000 | 024-31878-000 | 024-31878-000 |
| | 1 | Ground Lug | 025-34089-000 | 025-34089-000 | 025-34089-000 | 025-34089-000 |
| 5A | 2 | Ind. Sys. Circuit Breaker (-17 & -28) | N/A | N/A | N/A | 025-34424-000 |
| | 1 | Ind. Sys. Circuit Breaker (-40, -46 & -58) | N/A | N/A | N/A | 025-34419-000 |
| 8A | 2 | Fuse Holder | 025-37863-000 | 025-37863-000 | 025-37863-000 | 025-37863-000 |
| | 6 | Fuse | | See Fuse Table on Page 36 | | |
| 9A | 4 | Ground Bar | 025-35685-000 | 025-35685-000 | 025-35685-000 | 025-35685-000 |

****Service Note:**
Make a visual inspection of the contactors in order to select the correct replacement part.
024-35441-000 (9A) R11-D0910-G7 | 024-35444-000 (12A) R11-D1210-G7
024-35447-000 (18A) R11-D1810-G7 | 024-35451-000 (25A) R11-D2510-G7
024-35462-000 (50A) R11-D5011-G7 | 024-35467-000 (65A) R11-D6511-G7
024-35470-000 (80A) R11-D8011-G7 | 024-35473-000 (95A) R11-D9511-G7
024-34294-000 (150A) TE-1C1D150-F7

***Service Note:** Locate the PANEL PART NUMBER sticker on the upper right hand corner of the power panel, see Figure 11 on page 26, then refer to the appropriate parts list for that number.

SRecommended Spare Part. See Figure 12 on page 27.
Note: Lug Kits for Circuit Breakers or Non-Fused Disconnect Switches - See LUG KIT TABLE on Page 38.

POWER PANEL COMPONENTS (CONT'D)

TABLE 22 - POWER PANEL COMPONENTS - YLAA0170 & YLAA0175

| ITEM | QTY. | DESCRIPTION | SINGLE POINT TERMINAL BLOCK (SX) | SINGLE POINT NON-FUSED DISCONNECT SWITCH (SD) | SINGLE POINT CIRCUIT BREAKER (BX) | SINGLE POINT NON-FUSED DISCONNECT SWITCH W/ IND. SYSTEM CIRCUIT BREAKERS (DB) |
|-----------------------|------|--|----------------------------------|---|-----------------------------------|---|
| 2A^S | 3 | Fan Control Relay | 371-05246-10X | 371-05246-20X | 371-05246-30X | 371-05246-40X |
| | 4 | Fan Control Relay | 024-35526-000 | 024-35526-000 | 024-35526-000 | 024-35526-000 |
| | 2 | Fan Contactor (-17 & -28) | 024-35447-000 (18A)** | 024-35444-000 (12A)** | 024-35444-000 (12A)** | 024-35444-000 (12A)** |
| 2B^S | 4 | Fan Contactor (-40) | 024-35451-000 (25A)** | 024-35447-000 (18A)** | 024-35447-000 (18A)** | 024-35447-000 (18A)** |
| | 2 | Fan Contactor (-40) | 024-35444-000 (12A)** | 024-35444-000 (12A)** | 024-35444-000 (12A)** | 024-35444-000 (12A)** |
| | 6 | Fan Contactor (-46 & -58) | 024-35447-000 (18A)** | 024-35447-000 (18A)** | 024-35447-000 (18A)** | 024-35447-000 (18A)** |
| 2C | 14 | Surge Suppressor | 024-35444-000 (12A)** | 024-35444-000 (12A)** | 024-35444-000 (12A)** | 024-35444-000 (12A)** |
| | 5 | Compressor Contactor (-17 & -28) | 031-00808-000 | 031-00808-000 | 031-00808-000 | 031-00808-000 |
| 3A | 5 | Compressor Contactor (-40) | 024-34294-000 (150A)** | 024-34294-000 (150A)** | 024-34294-000 (150A)** | 024-34294-000 (150A)** |
| | 5 | Compressor Contactor (-46 & -58) | 024-35473-000 (95A)** | 024-35473-000 (95A)** | 024-35473-000 (95A)** | 024-35473-000 (95A)** |
| | 5 | Compressor Contactor (-46 & -58) | 024-35470-000 (80A)** | 024-35470-000 (80A)** | 024-35470-000 (80A)** | 024-35470-000 (80A)** |
| 3B | 5 | Ground Lug | 025-34088-000 | 025-34088-000 | 025-34088-000 | 025-34088-000 |
| | 1 | Terminal Block (-17 & -28) | 025-32536-000 | N/A | N/A | N/A |
| | 1 | Terminal Block (-40, -46 & -58) | 025-34910-000 | N/A | N/A | N/A |
| 4A | 1 | Circuit Breaker (-17 & -28) | N/A | N/A | 025-34473-000 | N/A |
| | 1 | Circuit Breaker (-40, -46 & -58) | N/A | N/A | 025-34424-000 | N/A |
| | 1 | Non-Fused Disc. Sw. (-17 & -28) | N/A | 024-31889-000 | N/A | 024-31889-000 |
| | 3 | Non-Fused Disc. Sw. (-40, -46 & -58) | N/A | 024-30965-000 | N/A | 024-30965-000 |
| 4B | 3 | Safety Cover (use w/ TB -17 & -28) | 025-39397-000 | N/A | N/A | N/A |
| | 1 | Safety Cover (use w/ TB -40, -46 & -58) | 025-39393-000 | N/A | N/A | N/A |
| 4C | 1 | Oper. Mech. (use w/ CB or NFDS) | N/A | 024-31878-000 | 024-31878-000 | 024-31878-000 |
| 4D | 1 | Ground Lug | 025-34089-000 | 025-34089-000 | 025-34089-000 | 025-34089-000 |
| | 2 | Ind. Sys. Circuit Breaker (-17 & -28) | N/A | N/A | N/A | 025-34424-000 |
| 5A | 1 | Ind. Sys. Circuit Breaker (-40, -46 & -58) | N/A | N/A | N/A | 025-34419-000 |
| | 1 | Ind. Sys. Circuit Breaker (-40, -46 & -58) | N/A | N/A | N/A | 025-34420-000 |
| 8A | 2 | Fuse Holder | 025-37863-000 | 025-37863-000 | 025-37863-000 | 025-37863-000 |
| 8B | 6 | Fuse | | | | |
| 9A | 4 | Ground Bar | 025-35685-000 | 025-35685-000 | 025-35685-000 | 025-35685-000 |

^SRecommended Spare Part. See Figure 12 on page 27.

Note: Lug Kits for Circuit Breakers or Non-Fused Disconnect Switches - See LUG KIT TABLE on Page 38.

*Service Note: Locate the PANEL PART NUMBER sticker on the upper right hand corner of the power panel, see Figure 11 on page 26, then refer to the appropriate parts list for that number.

**Service Note:

Make a visual inspection of the contactors in order to select the correct replacement part.

024-35441-000 (9A) R11-D0910-G7 | 024-35444-000 (12A) R11-D1210-G7
 024-35447-000 (18A) R11-D1810-G7 | 024-35451-000 (25A) R11-D2510-G7
 024-35462-000 (50A) R11-D5011-G7 | 024-35467-000 (65A) R11-D6511-G7
 024-35470-000 (80A) R11-D8011-G7 | 024-35473-000 (95A) R11-D9511-G7
 024-34294-000 (150A) TE-LC1D150-F7

LUG KITS AND FUSES

TABLE 23 - LUG KITS (CIRCUIT BREAKER OR NON-FUSED DISCONNECT SWITCH)

| LUG KITS | | LUGS PER KIT | FITS CB FRAME | AMP | WIRE SIZE | YORK PART NUMBER |
|----------|----------|--------------|---------------|------|------------------|------------------|
| CB-0294 | ABB-K4TE | 3 | S4 | 250A | #6 - 350 kCMIL | 025-34418-000 |
| CB-0295 | ABB-K5TF | | S5 | 300A | 250 - 500 kCMIL | 025-34481-000 |
| CB-0296 | ABB-K5TG | | S5 | 400A | #3/0 - 250 kCMIL | 025-34420-000 |
| CB-0297 | ABB-K6TH | | S6 | 600A | 250 - 500 kCMIL | 025-34414-000 |
| CB-0298 | ABB-K6TJ | | S6 | 800A | #2/0 - 400 kCMIL | 025-34415-000 |

TABLE 24 - POWER PANEL FUSE TABLE

| FUSE | | SIZE | YORK LUG KIT PART NUMBER |
|---------|------|----------------|--------------------------|
| FU-0494 | 600V | 15A Time Delay | 025-34141-000 |
| FU-0746 | 600V | 30A Time Delay | 025-39683-000 |
| FU-0495 | 600V | 20A Time Delay | 025-34142-000 |
| FU-0490 | 600V | 8A Time Delay | 025-34137-000 |
| FU-0493 | 600V | 12A Time Delay | 025-34140-000 |
| FU-0496 | 600V | 25A | 025-41732-000 |

See item 8B on tables 12-22 starting on page 28.

CONTROL PANEL COMPONENTS

CONTROL PANEL

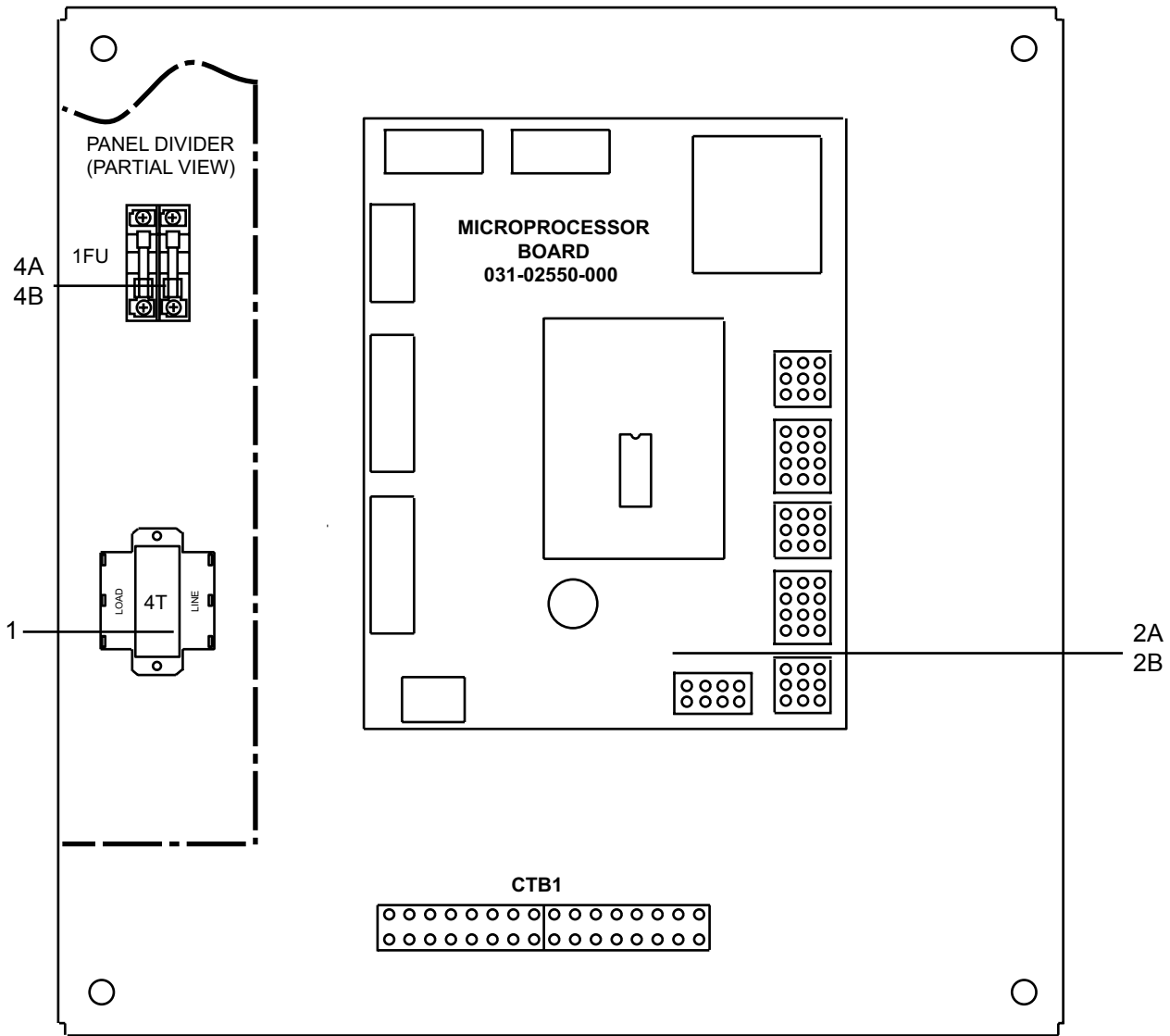

Reference Table 25 on page 41

203741-1b

FIGURE 13 - CONTROL PANEL COMPONENTS

CONTROL PANEL COMPONENTS (CONT'D)

TABLE 25 - CONTROL PANEL COMPONENTS

| ITEM | DESCRIPTION | COMMON PARTS | QUANTITY |
|-----------------|-----------------------|---------------|----------|
| 1 | Transformer | 025-27911-000 | 1 |
| 2A [§] | Micro / IO Board Kit | 331-02550-101 | 1 |
| 2B [§] | Flashcard | 031-02755-003 | 1 |
| 4A | Fuse Holder | 025-34430-000 | 1 |
| 4B | Fuse | 025-35905-000 | 1 |
| 5 | Display | 031-02749-000 | 1 |
| 6 | Keypad | 024-36082-007 | 1 |
| 7 | Switch, On/Off | 024-25517-000 | 1 |
| 8 | Ribbon Cable, Display | 031-02108-000 | 1 |

See Figures 13 And 14 starting on page 40

[§]Recommended Spare Part

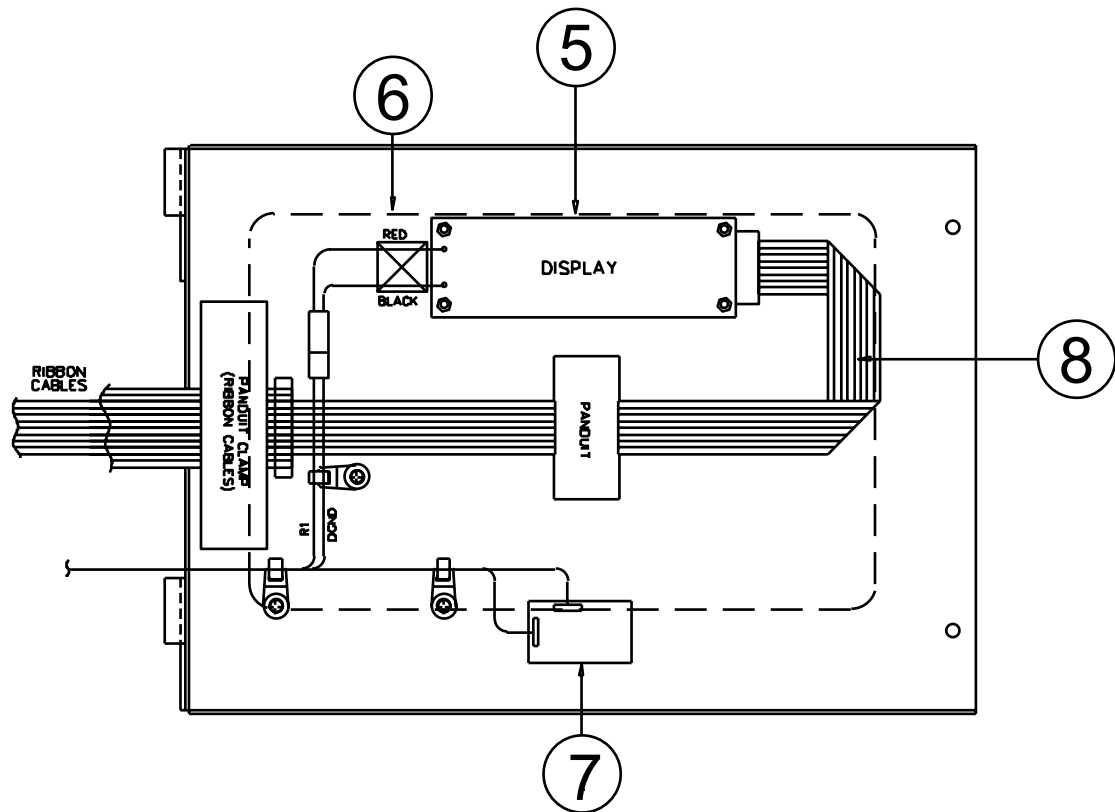

DISPLAY DOOR REAR VIEW

LD05167b

Reference Table 25 on page 41

FIGURE 14 - CONTROL PANEL COMPONENTS

SENSOR HARNESSSES

TABLE 26 - SENSOR HARNESS WIRING - YLAA0070, 0080, 0090, 0101, 0135, 0150 & YLAAA0155

| BOARD LOCATION | CABLE ITEM NO. | CABLE NO. | WIRE COLOR | PLUG PIN NO. | FUNCTION | HARNESS ASSEMBLY PART NUMBER |
|----------------|----------------|-----------|------------|--------------|---------------------------------------|------------------------------|
| MICRO P7 | 100 | 4 | Red | 5 | System #1 Suction Pressure | 575-72382-300 |
| | | | White | 10 | | |
| | | | Black | 9 | | |
| | | | Drain | 1 | | |
| | 102 | 6 | Red | 6 | System #1 Discharge Pressure | 575-72382-302 |
| | | | White | 11 | | |
| | | | Black | 7 | | |
| | | | Drain | 2 | | |
| MICRO P6 | 105 | 1 | Black | 7 | Leaving Chilled Water Temperature | 575-72382-305 |
| | | | Red | 4 | | |
| | | | Drain | 1 | | |
| | 106 | 3 | Black | 8 | Entering Chilled Water Temperature | 575-72382-306 |
| | | | Red | 5 | | |
| | | | Drain | 2 | | |
| | 104 | 2 | Black | 9 | Outside Air Temperature | 575-72382-304 |
| | | | Red | 6 | | |
| | | | Drain | 3 | | |
| MICRO P9 | 101 | 5 | Red | 5 | System #2 Suction Pressure | 575-72382-301 |
| | | | White | 10 | | |
| | | | Black | 9 | | |
| | | | Drain | 1 | | |
| | 103 | 7 | Red | 6 | System #2 Discharge Pressure | 575-72382-303 |
| | | | White | 11 | | |
| | | | Black | 7 | | |
| | | | Drain | 2 | | |

See figures 15, 16 and 17 starting on page 43

TABLE 27 - SENSOR HARNESS WIRING - YLAA0091, 0115 & YLAAA0120

| BOARD LOCATION | CABLE ITEM NO. | CABLE NO. | WIRE COLOR | PLUG PIN NO. | FUNCTION | HARNESS ASSEMBLY PART NUMBER |
|----------------|----------------|-----------|------------|--------------|---------------------------------------|------------------------------|
| MICRO P7 | 100 | 4 | Red | 5 | System #1 Suction Pressure | 575-72382-307 |
| | | | White | 10 | | |
| | | | Black | 9 | | |
| | | | Drain | 1 | | |
| | 102 | 6 | Red | 6 | System #1 Discharge Pressure | 575-72382-309 |
| | | | White | 11 | | |
| | | | Black | 7 | | |
| | | | Drain | 2 | | |
| MICRO P6 | 105 | 1 | Black | 7 | Leaving Chilled Water Temperature | 575-72382-312 |
| | | | Red | 4 | | |
| | | | Drain | 1 | | |
| | 106 | 3 | Black | 8 | Entering Chilled Water Temperature | 575-72382-313 |
| | | | Red | 5 | | |
| | | | Drain | 2 | | |
| | 104 | 2 | Black | 9 | Outside Air Temperature | 575-72382-311 |
| | | | Red | 6 | | |
| | | | Drain | 3 | | |
| MICRO P9 | 101 | 5 | Red | 5 | System #2 Suction Pressure | 575-72382-308 |
| | | | White | 10 | | |
| | | | Black | 9 | | |
| | | | Drain | 1 | | |
| | 103 | 7 | Red | 6 | System #2 Discharge Pressure | 575-72382-310 |
| | | | White | 11 | | |
| | | | Black | 7 | | |
| | | | Drain | 2 | | |

See figures 15, 16 and 17 starting on page 43

SENSOR HARNESSES (CONT'D)

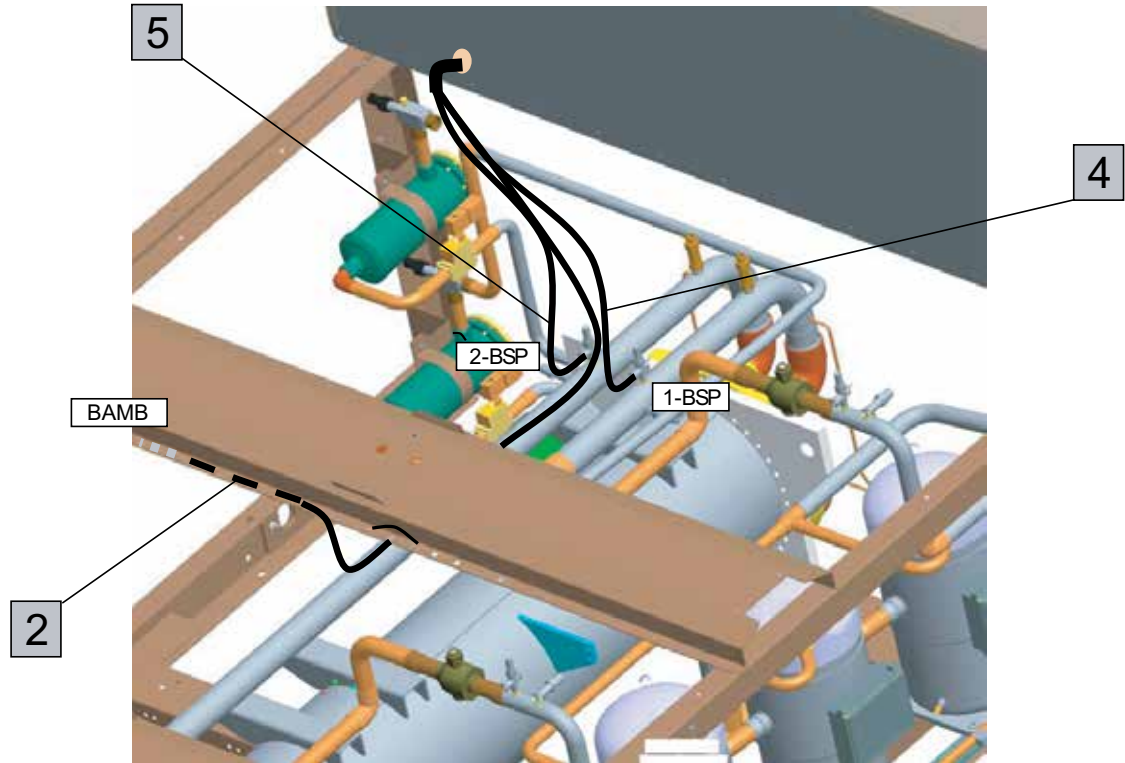

75213-001h

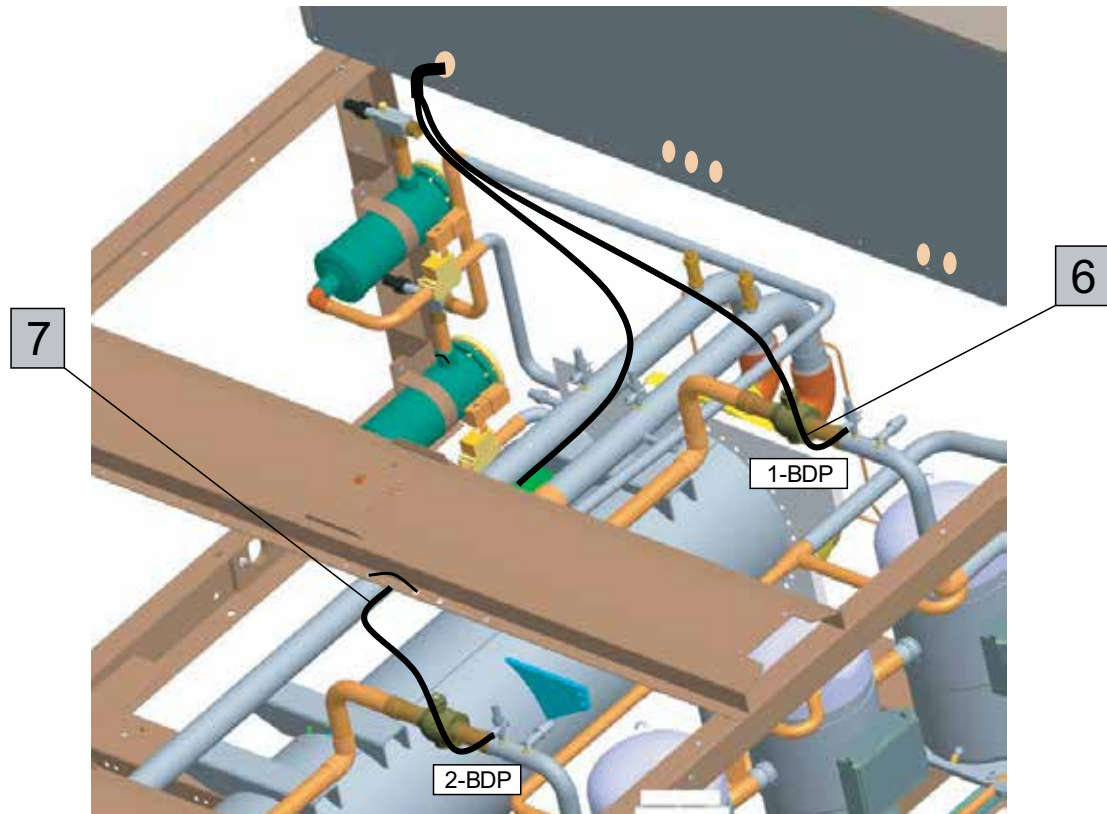

Reference Tables 26 and 27 starting on page 42

75213-001g

FIGURE 15 - HARNESS LAYOUT

SENSOR HARNESSES (CONT'D)

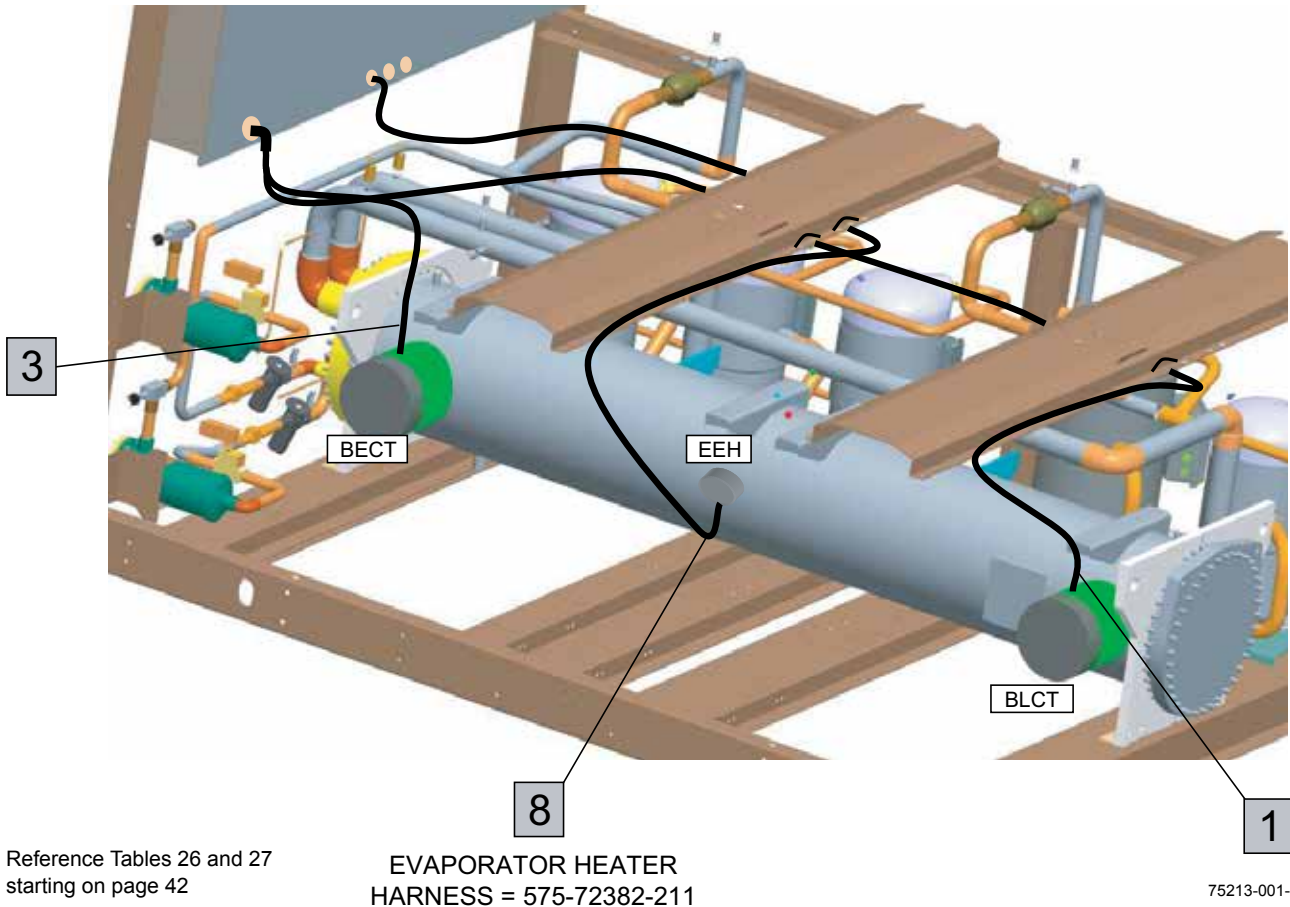

FIGURE 16 - HARNESS LAYOUT

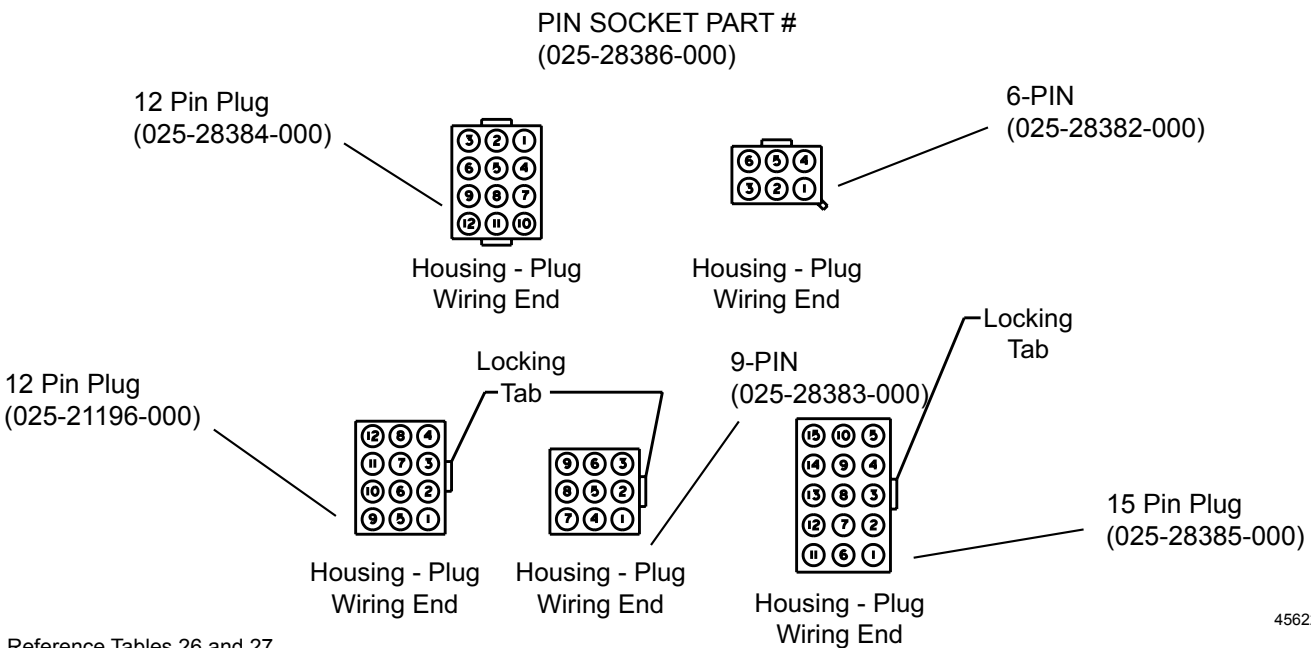

FIGURE 17 - SENSOR HOUSING & PIN SOCKET PART NUMBERS

TRANSDUCERS, PRESSURE CUTOUTS AND TEMP SENSORS

TABLE 28 - TRANSDUCERS, PRESSURE CUTOUTS AND TEMP SENSORS

| ITEM | DESCRIPTION | MODELS | PART NUMBER | QUANTITY |
|-----------------|---|--------|---------------|----------|
| 1 ^S | Sensor, Outside Air Temperature | All | 025-47688-000 | 1 |
| 2 ^S | Sensor, Entering Water Temp. (Not Shown) | All | 025-47669-000 | 1 |
| 3 ^S | Sensor, Leaving Water Temp. (Not Shown) | All | 025-47669-000 | 1 |
| 4 | Compound, Heat Conductive* | All | 013-00898-000 | - |
| 20 ^S | Transducer, Suction Pressure (0-400psi) | All | 025-41756-002 | 2 |
| 21 ^S | Transducer, Discharge Pressure (0-650psi) | All | 025-41756-003 | 2 |

^s See Recommended Spare Part

* Note: Used with items 2 and 3.

See Figure 18 on page 45

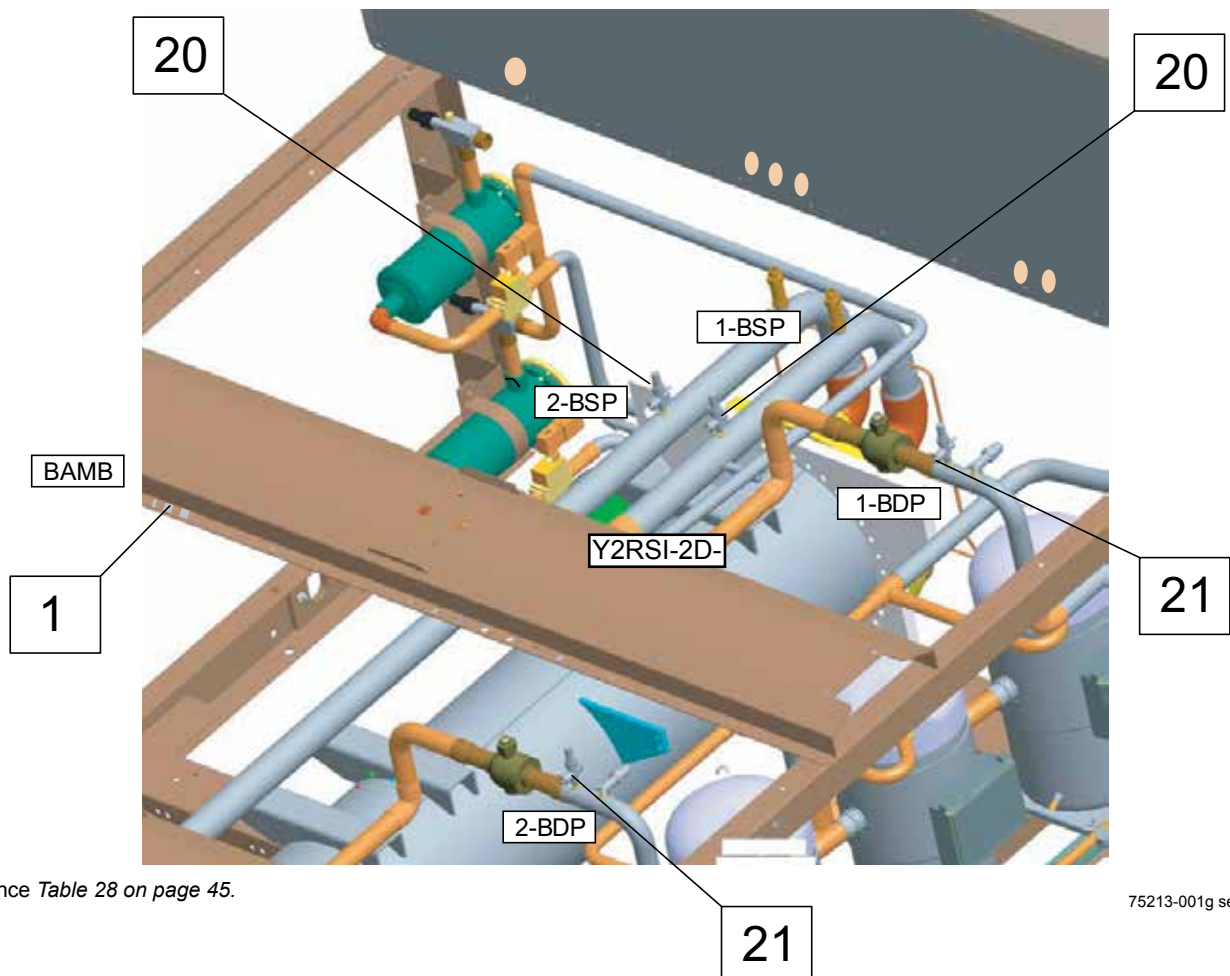

Reference Table 28 on page 45.

75213-001g sensor

FIGURE 18 - TRANSDUCERS, PRESSURE CUTOUTS AND TEMP SENSORS

TRANSDUCER AND THERMISTOR WIRE HARNESS CONNECTORS - FIELD REPLACEMENT PART NUMBERS

TABLE 29 - TRANSDUCER AND THERMISTOR WIRE HARNESS CONNECTORS - FIELD REPLACEMENT PART NUMBERS

| ITEM | LOCATION | DESCRIPTION | PINS | PART NUMBER |
|------|--------------------|----------------|-----------|---------------|
| 1 | Transducer | (0-200 psis) | 3 Pin End | 025-41756-001 |
| | | (0-400 psis) | | 025-41756-002 |
| | | (0-650 psis) | | 025-41756-003 |
| | | (0-150 psis) | | 025-41756-004 |
| | | (0-175 psis) | | 025-41756-005 |
| 2 | Wire Harness | Plug Connector | 3 Pin End | 025-41761-000 |
| 3 | | Contact Pins | | 025-41812-000 |
| 4 | Temperature Sensor | Plug Connector | 2 Pin End | 025-28948-000 |
| 5 | | Contact Pins | | 025-28949-000 |
| 6 | | Rubber Collar | | 025-28950-000 |
| 7 | Wire Harness | Plug Connector | 2 Pin End | 025-28951-000 |
| 8 | | Contact Pins | | 025-28952-000 |
| 9 | | Rubber Collar | | 025-28950-000 |

See Figure 19 on page 46

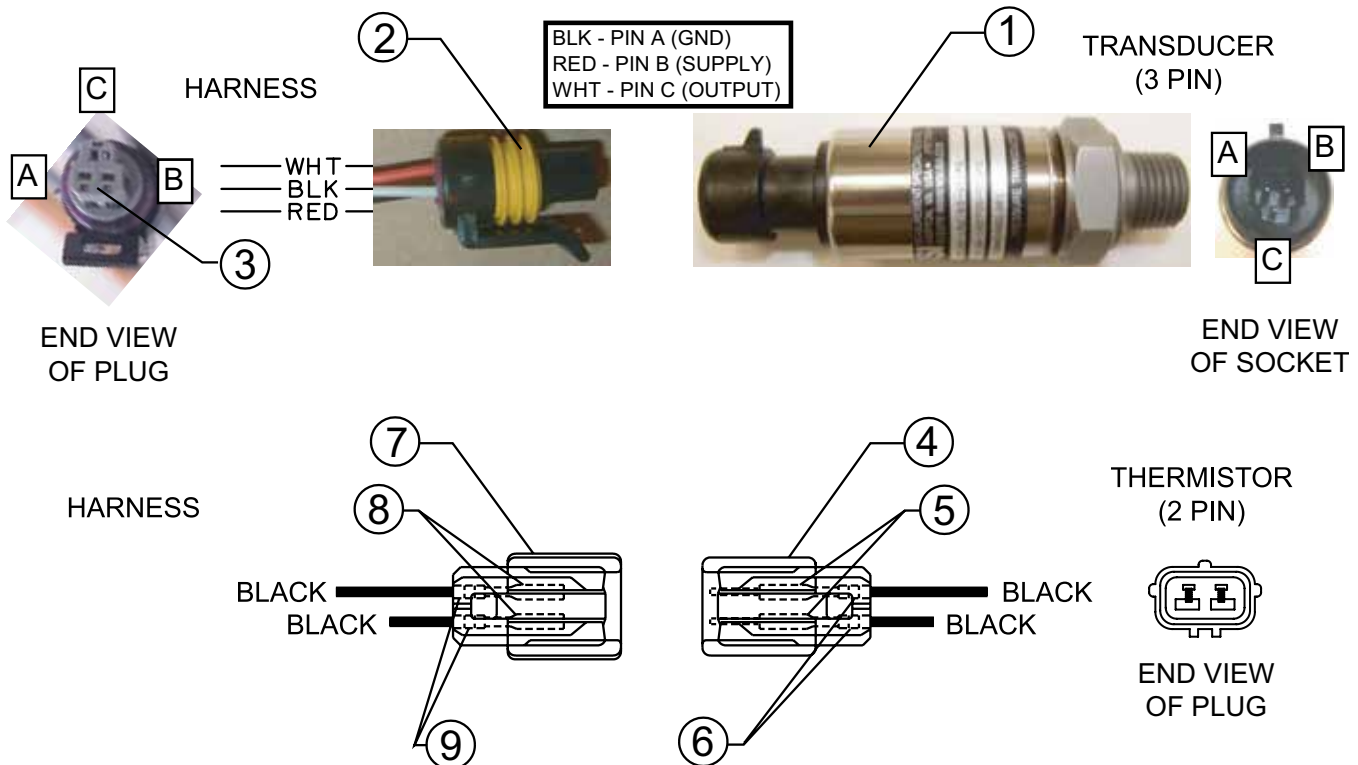

Reference Table 29 on page 46

02492-2c

FIGURE 19 - TRANSDUCER AND THERMISTOR WIRE HARNESS CONNECTORS - FIELD REPLACEMENT PART NUMBERS

VIBRATION ISOLATORS

TABLE 30 - VIBRATION ISOLATORS PART NUMBERS

| ONE INCH DEFLECTION SPRING ISOLATOR CROSS REFERENCE* | | | | |
|---|---------------------------|---------------------------|----------------------|-------------------------|
| WEIGHT RANGE (LBS.) | WEIGHT RANGE (KG.) | VENDOR PART NUMBER | COLOR | YORK PART NUMBER |
| Up to 435 lbs. | Up to 197 kg. | CP-1D-510 | BLACK | 029-25334-002 |
| 435 to 766 lbs. | 197 to 347 kg. | CP-1D-900 | DARK GREEN | 029-25334-003 |
| 766 to 1021 lbs. | 347 to 463 kg. | CP-1D-1200 | GRAY | 029-25334-004 |
| 1021 to 1157 lbs. | 463 to 525 kg. | CP-1D-1360 | WHITE | 029-25334-005 |
| 1157 to 1785 lbs. | 525 to 810 kg. | CP-1D-1785N | GRAY/RED | 029-25334-006 |
| WEIGHT RANGE (LBS.) | WEIGHT RANGE (KG.) | VENDOR PART NUMBER | COLOR | YORK PART NUMBER |
| Up to 1149 lbs. | Up to 521 kg. | C2P-1D-1350 | DARK PURPLE | 029-25334-008 |
| 1149 to 1531 lbs. | 521 to 694 kg. | C2P-1D-1800 | DARK GREEN | 029-25334-009 |
| 1531 to 2041 lbs. | 694 to 926 kg. | C2P-1D-2400 | GRAY | 029-25334-010 |
| 2041 to 2313 lbs. | 926 to 1049 kg. | C2P-1D-2720 | WHITE | 029-25334-012 |
| 2313 to 3570 lbs. | 1049 to 1619 kg. | C2P-1D-3570N | GRAY/ RED | 029-25334-013 |
| NEOPRENE ISOLATOR CROSS REFERENCE | | | | |
| WEIGHT RANGE (LBS.) | WEIGHT RANGE (KG.) | VENDOR PART NUMBER | COLOR | YORK PART NUMBER |
| Up to 826 lbs. | Up to 375 kg. | RD-3 | CHARCOAL | 029-25335-001 |
| 826 to 1689 lbs. | 375 to 766 kg. | RD-4 | BRICK RED | 029-25335-002 |
| 1689 to 4000 lbs. | 766 to 1814 kg. | RD-4 | CHARCOAL | 029-25335-004 |
| TWO INCH DEFLECTION, SEISMIC SPRING ISOLATOR CROSS REFERENCE | | | | |
| WEIGHT RANGE (LBS.) | WEIGHT RANGE (KG.) | VENDOR PART NUMBER | COLOR | YORK PART NUMBER |
| Up to 392 lbs. | Up to 178 kg. | Y2RSI-2D-460 | GREEN | 029-25336-006 |
| 392 to 605 lbs. | 178 to 274 kg. | Y2RSI-2D-710 | DARK BROWN | 029-25336-008 |
| 605 to 741 lbs. | 274 to 336 kg. | Y2RSI-2D-870 | RED | 029-25336-009 |
| 741 to 1021 lbs. | 336 to 463 kg. | Y2RSI-2D-1200N | RED/BLACK | 029-25336-010 |
| 1021 to 1438 lbs. | 463 to 652 kg. | Y2RSI-2D-1690 | PINK | 029-25336-011 |
| 1438 to 2245 lbs. | 652 to 1018 kg. | Y2RSI-2D-2640N | PINK/GRAY | 029-25336-012 |
| 2245 to 2619 lbs. | 1018 to 1188 kg. | Y2RSI-2D-2870N | PINK/GRAY/ORANGE | 029-25336-013 |
| 2619 to 3740 lbs. | 1188 to 1697 kg. | Y2RSI-2D-3280N | PINK/GRAY/DARK BROWN | 029-25336-014 |

* **NOTE:** One Inch Deflection Spring Isolators must all be of the same class for the entire unit. Must use C2P's at all locations on a selected unit, or all CP's.

YLAA CHILLER OPTIONS - KITS

TABLE 31 - FIELD INSTALLED OPTIONS PART NUMBERS

| MODEL NUMBER YLAA | CHICAGO RELIEF VALVE | FLOW SWITCH | DIFFERENTIAL PRESSURE SWITCH | VICTAULIC FLANGE KIT | ACOUSTIC SOUND BLANKET KIT | HOTGAS BY-PASS SOLENOID VALVE W/ HARNESS | |
|----------------------|----------------------------|----------------|------------------------------------|----------------------------|----------------------------------|--|------|
| MODEL # | 022-10682 | 024-39397 | 025-30919 | 023- | 310-06507 | 375-76061 | |
| 0070 | -001 | -000 | -000 | 19049-000 | -724 | -100 | |
| 0080 | | | | | -725 | -200 | |
| 0090 | | | | 19046-000 | -726 | -300 | |
| 0091 | | | | 19049-000 | -727 | -400 | |
| 0100 | | | | | -728 | | |
| 0101 | | | | | -200 | | -500 |
| 0115 | | | | | | | -600 |
| 0120 | | | | 19046-000 | -700 | -650 | |
| 0125 | | | | 19049-000 | | -700 | |
| 0135 | | | | 19046-000 | -729 | -750 | |
| 0141 | | | | | -700 | | |
| 0150 | | | | | -800 | | |
| 0155 | | | | | -730 | -000 | |
| 0156 | | | | | -600 | -900 | |
| 0170 | | | | | | | |
| 0175 | | | | | | | |

TABLE 32 - CONTROL TRANSFORMER KIT

| MODEL NUMBERS | VOLTAGE | DESCRIPTION | KIT PART NUMBER | XFMR ONLY |
|-------------------|---------|-------------------------------------|-----------------|---------------|
| YLAA0070-YLAA0175 | -17 | KIT, CONTROL TRANSFORMER 2.0 KVA | 375-76528-101 | 025-29627-002 |
| | -28 | | 375-76528-102 | 025-29627-002 |
| | -40 | | 375-76528-103 | 025-29627-002 |
| | -46 | | 375-76528-104 | 025-29627-002 |
| | -58 | | 375-76528-105 | 025-29627-004 |

ENCLOSURE KIT OPTIONS

TABLE 33 - ENCLOSURE KIT OPTIONS

| MODEL NUMBER YLAA- | WIRE ENCLOSURE | LOUVERED ENCLOSURE | WIRE / LOUVERED ENCLOSURE | LOUVERED ENCLOSURE CONDENSER ONLY | LOUVERED ENCLOSURE HAIL GUARD ONLY |
|--------------------|----------------|--------------------|---------------------------|-----------------------------------|------------------------------------|
| 0070 | 475-75917-301 | 475-75918-301 | 475-75917-303 | 475-75918-303 | 475-75918-104 |
| 0080 | | | | | |
| 0090 | | | | | |
| 0091 | 475-75917-201 | 475-75918-201 | 475-75917-203 | 475-75918-203 | |
| 0100 | | | | | |
| 0101 | | | | | |
| 0115 | | | | | |
| 0120 | | 475-75918-202 | | | |
| 0125 | 475-75917-101 | 475-75918-101 | 475-75917-103 | 475-75918-103 | |
| 0135 | | | | | |
| 0141 | 475-75917-102 | 475-75918-102 | 475-75917-104 | | |
| 0150 | 475-75917-101 | 475-75918-101 | 475-75917-103 | | |
| 0155 | 475-75917-102 | 475-75918-102 | 475-75917-104 | | |
| 0156 | 475-75917-401 | 475-75918-401 | 475-75917-403 | | |
| 0170 | | | | | |
| 0175 | | | | 475-75918-402 | |

See Figures 20 and 21 starting on page 50.

ENCLOSURE KIT OPTIONS (CONT'D)

TABLE 34 - WIRE ENCLOSURE

| WIRE ENCLOSURE | | YLAA0070, 0080 & YLAA0090 | | YLAA0091, 0100, 0101, 0115 & YLAA0120 | | YLAA0125, 0135, 0141, 0150 & YLAA0155 | | YLAA0156, 0170 & YLAA0175 | |
|----------------|-------------|---------------------------|-----|---------------------------------------|-----|---------------------------------------|-----|---------------------------|-----|
| ITEM | DESCRIPTION | 475-75917-30X | QTY | 475-75917-20X | QTY | 475-75917-10X | QTY | 475-75917-40X | QTY |
| 1 | WIRE GRILLE | 026-45058-007 | 4 | 026-45058-007 | 6 | 026-45058-007 | 8 | 026-45058-007 | 8 |
| 3 | WIRE GRILLE | 026-45058-008 | 2 | 026-45058-008 | 2 | 026-45058-008 | 2 | 026-45058-008 | 2 |
| 4 | WIRE GRILLE | 026-45058-001 | 4 | 026-45058-001 | 6 | 026-45058-001 | 8 | 026-45058-001 | 8 |
| 5 | WIRE GRILLE | 026-45058-005 | 4 | 026-45058-005 | 4 | 026-45058-005 | 4 | 026-45058-005 | 4 |
| 21 | WIRE GRILLE | 026-45058-009 | 2 | N/A | - | N/A | - | 026-45058-012 | 2 |
| 22 | WIRE GRILLE | 026-45058-010 | 2 | N/A | - | N/A | - | 026-45058-011 | 2 |

See Figure 20 on page 50

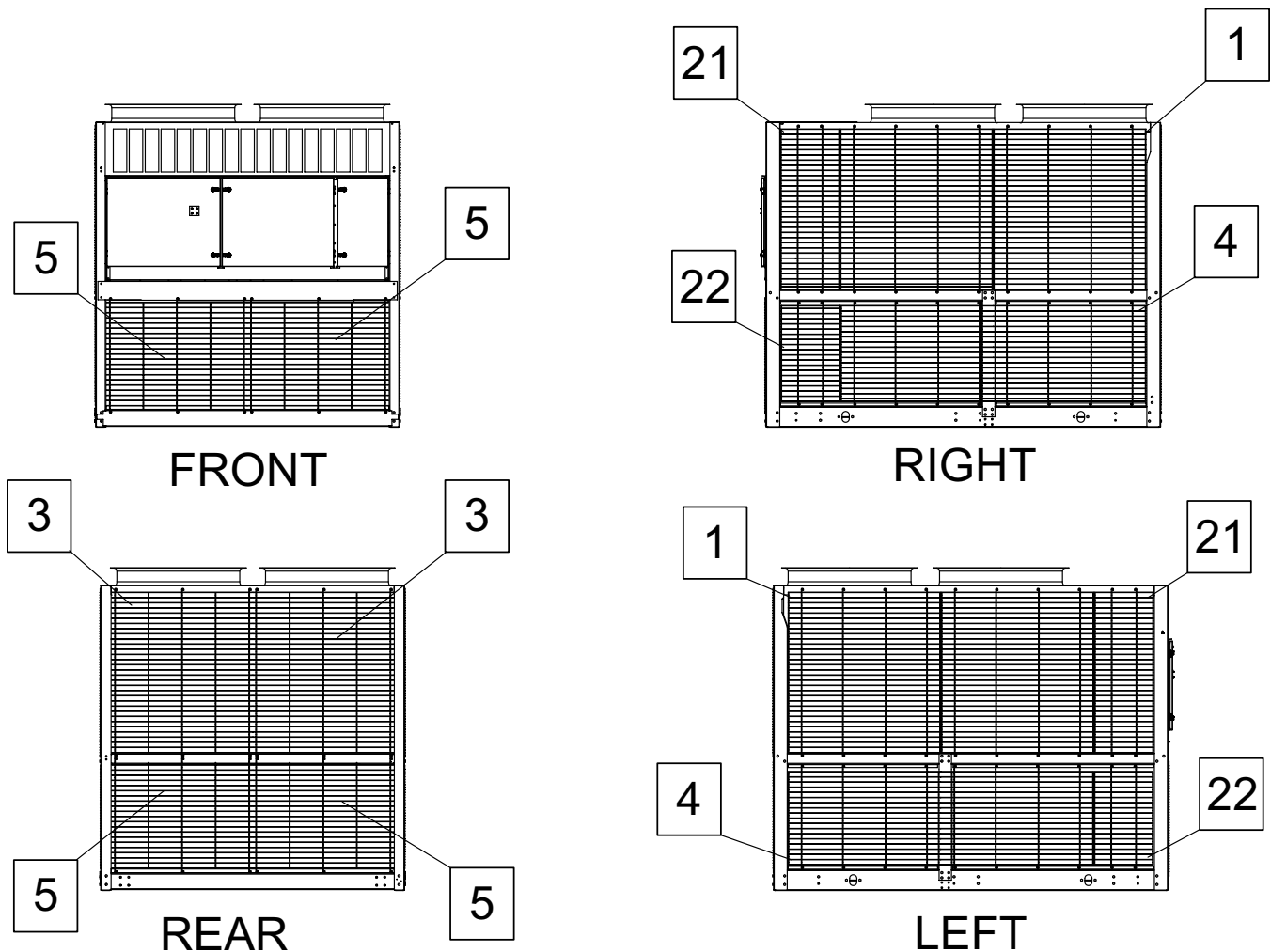

Reference Table 34 on page 50

75917-300-1

FIGURE 20 - WIRE ENCLOSURE - MODELS YLAA0070, YLAA0080 & YLAA0090 SHOWN

ENCLOSURE KIT OPTIONS (CONT'D)

TABLE 35 - LOUVERED ENCLOSURE

| WIRE ENCLOSURE | | YLAA0070, 0080 & YLAA0090 | | YLAA0091, ,0110, 0101, 0115 & YLAA0120 | | YLAA0125, 0135, 0141, 0150 & YLAA0155 | | YLAA0156, 0170 & YLAA0175 | |
|----------------|----------------|---------------------------|-----|--|-----|---------------------------------------|-----|---------------------------|-----|
| ITEM | DESCRIPTION | 475-75918-30X | QTY | 475-75918-20X | QTY | 475-75918-10X | QTY | 475-75918-40X | QTY |
| 1 | LOUVERED PANEL | 075-75918-003 | 4 | 075-75918-003 | 6 | 075-75918-003 | 8 | 075-75918-003 | 8 |
| 3 | LOUVERED PANEL | 075-75918-006 | 2 | 075-75918-006 | 2 | 075-75918-006 | 2 | 075-75918-006 | 2 |
| 4 | LOUVERED PANEL | 075-75918-001 | 1 | 075-75918-001 | 4 | 075-75918-001 | 6 | 075-75918-008 | 6 |
| 5 | LOUVERED PANEL | 075-75918-004 | 4 | 075-75918-004 | 4 | 075-75918-004 | 4 | 075-75918-004 | 4 |
| 25 | LOUVERED PANEL | 075-75918-012 | 2 | N/A | - | N/A | - | N/A | - |
| 26 | LOUVERED PANEL | 075-75918-007 | 1 | N/A | - | N/A | - | N/A | - |
| 27 | LOUVERED PANEL | 075-75918-010 | 1 | 075-75918-021 | 1 | 075-75918-021 | 1 | 075-75918-025 | 1 |
| 28 | LOUVERED PANEL | 075-75918-012 | 1 | 075-75918-015 | 1 | 075-75918-015 | 1 | 075-75918-023 | 1 |
| 29 | PANEL | 075-75918-013 | 1 | 075-75918-020 | 1 | 075-75918-020 | 1 | 075-75918-026 | 1 |
| 30 | PANEL | 075-75918-014 | 1 | 075-75918-017 | 1 | 075-75918-017 | 1 | 075-75918-017 | 1 |

See Figure 21 on page 51

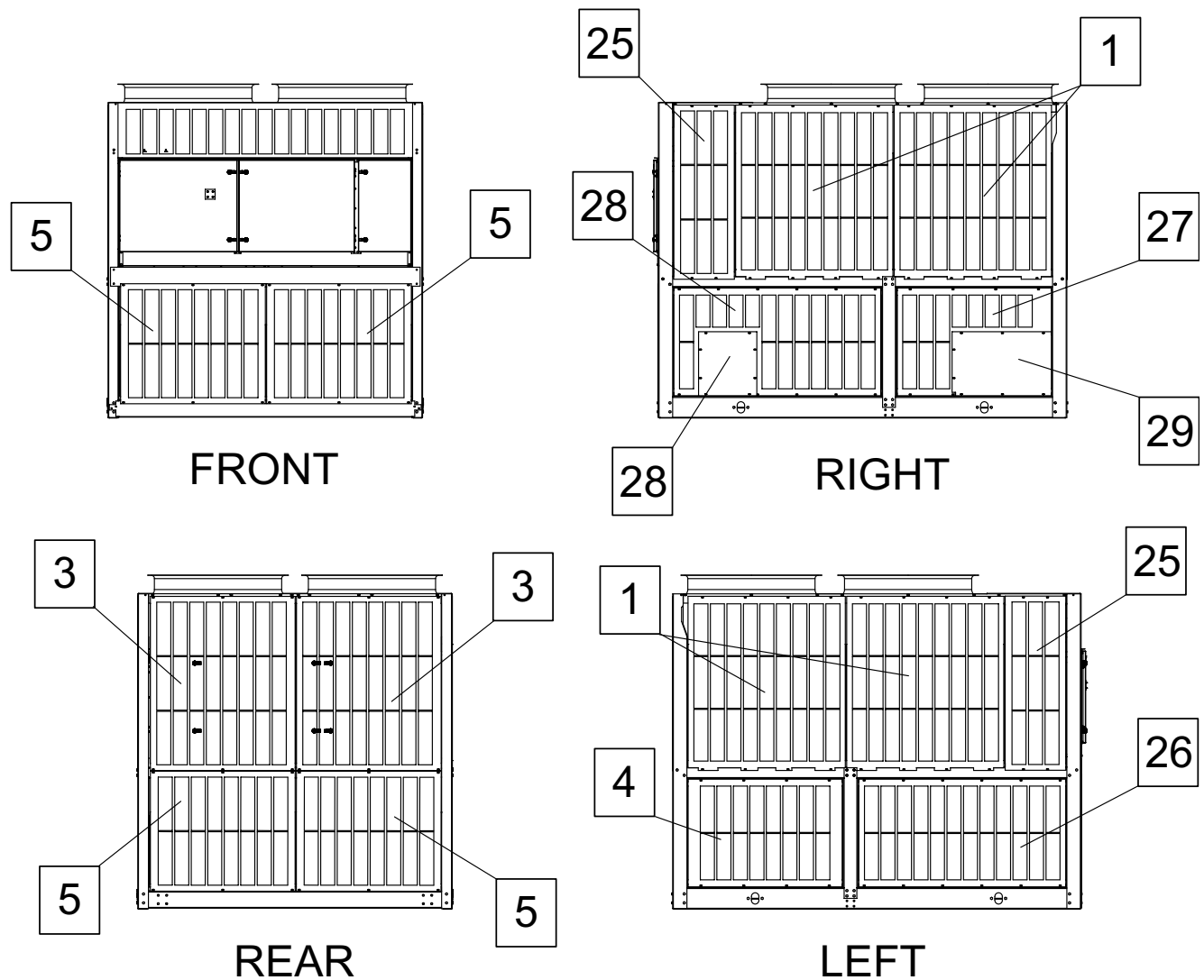

Reference Table 35 on page 51

FIGURE 21 - LOUVERED ENCLOSURE

75918-300-1

RECOMMENDED SPARE PARTS

York Model YLAA Styles A, B & C Air Cooled Hermetic Scroll Chillers
 Suggested Spare Parts List for Critical Duty Applications

TABLE 36 - RECOMMENDED SPARE PARTS - YLAA0070-YLAA0175 CHILLERS

| PAGE REF. & ITEM NUMBER | DESCRIPTION | MODEL NUMBER YLAA | PART NUMBER |
|-------------------------------------|---|----------------------|----------------|
| Page 13, Item 1 | Fan Motor (Standard) | -17 | 024-27322-103 |
| | | -28 | 024-27322-106 |
| | | -40 | 024-27322-104 |
| | | -46 | 024-27322-107 |
| | | -58 | 024-27322-102 |
| Page 13, Item 1 | Fan Motor (Low Noise) | -17 | 024-34980-002 |
| | | -28 | 024-34980-002 |
| | | -40 | 024-34980-005 |
| | | -46 | 024-34980-001 |
| | | -58 | 024-34980-003 |
| Page 13, Item 2 | Fan Blade (Standard) | All | 026-35605-000 |
| | Fan Blade (Low Noise) | All | 026-45002-000 |
| Page 14 and 15, Item 112 and 113 | Valve, Thermal Expansion | See TABLE 4 | 025-40666-000 |
| | | | 025-40681-000 |
| | | | 025-40900-000 |
| | | | 025-40900-004 |
| | | | 025-40900-008 |
| Page 14 and 15, Item 119 | Core, Dehydrator | All | 026-37540-000 |
| Page 21, Item OIL | Oil, Compressor (Type 'V') | R-410A | 011-00948-000 |
| Page 40, Item 2A | Micro / IO Board Kit | All | 331-02550-101 |
| Page 40, Item 2B | Flashcard | All | 031-02755-003 |
| Page 44, Item 1 * | Sensor, Outside Air Temperature | All | 025-47688-000 |
| Page 44, Item 2 | Sensor, Entering Water Temperature | All | 025-47669-000 |
| Page 44, Item 3 | Sensor, Leaving Water Temperature | All | 025-47669-000 |
| Page 44, Item 20 | Transducer, Suction Pressure (0-400psi) | All | 025-41756-002 |
| Page 44, Item 21 | Transducer, Discharge Pressure (0-650psi) | All | 025-41756-003 |

* **NOTE:** If the ambient sensor is to be changed from 025-28663-001 to 025-47688-000, be sure to upgrade the chiller software accordingly with Version 4, 031-02755-004.

NOTES



5000 Renaissance Drive, New Freedom, Pennsylvania USA 17349

Copyright © by Johnson Controls 2017

Form150.72-RP1 (1117)

Issue Date: November 17, 2017

Supersedes: 150.72-RP1 (114)

800-861-1001

www.johnsoncontrols.com

Subject to change without notice. Printed in USA

ALL RIGHTS RESERVED