

## Adjusting Height of Motor on T-Bar

Step 1 – With the motor properly bolted to the compressor D-flange, support the weight of the opposite driven end of the motor with an over head crane, gantry, or come-a-long. Then measure the spacing between the motor feet and the T-Bar at each end of the T-Bar.

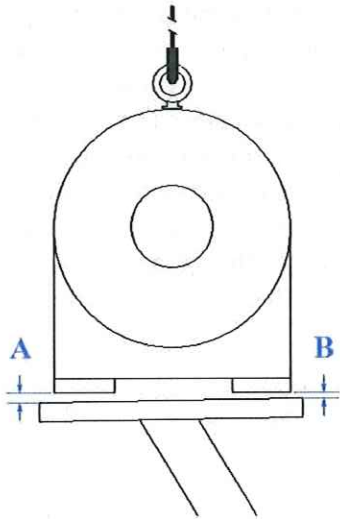

Step 2 – Calculate the difference between the two readings, and add that amount of shim to the side with the larger gap, so that the space on both sides is now equal.

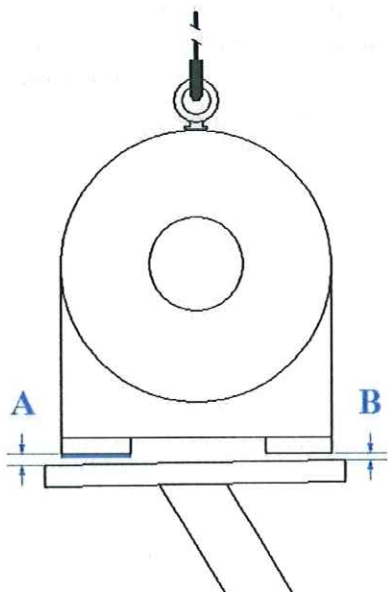

Step 3 – Position dial indicators under both ends of the T-Bar. Adjust both dial indicators to the zero position.

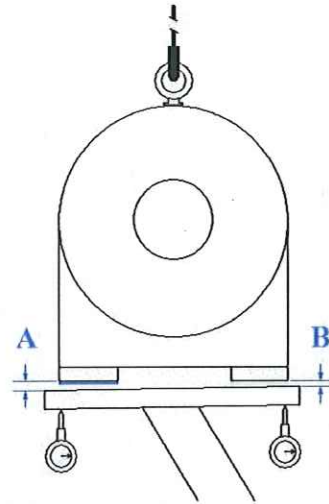

Step 4 – Place equal amounts of shim material under the feet on both sides. The dial indicators should not move. If they do, it indicates you have added too much shim, exerting force against the T-Bar.

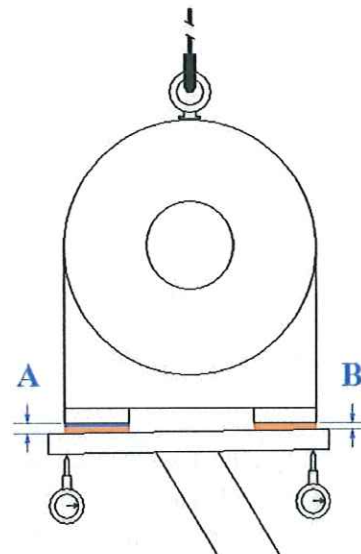

Step 5 – Release the support, allowing the weight of the non-drive end of the motor to exert force downward on the T-Bar. Record the

amount of deflection downward on each side, then calculate the difference. Add this amount of shim under the motor foot on the side with the larger amount of deflection.

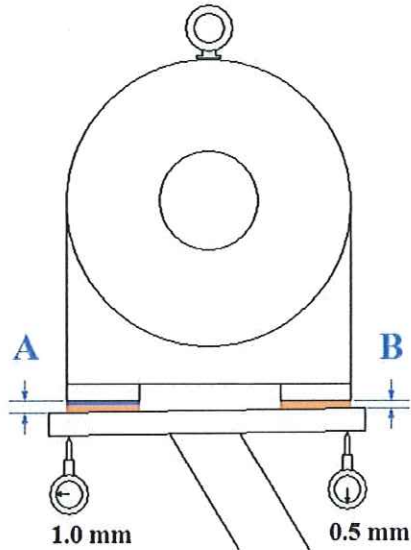

Step 6 – With the difference amount now added under the foot with the larger deflection, next check the angular offset of the coupling by measuring the difference in space from top to bottom between faces of the coupling hubs.

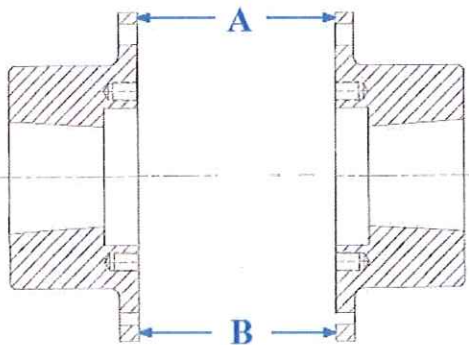

Be certain to rotate both shafts 180 degrees when you move the dial indicator or measuring instrument from the top position to the bottom position.

If the spacing across the top is larger than the bottom, the motor feet are too low and need to be raised up by adding additional shims under

both feet in equal amounts until the coupling top and bottom readings are equal.

If the spacing across the bottom is larger than the top, the motor feet are too high and need to be lowered by removing shim material from under both feet in equal amounts until the coupling top and bottom readings are equal.

If you have difficulty measuring the spacing between coupling faces, you can create an extension to your measurement device by mounting the spool piece to one coupling hub. This will create a smaller gap to be measured. Because you are rotating both shafts, and measuring from the same physical point, the added dimension due to the spool piece does not affect the measurement. We are only concerned with the difference between the two measurements.

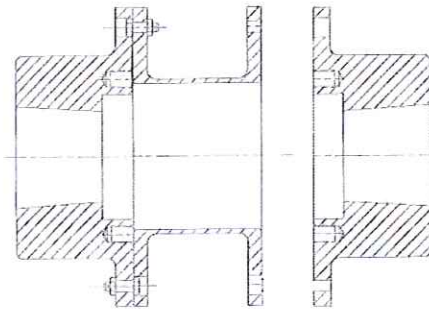

Once the top and bottom readings between coupling faces are equal, both motor feet should be secured. Be sure that tightening of the bolts does not change the alignment of the coupling.