

COMPRESSOR COMPONENTS

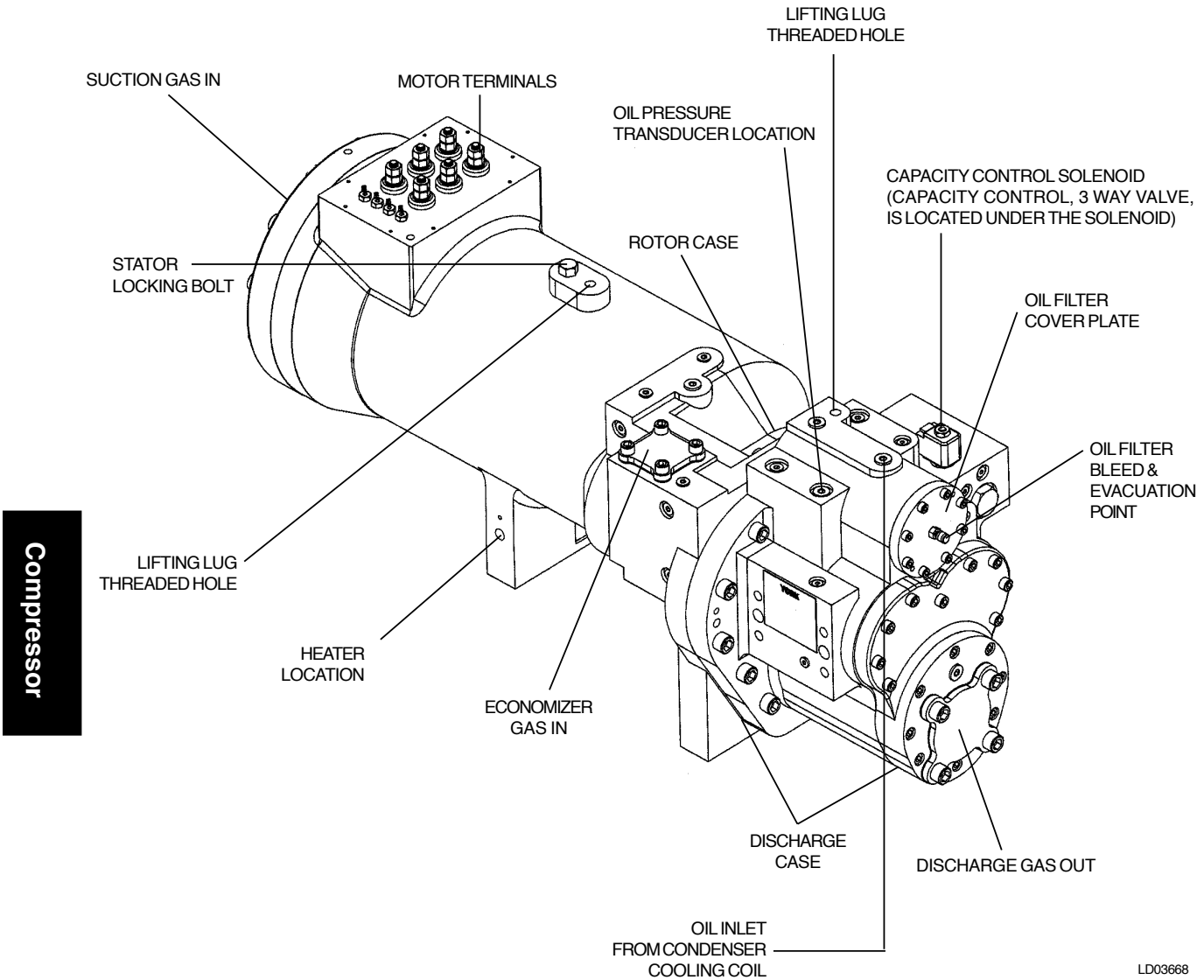

LD03668

FIG. 7 – DXS COMPRESSOR OUTLINE

Compressor

COMPRESSOR COMPONENTS / RELATED PARTS

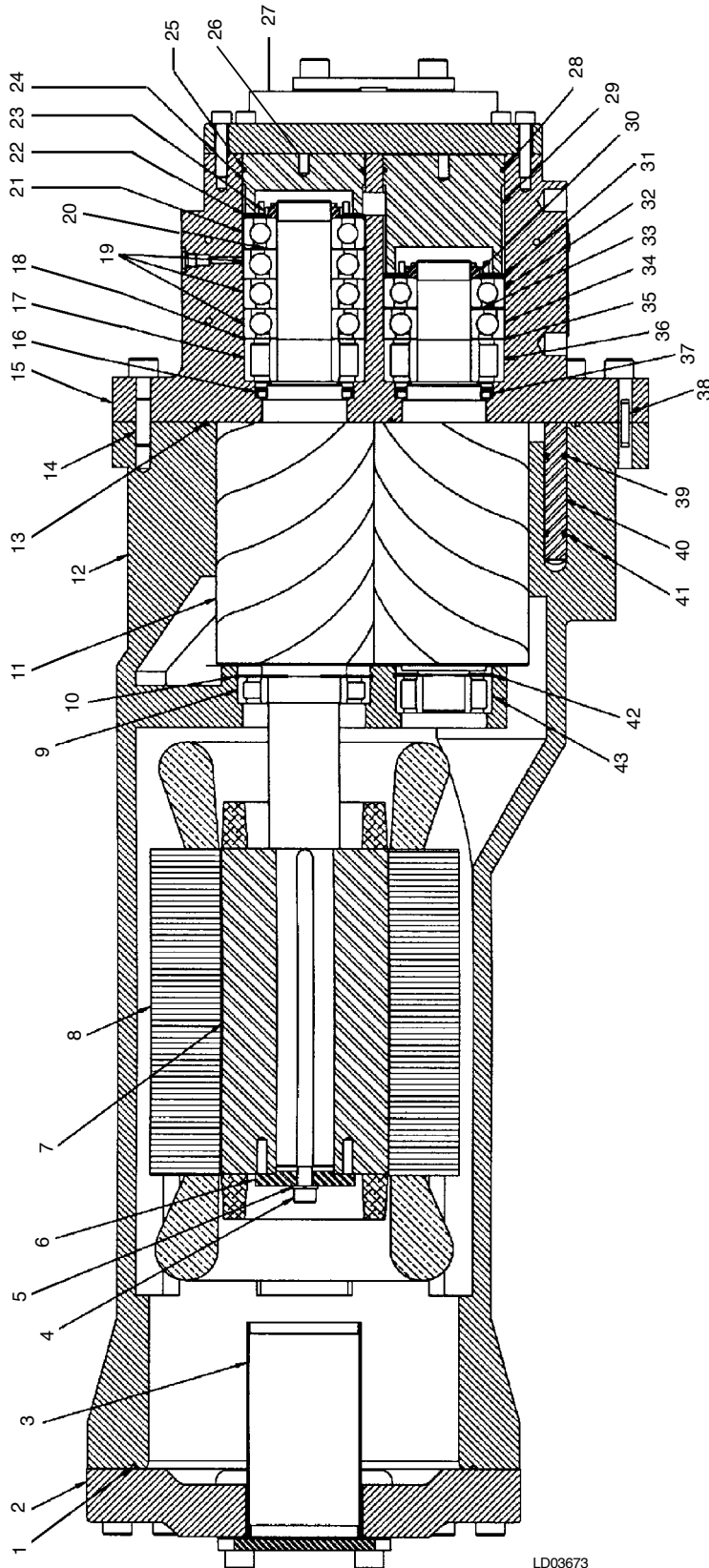

LD03673

TABLE 6 – DXS COMPRESSOR COMPONENTS / RELATED PARTS (SEE FIG. 8, PAGE 19)

NO.	PART NAME
1	O-RING
2	SUCTION COVER
3	SUCTION STRAINER
4	ROTOR SCREW
5	ROTOR LOCK WASHER
6	ROTOR CLAMP WASHER
7	ROTOR
8	STATOR
9	MALE INLET BEARING
10	MALE ROTOR RETAINING RING
11	MALE ROTOR
12	ROTOR CASE
13	O-RING
14	DOWEL PIN
15	DISCHARGE CASE
16	LIP SEAL
17	DISCHARGE RADIAL BEARING
18	SPACER SHIM
19	THRUST BEARINGS
20	THRUST SPACE SHIM
21	REVERSE THRUST BEARING
22	BEARING CLAMP NUT
23	BEARING SPACER SLEEVE
24	BEARING PRELOAD SPRING
25	O-RING
26	BEARING BORE PLUG
27	DISCHARGE COVER
28	BEARING BORE PLUG
29	BEARING PRELOAD SPRING
30	BEARING SPACER SLEEVE
31	BEARING CLAMP NUT
32	REVERSE THRUST BEARING
33	THRUST SPACER SHIM
34	THRUST BEARINGS
35	SPACER SHIM
36	DISCHARGE RADIAL BEARING
37	LIP SEAL
38	DOWEL PIN
39	SUPPORT RING
40	ECONOMIZER PLUG
41	SUPPORT RING
42	FEMALE ROTOR RETAINING RING
43	FEMALE INLET BEARING

Compressor

FIG. 8 – COMPRESSOR CROSS SECTION

COMPRESSOR COMPONENTS / RELATED PARTS (CONT'D)

TABLE 7 – DXS COMPRESSOR COMPONENTS / RELATED PARTS (SEE FIG. 9, PAGES 21 AND 21A)

ITEM NO.	PART DESCRIPTION	PART NUMBER
1	SCREW, SOCKET HD. CAP - M16 x 65mm LG.	021-19108-000
2	SCREW, SOCKET HD. CAP - M16 x 65mm LG.	021-19114-000
3	WASHER, LOCK - M12	021-19106-000
4	WASHER, CLAMP	064-48993-000
5	BOLT, TERMINAL	021-19104-000
6	INSULATOR, BOTTOM	025-33200-000
7	SEAL, TERMINAL	028-13946-000
8	INSULATOR, TOP	025-33201-000
9	WASHER, TERMINAL	021-19117-000
10	NUT - HVY. HEX 7/16" - 20UNF	021-19102-000
11	WASHER, LOCK - THK. LD. 7/16"	021-19101-000
12	THERMISTOR, 7/16" - 20UNF - 2A	025-33202-000
13	PIN, STATOR LOCATING	064-49129-000
14	O-RING 3 - 908	028-13856-000
15	PLUG - HOLLOW HEX 1-7/8"	023-18926-000
16	O-RING 3-924	028-13865-000
102	SCREW, SOCKET HD. CAP - M16 x 30mm LG.	028-19118-000
103	PLATE, VALVE COVER	064-49009-000
104	GASKET 3-1/2"	028-13864-000
105	STRAINER, SUCTION	026-35600-000
106	COVER, SUCTION	064-49198-000
107	O-RING 2 - 276	028-13852-000

COMPRESSOR COMPONENTS / RELATED PARTS (CONT'D)

COMPRESSOR COMPONENTS / RELATED PARTS (CONT'D)

NOTE: This figure is for reference only. These parts are not field serviceable.

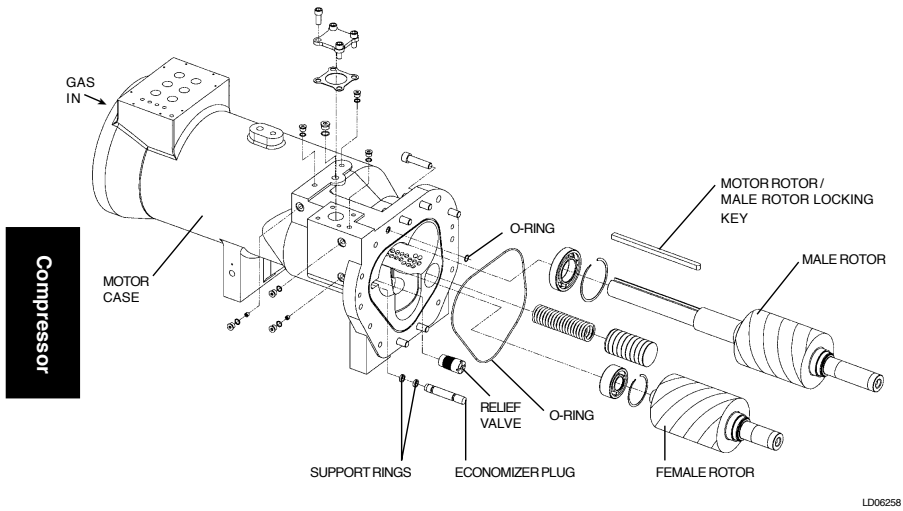
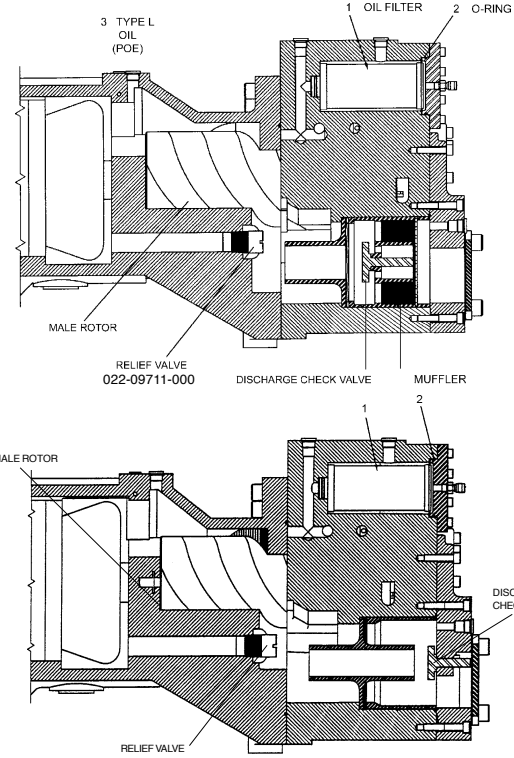

FIG. 10 – DXS COMPRESSOR PARTIAL EXPLODED VIEW



LD05289
LEVEL I
(Original)

LD06079
LEVEL II
(Improved)

FIG. 11 – COMPRESSOR FILTER AND MUFFLER

ITEM NO.	QTY PER COMP	DESCRIPTION	MODEL
1 ^s	1	FILTER	YCAS0130 - YCAS0230
2 ^s	1	O-RING	028-13849-000
3 ^s	5 GAL	OIL, 5 GAL TYPE L POE	011-00592-000

^s = Recommended Spare Part

MUFFLER KITS
An improved muffler was introduced on production units **beginning** with the compressor serial numbers shown right. It may be offered as an upgrade on earlier production units.

LEVEL II KITS		
COMP. MODEL	SERIAL NO. (START NEW MUFFLER)	KIT PART NUMBER
DXS24	X X 3283	364-49676-000
DXS36	X X 3357	364-49674-000
DXS45	X X 3074	364-49675-000

COMPRESSOR AND CONTROL COMPONENTS

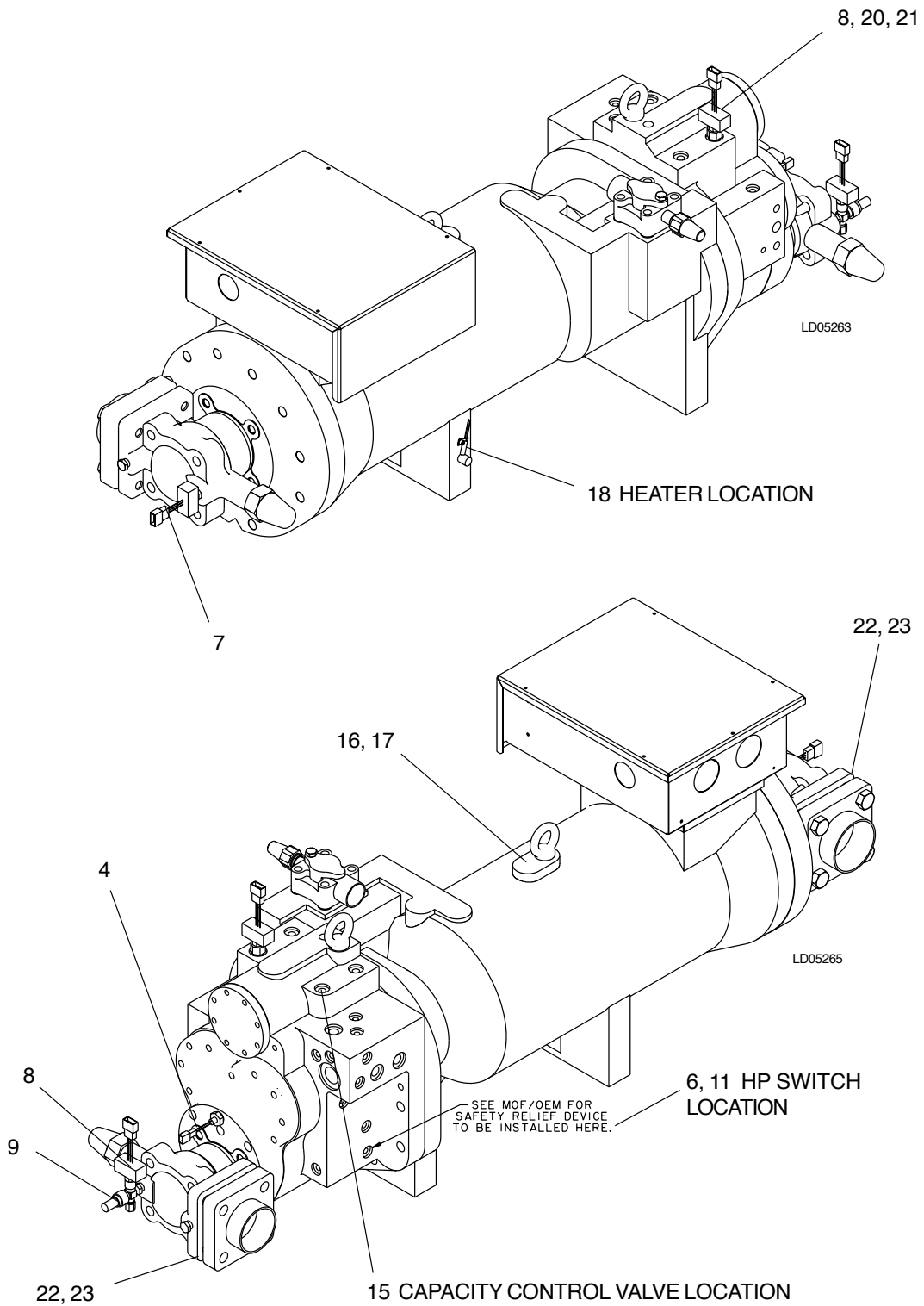

Compressor

FIG. 12 – DXS COMPRESSOR OUTLINE (REF. TABLES 8 AND 9, PAGE 25)