

Technical leaflet

**Stop valves,**  
Type SVA-ST and SVA-LT 15 (1/2 in.) - 200 (8 in.)



Contents	Page
Introduction .....	3
Features .....	3
Additional features for low temperature version (SVA-LT) .....	3
Technical data .....	4
Design .....	4
Connections .....	5
Material specification .....	6
SVA-ST and SVA-LT 15 - 40 (1/2 - 1 1/2 in.) .....	6
SVA-ST and SVA-LT 50 - 65 (2 - 2 1/2 in.) .....	7
SVA-ST and SVA-LT 80 - 200 (3 - 8 in.) .....	8
Dimensions and weights .....	9
SVA 15 - 40 (1/2 - 1 1/2 in.) angle type with cap / handwheel .....	9
SVA 15 - 40 (1/2 - 1 1/2 in.) globe type with cap / handwheel .....	10
SVA 50 - 65 (2 - 2 1/2 in.) angle type with cap / handwheel .....	11
SVA 50 - 65 (2 - 2 1/2 in.) globe type with cap / handwheel .....	12
SVA 80 - 200 (3 - 8 in.) angle type with cap / handwheel .....	13
SVA 80 - 200 (3 - 8 in.) globe type with cap / handwheel .....	14
Ordering .....	15

## Introduction



SVA-ST and SVA-LT are angle and globe type stop valves which are designed to meet all industrial refrigeration application requirements.

The valves are designed to give favorable flow characteristics and are easy to dismantle and repair when necessary. The valve cone is designed to ensure perfect closing.

## Features

- Applicable to all common refrigerants including R 717 and non corrosive gases/liquids dependent on sealing material compatibility
- Available with heavy duty industrial handwheel for frequent operation or vented cap for infrequent operation
- Available in angle and globe type with standard bonnet or extended bonnet for insulated systems
- Each valve is clearly marked with type, size and performance range
- The seal cap can be fastened by seal wire to prevent unauthorized operation
- Can accept flow in both directions
- Internal metal backseating  
- DN 15 - 65 (1/2 - 2 1/2 in.)  
Internal PTFE backseating  
- DN 80 - 200 (3 - 8 in.)
- Standard bonnet is suitable for installation in normal insulated systems
- Housing and bonnet material are low temperature steel according to requirements of the Pressure Equipment Directive and other international classification authorities
- Pressure range:  
*Standard version*  
SVA-ST: 40 bar g (580 psi g)
- Temperature range:  
*Standard version*  
-50/+150°C (-58/+302°F)
- Classification: DNV, LR, SAQ, CRN, BV etc.  
To get an updated list of certification on the products please contact your local Danfoss Sales Company

**Additional features for low temperature version (SVA-LT)**

- Low temperature version with extended bonnet for insulated low temperature applications
- Special springloaded low temperature spindle seal
- Pressure range:  
*Low temperature version*  
SVA-LT: 40 bar g (580 psi g)
- Temperature range:  
*Low temperature version*  
-60/+150°C (-76/+302°F)
- Stainless steel bolts

**Design**

*Connections*

Available with the following connections:

- Butt-weld DIN (2448)
- Butt-weld ANSI (B 36.10 Schedule 80),  
- DN 15 - 40 (1/2 - 1 1/2 in.)
- Butt-weld ANSI (B 36.10 Schedule 40),  
- DN 50 - 200 (2 - 8 in.)
- Socket Weld (ANSI B 16.11),  
- DN 15 - DN 50 (1/2 - 2 in.)
- FPT Female Pipe Thread, NPT  
(ANSI/ASME B 1.20.1) ,  
- DN 15 - 32 (1/2 - 1 1/4 in.)

*Housing*

Made of special, cold resistant steel approved for low temperature operations.

*Valve cone*

The valve cone can be turned on the spindle, thus there will be no friction between the cone and the seat, when the valve is opened and closed. A teflon tightening ring provides perfect sealing with a minimum closing momentum.

*Spindle*

Made of polished stainless steel, ideal for O-ring sealing.

*Packing gland*

Standard version (ST):

The standard packing gland ensures a perfect tightness in the range: -50/+150°C (-58/+302°F). The packing glands are equipped with a scraper ring to prevent penetration of dirt and ice into the packing gland.

Low temperature version (LT):

This comprises a springloaded seal packing gland which ensures a perfect tightness in the range: -60/+150°C (-76/+302°F). The packing glands are equipped with a scraper ring to prevent penetration of dirt and ice into the packing gland.

*Pressure Equipment Directive (PED)*

SVA-ST and LT valves are approved according to the European standard specified in the Pressure Equipment Directive and are CE marked.

For further details / restrictions - see Installation Instruction.

*Installation*

It is recommended that the valves be installed in the direction of flow indicated by the arrow on the valve body. The valve can be installed in the opposite direction but this slightly reduces the  $k_v$ -value ( $C_v$ -value).

The valve is designed to withstand high internal pressure. However, the piping system in general should be designed to avoid liquid traps and reduce the risk of hydraulic pressure caused by thermal expansion.

For further information refer to installation instructions for SVA ST and LT.

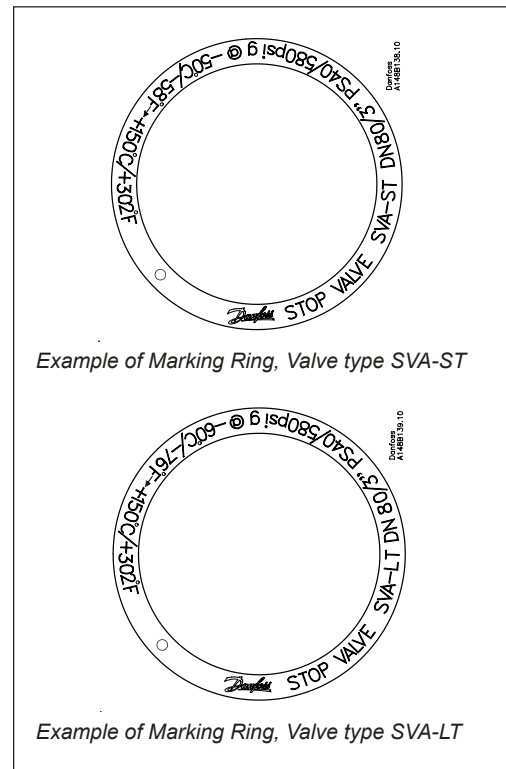

Example of Marking Ring, Valve type SVA-ST

Example of Marking Ring, Valve type SVA-LT



SVA-ST and LT valves			
Nominal bore	DN ≤ 25 mm (1 in.)	DN32-80 mm (1 1/4 - 3 in.)	DN100 - 200 mm (4 - 8 in.)
Classified for	Fluid group I		
Category	Article 3, paragraph 3	II	III

**Technical data**

- Refrigerants  
Applicable to all common non flammable refrigerants including R 717 and non corrosive gases/liquids dependent on sealing material compatibility.  
For further information please see installation instruction for SVA ST and LT.
- Flammable hydrocarbons are not recommended. For further information please contact your local Danfoss Sales Company.

- Temperature Range  
Standard version (ST):  
-50/+150°C (-58/+302°F).  
Low temperature version (LT):  
-60/+150°C (-76/+302°F).
- Pressure range  
The valves are designed for max. working pressure 40 bar g (580 psig), for both standard and low temperature versions.

## Connections

## DIN

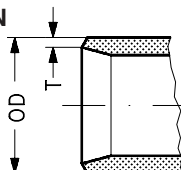

Size mm	Size in.	OD mm	T mm	OD in.	T in.			k <sub>v</sub> -angle m <sup>3</sup> /h	k <sub>v</sub> -globe m <sup>3</sup> /h	C <sub>v</sub> -angle USgal/min	C <sub>v</sub> -globe USgal/min
------------	-------------	----------	---------	-----------	----------	--	--	--	--	------------------------------------	------------------------------------

## Butt-weld DIN (2448)

15	1/2	21.3	2.3	0.839	0.091			7.0	4.9	8.1	5.7
20	3/4	26.9	2.3	1.059	0.091			14.6	10.2	16.9	11.8
25	1	33.7	2.6	1.327	0.103			24.8	17.4	28.8	20.2
32	1 1/4	42.4	2.6	1.669	0.102			42.6	29.8	49.4	34.6
40	1 1/2	48.3	2.6	1.902	0.103			45.2	31.6	52.4	36.7
50	2	60.3	2.9	2.37	0.11			80	65	93	76
65	2 1/2	76.1	2.9	3	0.11			120	97	140	113
80	3	88.9	3.2	3.50	0.13			182	152	211	176
100	4	114.3	3.6	4.50	0.14			313	278	363	323
125	5	139.7	4.0	5.50	0.16			514	470	596	545
150	6	168.3	4.5	6.63	0.18			785	597	911	693
200	8	219.1	6.3	8.63	0.25			1168	1024	1355	1188

## ANSI

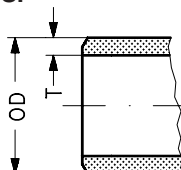

Size mm	Size in.	OD mm	T mm	OD in.	T in.			k <sub>v</sub> -angle m <sup>3</sup> /h	k <sub>v</sub> -globe m <sup>3</sup> /h	C <sub>v</sub> -angle USgal/min	C <sub>v</sub> -globe USgal/min
------------	-------------	----------	---------	-----------	----------	--	--	--	--	------------------------------------	------------------------------------

## Butt-weld ANSI (B 36.10 Schedule 80)

15	1/2	21.3	3.7	0.839	0.146			7.0	4.9	8.1	5.7
20	3/4	26.9	4.0	1.059	0.158			14.6	10.2	16.9	11.8
25	1	33.7	4.6	1.327	0.181			24.8	17.4	28.8	20.2
32	1 1/4	42.4	4.9	1.669	0.193			42.6	29.8	49.4	34.6
40	1 1/2	48.3	5.1	1.902	0.201			45.2	31.6	52.4	36.7

## Butt-weld ANSI (B 36.10 Schedule 40)

50	2	60.3	3.9	2.37	0.15			80	65	93	76
65	2 1/2	73.0	5.2	2.87	0.20			120	97	140	113
80	3	88.9	5.5	3.50	0.22			182	152	211	176
100	4	114.3	6.0	4.50	0.24			313	278	363	323
125	5	141.3	6.6	5.56	0.26			514	470	596	545
150	6	168.3	7.1	6.63	0.28			785	597	911	693
200	8	219.1	8.2	8.63	0.32			1168	1024	1355	1188

## SOC

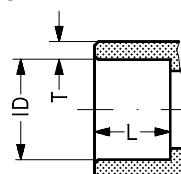

Size mm	Size in.	ID mm	T mm	ID in.	T in.	L mm	L in.	k <sub>v</sub> -angle m <sup>3</sup> /h	k <sub>v</sub> -globe m <sup>3</sup> /h	C <sub>v</sub> -angle USgal/min	C <sub>v</sub> -globe USgal/min
------------	-------------	----------	---------	-----------	----------	---------	----------	--	--	------------------------------------	------------------------------------

## Socket welding ANSI (B 16.11)

15	1/2	21.8	6.0	0.858	0.235	10	0.39	7.0	4.9	8.1	5.7
20	3/4	27.2	4.6	1.071	0.181	13	0.51	10.0	7.0	11.9	8.1
25	1	33.9	7.2	1.335	0.284	13	0.51	24.8	17.4	28.8	20.2
32	1 1/4	42.7	6.1	1.743	0.240	13	0.51	42.6	29.8	49.4	34.6
40	1 1/2	48.8	6.6	1.921	0.260	13	0.51	45.2	31.6	52.4	36.7
50	2	61.2	6.2	2.41	0.24	16	0.63	80	65	93	76

Size mm	Size in.	Inside pipe thread				k <sub>v</sub> -angle m <sup>3</sup> /h	k <sub>v</sub> -globe m <sup>3</sup> /h	C <sub>v</sub> -angle USgal/min	C <sub>v</sub> -globe USgal/min
------------	-------------	--------------------	--	--	--	--	--	------------------------------------	------------------------------------

## FPT

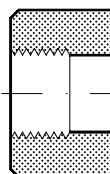

## FPT inside pipe thread, NPT (ANSI/ASME B 1.20.1)

15	1/2	(1/2 × 14 NPT)				8.5	6.0	9.9	7.0
20	3/4	(3/4 × 14 NPT)				10	7.0	11.6	8.1
25	1	(1 × 11.5 NPT)				32	22.4	37.1	26.0
32	1 1/4	(1 1/4 × 11.5 NPT)				36	25.2	41.8	29.3

Material specification

SVA-ST and SVA-LT 15 - 40 (1/2 - 1 1/2 in.)

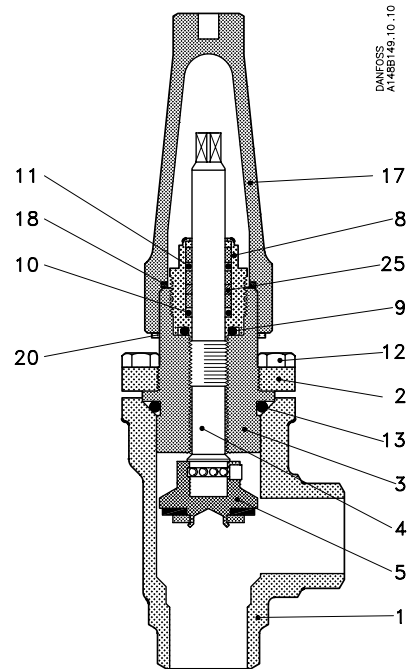
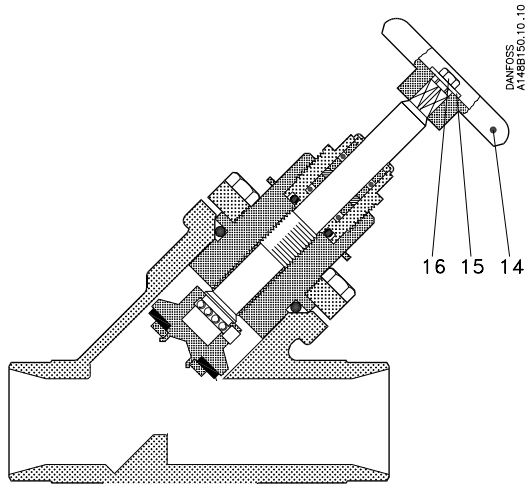

DANFOSS  
AT48B149.10.10

SVA-ST and SVA-LT

No.	Part	Material	DIN	ISO	ASTM
1	Housing	Steel	P285 QH EN10222-4		LF2A350
2	Bonnet, flange	Steel	P285 QH EN10222-4		LF2A350
3	Bonnet, Insert	Steel	9SMn28 1651	Type 2 R 683/9	1213 SAE J403
4	Spindle	Stainless steel	X10CrNiS189 17440	Type 17 683/13	AISI 303
5	Cone Cone seal	Steel Teflon (PTFE)	9SMn28, 1651	Type 2, R 683/9	1213, SAE J403
8	Packing gland	Steel	9SMn28, 1651	Type 2, R 683/9	1213, SAE J403
9	Packing washer - DN 15 - 20 (1/2 - 3/4 in.) O-ring - DN 25 - 40 (1 - 1 1/2 in.)	Aluminium Cloroprene (Neoprene)			
10-11	O-ring	Cloroprene (Neoprene)			
13	O-ring	Cloroprene (Neoprene)			
14	Handwheel	Steel			
15	Washer	Stainless steel (A2)			
16	Screw	Stainless steel (A2)			
17	Cap	Aluminium			
18	Gasket for cap	Nylon			
20	Identification ring	Stainless steel			

SVA-ST

12	Bolts	Steel	Quality 8.8*	Quality 8.8*	Grade 5
----	-------	-------	--------------	--------------	---------

SVA-LT

12	Bolts	Stainless steel	A2-70	A2-70	Type 308
25	U-sleeve sealing	PTFE + Stainless steel			

\*) Special alloy for low temperature application. Alternatively A2-70.

Material specification

SVA-ST and SVA-LT 50 - 65 (2 - 2 1/2 in.)

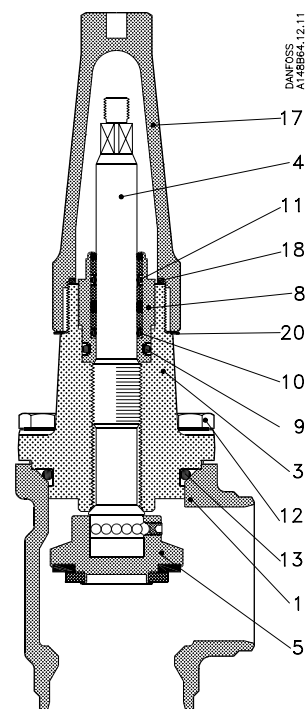
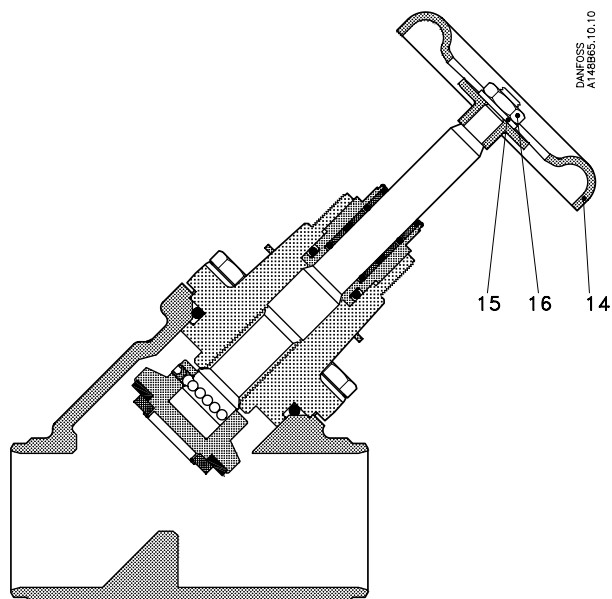

SVA-ST and SVA-LT

No.	Part	Material	DIN	ISO	ASTM
1	Housing	Steel	P285 QH EN10222-4		LF2A350
3	Valve bonnet	Steel	P285 QH EN10222-4		LF2A350
4	Spindle	Stainless steel	X8CrNiS18-9 17440	Type 17 R 683/13	AISI 303
5	Cone Cone seal	Steel Teflon (PTFE)	9SMn28, 1651	Type 2, R 683/13	1213, SAE J403
8	Packing Gland	Steel	9SMn28, 1651	Type 2, R 683/9	1213, SAE J403
9	O-ring	Cloroprene (Neoprene)			
11	O-ring	Cloroprene (Neoprene)			
13	O-ring	Cloroprene (Neoprene)			
14	Handwheel	Steel			
15	Washer	Stainless steel (A2)			
16	Nut	Stainless steel (A2)			
17	Cap	Aluminium			
18	Gasket for cap	Nylon (PA 6)			
20	Identification ring	Stainless steel			

SVA-ST

10	O-ring	Cloroprene (Neoprene)			
12	Bolts	Steel	Quality 8.8*	Quality 8.8*	Grade 5

SVA-LT

10	U-sleve sealing	PTFE + Stainless steel			
12	Bolts	Stainless steel	A2-70	A2-70	Type 308

\*) Special alloy for low temperature application. Alternatively A2-70.

**Material specification**

SVA-ST and SVA-LT 80 - 200 (3 - 8 in.)

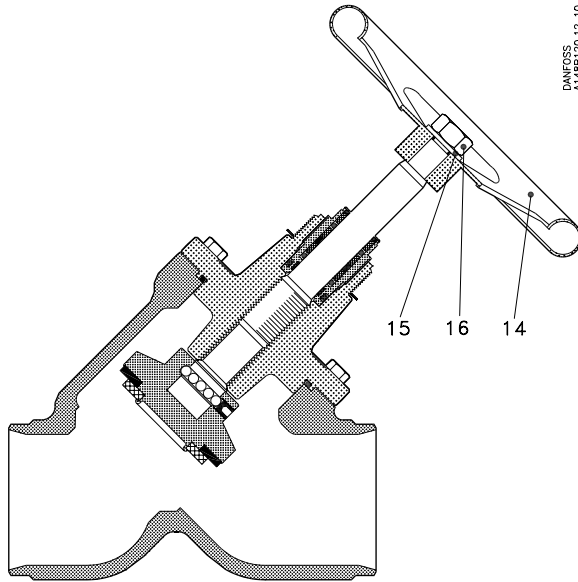

DANFOSS  
A148B120.12.10

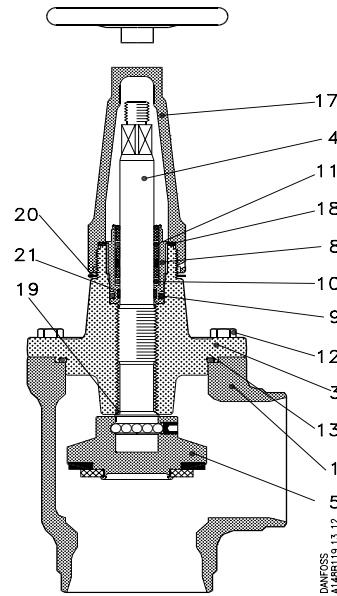

DANFOSS  
A148B119.13.12

**SVA-ST and SVA-LT**

No.	Part	Material	DIN	ISO	ASTM
1	Housing	Steel	G20Mn5 QT SEW 685		LCC, A352
3	Valve bonnet	Steel	P285 QH EN10222-4	TW6, 2604/3	LF2A350
4	Spindle	Stainless steel	X5CrNi1810 17440	Type 11, 683/13	AISI 304, A276
5	Cone Cone seal	Steel Teflon (PTFE)	9SMn28, 1651	Type 2, R 683/9	1213, SAE J403
8	Packing Gland	Steel	9SMn28, 1651	Type 2, R 683/9	1213, SAE J403
9	O-ring	Cloroprene (Neoprene)			
11	O-ring	Cloroprene (Neoprene)			
13	O-ring	Cloroprene (Neoprene)			
14	Handwheel	Steel			
15	Washer	Stainless steel			
16	Nut	Stainless steel			
17	Cap	Aluminium			
18	Gasket for cap	Nylon (PA 6)			
19	Soft backseat	Teflon (PTFE)			
20	Identification ring	Stainless steel			
21	Wear ring	Teflon (PTFE)			

**SVA-ST**

10	O-ring	Cloroprene (Neoprene)			
12	Bolts	Steel	Quality 8.8*	Quality 8.8*	Grade 5

**SVA-LT**

10	U-sleeve sealing	PTFE + Stainless steel			
12	Bolts	Stainless steel	A2-70	A2-70	Type 308

\*) Special alloy for low temperature application. Alternatively A2-70.

## Dimensions and weights

## SVA 15 - 40 (1/2 - 1 1/2 in.) angle type with cap / handwheel

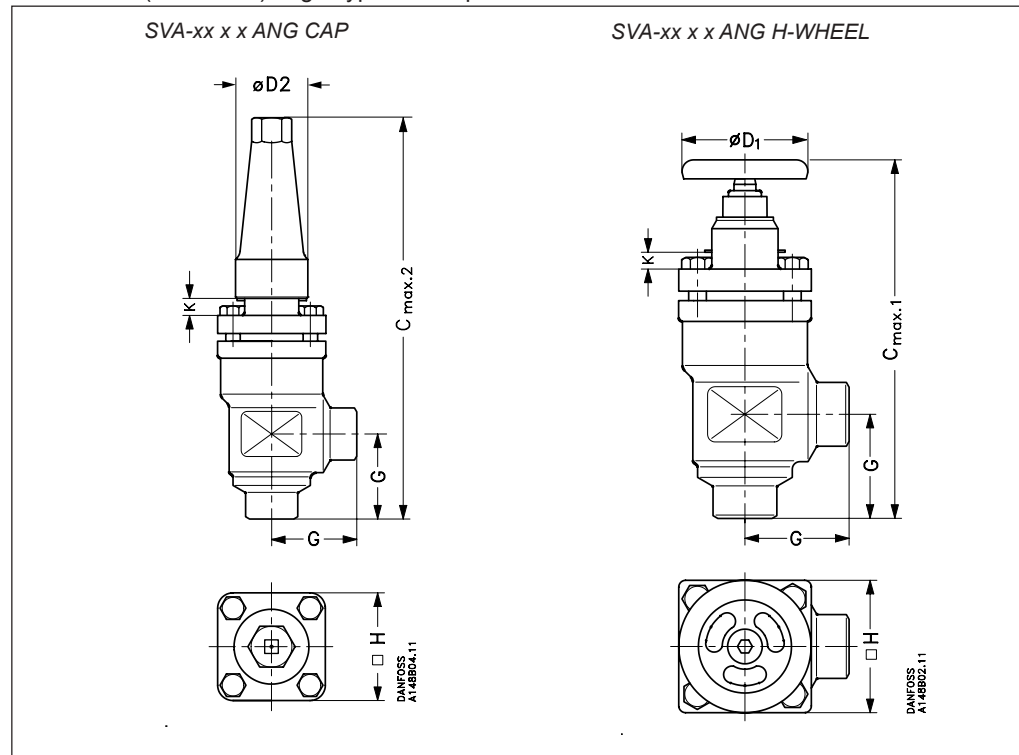

Valve size	K	C <sub>max.1</sub>	C <sub>max.2</sub>	G	ØD <sub>1</sub>	ØD <sub>2</sub>	□H	Weight
<b>SVA-ST, Butt-weld and threaded</b>								
SVA 15 - 20 mm	4	178	189	45	60	38	60	1.4 kg
SVA (1/2 - 3/4) in.	0.16	7.00	7.44	1.77	2.36	1.5	2.36	3.1 lb
SVA 25 - 40 mm	12	234	268	55	80	50	70	2.4 kg
SVA (1 - 1 1/2) in.	0.47	9.21	10.55	2.17	3.15	1.97	2.76	5.3 lb
<b>SVA-ST, Socket weld</b>								
SVA 32 - 40 mm	12	241	275	62	80	50	70	2.9 kg
SVA (1 1/4 - 1 1/2) in.	0.47	9.49	10.83	2.44	3.15	1.97	2.76	6.4 lb
<b>SVA-LT, Butt-weld and threaded</b>								
SVA 15 - 20 mm	63	237	248	45	60	38	60	1.4 kg
SVA (1/2 - 3/4) in.	2.48	9.33	9.76	1.77	2.36	1.5	2.36	3.1 lb
SVA 25 - 40 mm	74	296	330	55	80	50	70	2.4 kg
SVA (1 - 1 1/2) in.	2.91	11.65	12.99	2.17	3.15	1.97	2.76	5.3 lb
<b>SVA-LT, Socket weld</b>								
SVA 32 - 40 mm	74	303	337	62	80	50	70	2.9 kg
SVA (1 1/4 - 1 1/2) in.	2.91	11.93	13.27	2.44	3.15	1.97	2.76	6.4 lb

Specified weights are approximate values only.

## Dimensions and weights

## SVA 15 - 40 (1/2 - 1 1/2 in.) globe type with cap / handwheel

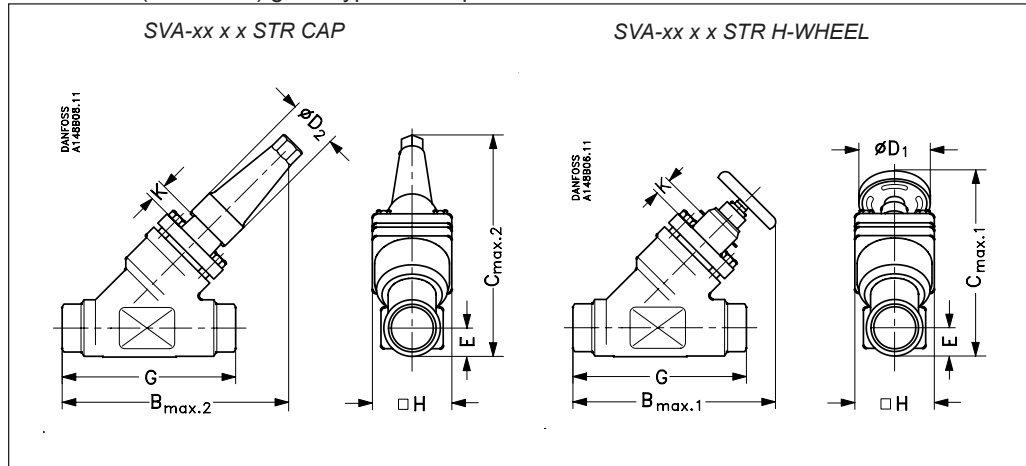

Valve size	K	C <sub>max.1</sub>	C <sub>max.2</sub>	B <sub>max.1</sub>	B <sub>max.2</sub>	E	G	∅D <sub>1</sub>	∅D <sub>2</sub>	□H	Weight
<i>SVA-ST, Butt-weld and threaded</i>											
SVA 15 - 20 mm	4	146	141	160	156	20	120	60	38	60	2.0 kg
SVA (1/2 - 3/4) in.	0.16	5.74	5.55	6.30	6.14	0.79	4.72	2.36	1.50	2.36	4.4 lb
SVA 25 - 40 mm	12	199	208	212	222	26	155	80	50	70	3.0 kg
SVA (1 - 1 1/2) in.	0.47	7.83	8.19	8.35	8.74	1.02	6.10	3.15	1.97	2.76	6.6 lb
<i>SVA-ST, Socket weld</i>											
SVA 32 mm	12	200	209	212	222	27.4	155	80	50	70	3.0 kg
SVA (1 1/4) in.	0.47	7.87	8.23	8.35	8.74	1.08	6.10	3.15	1.97	2.76	6.6 lb
SVA 40 mm	12	204	213	212	222	31.0	155	80	50	70	3.0 kg
SVA (1 1/2) in.	0.47	8.03	8.39	8.35	8.74	1.22	6.10	3.15	1.97	2.76	6.6 lb
<i>SVA-LT, Butt-weld and threaded</i>											
SVA 15 - 20 mm	63	188	184	202	198	20	120	60	38	60	2.0 kg
SVA (1/2 - 3/4) in.	2.48	7.40	7.24	7.95	7.80	0.79	4.72	2.36	1.50	2.36	4.4 lb
SVA 25 - 40 mm	74	243	252	256	265	26	155	80	50	70	3.0 kg
SVA (1 - 1 1/2) in.	2.91	9.57	9.92	10.08	10.43	1.02	6.10	3.15	1.97	2.76	6.6 lb
<i>SVA-LT, Socket weld</i>											
SVA 32 mm	74	244	253	256	265	27.4	155	80	50	70	3.0 kg
SVA (1 1/4) in.	2.91	9.61	9.96	10.08	10.43	1.08	6.10	3.15	1.97	2.76	6.6 lb
SVA 40 mm	74	248	257	256	265	31.0	155	80	50	70	3.0 kg
SVA (1 1/2) in.	2.91	9.76	10.12	10.08	10.43	1.22	6.10	3.15	1.97	2.76	6.6 lb

Specified weights are approximate values only.

## Dimensions and weights

## SVA 50 - 65 (2 - 2 1/2 in.) angle type with cap / handwheel

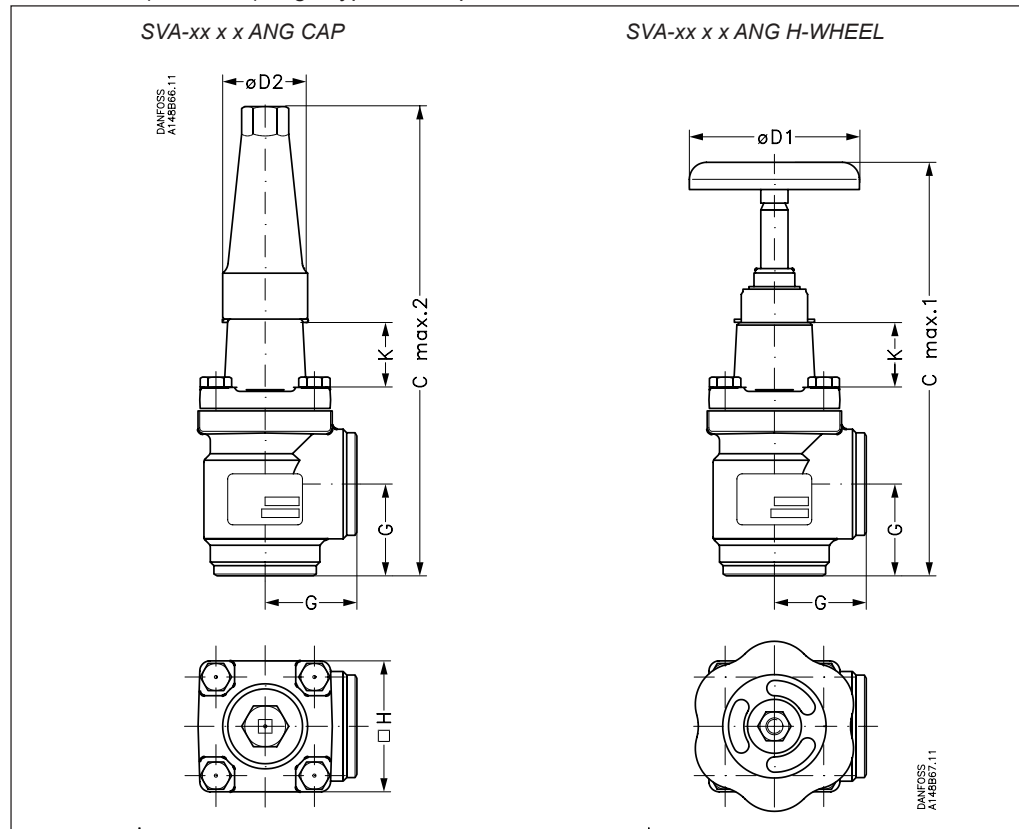

Valve size		K		C <sub>max.1</sub>	C <sub>max.2</sub>	G	∅D <sub>1</sub>	∅D <sub>2</sub>	□H	Weight
<b>SVA-ST, Butt-weld</b>										
SVA 50	mm	35		249	280	60	100	50	77	3.2 kg
SVA (2)	in.	1.38		9.80	11.02	2.36	3.94	1.97	3.03	7.1 lb
SVA 65	mm	40		280	305	70	100	50	90	4.8 kg
SVA (2 1/2)	in.	1.57		11.02	12.01	2.76	3.94	1.97	3.54	10.6 lb
<b>SVA-ST, Socket weld</b>										
SVA 50	mm	35		254	285	65	100	50	77	4.1 kg
SVA (2)	in.	1.38		10.00	11.22	2.56	3.94	1.97	3.03	9.0 lb
<b>SVA-LT, Butt-weld</b>										
SVA 50	mm	70		284	315	60	100	50	77	3.2 kg
SVA (2)	in.	2.76		11.18	12.40	2.36	3.94	1.97	3.03	7.1 lb
SVA 65	mm	70		310	335	70	100	50	90	4.8 kg
SVA (2 1/2)	in.	2.76		12.20	13.19	2.76	3.94	1.97	3.54	10.6 lb
<b>SVA-LT, Socket weld</b>										
SVA 50	mm	70		289	320	65	100	50	77	4.1 kg
SVA (2)	in.	2.76		11.38	12.60	2.56	3.94	1.97	3.03	9.0 lb

Specified weights are approximate values only.

Dimensions and weights SVA 50 - 65 (2 - 2 1/2 in.) globe type with cap / handwheel

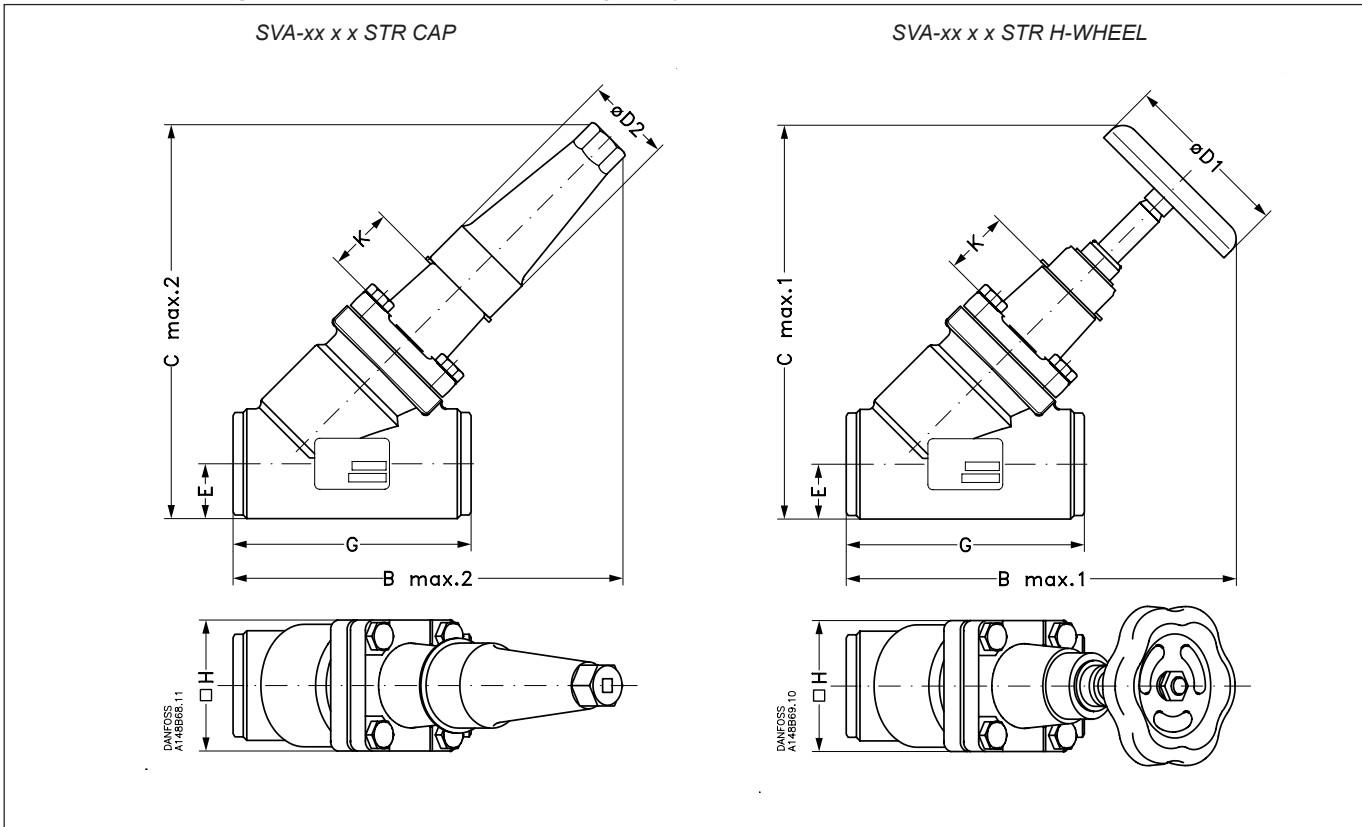

Valve size		K	B <sub>max.1</sub>	B <sub>max.2</sub>	C <sub>max.1</sub>	C <sub>max.2</sub>	E	G	∅D <sub>1</sub>	∅D <sub>2</sub>	□H	Weight
<b>SVA-ST, Butt-weld</b>												
SVA 50	mm	35	234	234	232	232	32	148	100	50	77	4.2 kg
SVA (2)	in.	1.38	9.21	9.21	9.13	9.13	1.26	5.83	3.94	1.97	3.03	9.3 lb
SVA 65	mm	40	262	258	262	258	40	176	100	50	90	6.3 kg
SVA (2 1/2)	in.	1.57	10.31	10.16	10.31	10.16	1.57	6.93	3.94	1.97	3.54	13.9 lb
<b>SVA-ST, Socket weld</b>												
SVA 50	mm	35	241	241	236	236	37	162	100	50	77	5.1 kg
SVA (2)	in.	1.38	9.49	9.49	9.29	9.29	1.46	6.38	3.94	1.97	3.03	11.2 lb
<b>SVA-LT, Butt-weld</b>												
SVA 50	mm	70	259	259	257	257	32	148	100	50	77	4.2 kg
SVA (2)	in.	2.76	10.20	10.20	10.12	10.12	1.26	5.83	3.94	1.97	3.03	9.3 lb
SVA 65	mm	70	284	280	284	280	40	176	100	50	90	6.3 kg
SVA (2 1/2)	in.	2.76	11.18	11.02	11.18	11.02	1.57	6.93	3.94	1.97	3.54	13.9 lb
<b>SVA-LT, Socket weld</b>												
SVA 50	mm	70	266	266	261	261	37	62	100	50	77	5.1 kg
SVA (2)	in.	2.76	10.47	10.47	10.28	10.28	1.26	6.38	3.94	1.97	3.03	11.2 lb

Specified weights are approximate values only.

## Dimensions and weights

## SVA 80 - 200 (3 - 8 in.) angle type with cap / handwheel

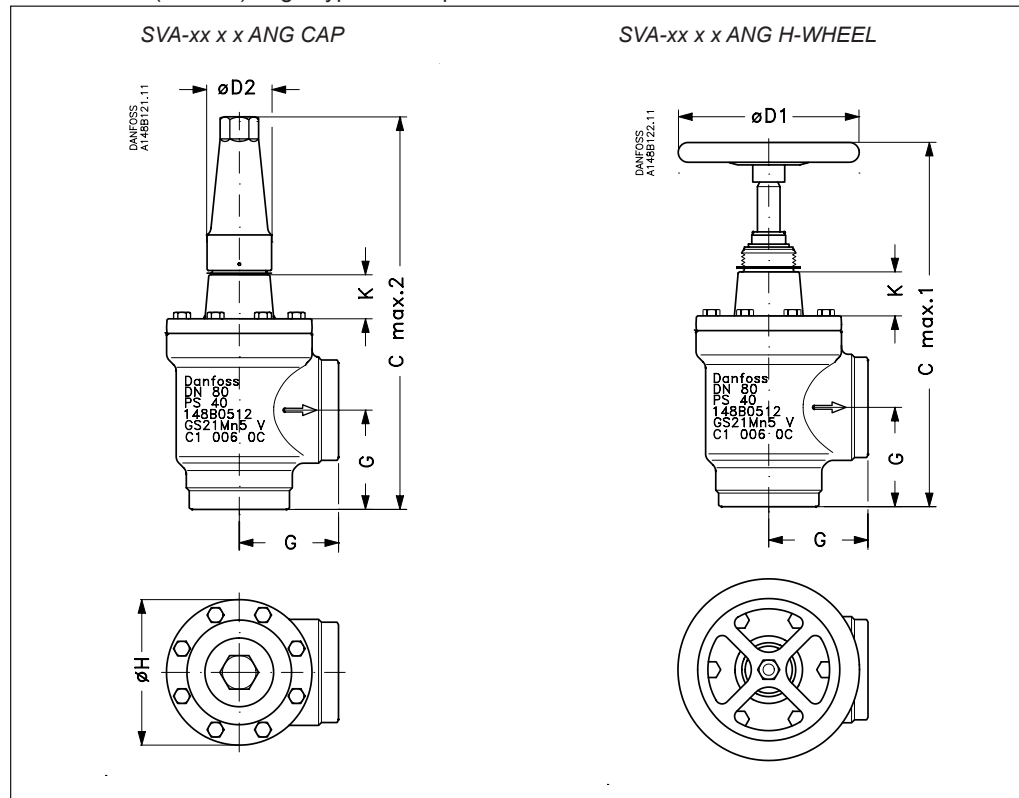

Valve size		K		C <sub>max.1</sub>	C <sub>max.2</sub>	G	ØD <sub>1</sub>	ØD <sub>2</sub>		ØH	Weight
<b>SVA-ST, Butt-weld</b>											
SVA 80	mm	41		338	353	90	200	58		129	9.2 kg
SVA (3)	in.	1.61		13.31	13.90	3.54	7.87	2.28		5.08	20.3 lb
SVA 100	mm	43		382	388	106	250	58		156	14.8 kg
SVA (4)	in.	1.69		15.04	15.28	4.17	9.84	2.28		6.14	32.6 lb
SVA 125	mm	90		517	533	128	315	74		193	28.1 kg
SVA (5)	in.	3.54		20.35	20.98	5.04	12.40	2.91		7.60	61.9 lb
SVA 150	mm	90		564	568	145	315	74		219	39.7 kg
SVA (6)	in.	3.54		22.20	22.36	5.71	12.40	2.91		8.62	87.5 lb
SVA 200	mm	90		675	678	180	400	86		276	79.5 kg
SVA (8)	in.	3.54		26.57	26.69	7.09	15.75	3.39		10.87	175.3 lb
<b>SVA-LT, Butt-weld</b>											
SVA 80	mm	76		373	388	90	200	58		129	9.7 kg
SVA (3)	in.	3.00		14.69	15.28	3.54	7.87	2.28		5.08	21.4 lb
SVA 100	mm	90		432	437	106	250	58		156	15.3 kg
SVA (4)	in.	3.54		17.00	17.20	4.17	9.84	2.28		6.14	33.7 lb
SVA 125	mm	90		517	533	128	315	74		193	28.1 kg
SVA (5)	in.	3.54		20.35	20.98	5.04	12.40	2.91		7.60	61.9 lb
SVA 150	mm	90		564	568	145	315	74		219	39.7 kg
SVA (6)	in.	3.54		22.20	22.36	5.71	12.40	2.91		8.62	87.5 lb
SVA 200	mm	90		675	678	180	400	86		276	79.5 kg
SVA (8)	in.	3.54		26.57	26.69	7.09	15.75	3.39		10.87	175.3 lb

Specified weights are approximate values only.

Dimensions and weights SVA 80 - 200 (3 - 8 in.) globe type with cap / handwheel

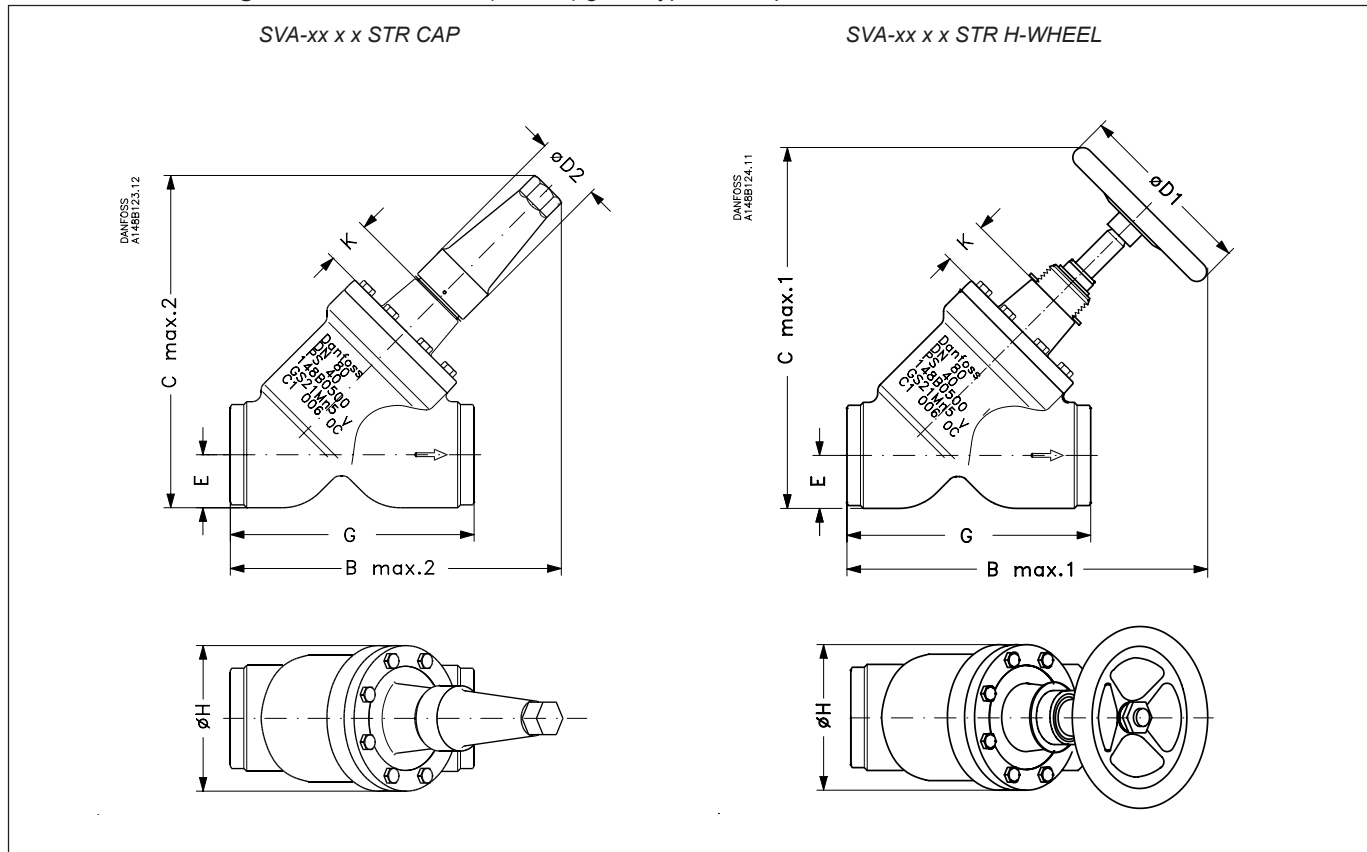

Valve size	K	B <sub>max.1</sub>	B <sub>max.2</sub>	C <sub>max.1</sub>	C <sub>max.2</sub>	E	G	ØD <sub>1</sub>	ØD <sub>2</sub>	ØH	Weight	
<b>SVA-ST, Butt-weld</b>												
SVA 80	mm	41	340	296	342	298	48	216	200	58	129	10.4 kg
SVA (3)	in.	1.61	13.38	11.65	13.46	11.73	1.89	8.50	7.87	2.28	5.08	22.9 lb
SVA 100	mm	43	400	331	408	339	60	264	250	58	156	17.7 kg
SVA (4)	in.	1.69	15.75	13.03	16.06	13.35	2.36	10.39	9.84	2.28	6.14	39.0 lb
SVA 125	mm	90	526	444	538	456	74	322	315	74	193	32.8 kg
SVA (5)	in.	3.54	20.71	17.48	21.18	17.95	2.91	12.68	12.40	2.91	7.60	72.3 lb
SVA 150	mm	90	572	483	594	505	91	370	315	74	219	60.0 kg
SVA (6)	in.	3.54	22.52	19.02	23.39	19.88	3.58	14.57	12.40	2.91	8.62	132.3 lb
SVA 200	mm	90	692	579	726	613	117	464	400	86	276	111.5kg
SVA (8)	in.	3.54	27.24	22.80	28.58	24.13	4.61	18.27	15.75	3.39	10.87	245.8 lb
<b>SVA-LT, Butt-weld</b>												
SVA 80	mm	76	365	321	367	323	48	216	200	58	129	10.9 kg
SVA (3)	in.	3.00	14.37	12.64	14.45	12.72	1.89	8.50	7.87	2.28	5.08	24.0 lb
SVA 100	mm	90	435	367	443	375	60	264	250	58	156	18.2 kg
SVA (4)	in.	3.54	17.13	14.45	17.44	14.76	2.36	10.39	9.84	2.28	6.14	40.1 lb
SVA 125	mm	90	526	444	538	456	74	322	315	74	193	32.8 kg
SVA (5)	in.	3.54	20.71	17.48	21.18	17.95	2.91	12.68	12.40	2.91	7.60	72.3 lb
SVA 150	mm	90	572	483	594	505	91	370	315	74	219	60.0 kg
SVA (6)	in.	3.54	22.52	19.02	23.39	19.88	3.58	14.57	12.40	2.91	8.62	132.3 lb
SVA 200	mm	90	692	579	726	613	117	464	400	86	276	111.5kg
SVA (8)	in.	3.54	27.24	22.80	28.58	24.13	4.61	18.27	15.75	3.39	10.87	245.8 lb

Specified weights are approximate values only.

**Ordering**

Please note that the type codes only serve to identify the valves, some of which may not form part of the standard product range. For further information please contact your local Danfoss Sales Company.

*Type codes*

Valve type	SVA	Stop Valve
Nominal size in mm		Available connections
(valve size measured on the connection diameter)		A/D SOC FPT
	<b>15</b>	DN 15 (1/2)
	<b>20</b>	DN 20 (3/4)
	<b>25</b>	DN 25 (1)
	<b>32</b>	DN 32 (1 1/4)
	<b>40</b>	DN 40 (1 1/2)
	<b>50</b>	DN 50 (2)
	<b>65</b>	DN 65 (2 1/2)
	<b>80</b>	DN 80 (3)
	<b>100</b>	DN 100 (4)
	<b>125</b>	DN 125 (5)
	<b>150</b>	DN 150 (6)
	<b>200</b>	DN 200 (8)
Connections	<b>A</b> <b>D</b> <b>SOC</b> <b>FPT</b>	Butt-weld connection: ANSI B 36.10 schedule 80, DN 15 - 40 (1/2 - 1 1/2 in.) Butt-weld connection: ANSI B 36.10 schedule 40, DN 50 - 200 (2 - 8 in.) Butt-weld connection: DIN 2448 Socket weld: ANSI B 16.11 Female Pipe Thread NPT: ANSI/ASME B 1.20.1
Valve housing	<b>ANG</b> <b>STR</b>	Angle flow Globe flow
Other equipment	<b>H-WHEEL</b> <b>CAP</b>	Handwheel Seal cap

**Important!**

Where products need to be certified according to specific certification societies or where higher pressures are required, the relevant information should be included at the time of order.

**Ordering**  
(cont.)

Example:  
SVA-ST 20, Butt-weld, ANSI,  
angle with handwheel =  
**148B3451**

**Important!**

Where products need to be certified according to specific certification societies or where higher pressures are required, the relevant information should be included at the time of order.

The table below is used to identify the valve required.

Standard version			
Angle			
Size		Type	Code number
mm	in.		
<b>DIN</b>			
15	1/2	SVA-ST 15 D ANG H-WHEEL	148B3361
15	1/2	SVA-ST 15 D ANG CAP	148B3362
20	3/4	SVA-ST 20 D ANG H-WHEEL	148B3441
20	3/4	SVA-ST 20 D ANG CAP	148B3442
25	1	SVA-ST 25 D ANG H-WHEEL	148B3521
25	1	SVA-ST 25 D ANG CAP	148B3522
32	1 1/4	SVA-ST 32 D ANG H-WHEEL	148B3601
32	1 1/4	SVA-ST 32 D ANG CAP	148B3602
40	1 1/2	SVA-ST 40 D ANG H-WHEEL	148B3681
40	1 1/2	SVA-ST 40 D ANG CAP	148B3682
50	2	SVA-ST 50 D ANG H-WHEEL	148B3032
50	2	SVA-ST 50 D ANG CAP	148B3033
65	2 1/2	SVA-ST 65 D ANG H-WHEEL	148B3044
65	2 1/2	SVA-ST 65 D ANG CAP	148B3045
80	3	SVA-ST 80 D ANG H-WHEEL	148B3061
80	3	SVA-ST 80 D ANG CAP	148B3062
100	4	SVA-ST 100 D ANG H-WHEEL	148B3101
100	4	SVA-ST 100 D ANG CAP	148B3102
125	5	SVA-ST 125 D ANG H-WHEEL	148B3141
125	5	SVA-ST 125 D ANG CAP	148B3142
150	6	SVA-ST 150 D ANG H-WHEEL	148B3181
150	6	SVA-ST 150 D ANG CAP	148B3182
200	8	SVA-ST 200 D ANG H-WHEEL	148B3221
200	8	SVA-ST 200 D ANG CAP	148B3222

ANSI			
15	1/2	SVA-ST 15 A ANG H-WHEEL	148B3371
15	1/2	SVA-ST 15 A ANG CAP	148B3372
20	3/4	SVA-ST 20 A ANG H-WHEEL	148B3451
20	3/4	SVA-ST 20 A ANG CAP	148B3452
25	1	SVA-ST 25 A ANG H-WHEEL	148B3531
25	1	SVA-ST 25 A ANG CAP	148B3532
32	1 1/4	SVA-ST 32 A ANG H-WHEEL	148B3611
32	1 1/4	SVA-ST 32 A ANG CAP	148B3612
40	1 1/2	SVA-ST 40 A ANG H-WHEEL	148B3691
40	1 1/2	SVA-ST 40 A ANG CAP	148B3692
50	2	SVA-ST 50 A ANG H-WHEEL	148B3034
50	2	SVA-ST 50 A ANG CAP	148B3035
65	2 1/2	SVA-ST 65 A ANG H-WHEEL	148B3046
65	2 1/2	SVA-ST 65 A ANG CAP	148B3047
80	3	SVA-ST 80 A ANG H-WHEEL	148B3071
80	3	SVA-ST 80 A ANG CAP	148B3072
100	4	SVA-ST 100 A ANG H-WHEEL	148B3111
100	4	SVA-ST 100 A ANG CAP	148B3112
125	5	SVA-ST 125 A ANG H-WHEEL	148B3151
125	5	SVA-ST 125 A ANG CAP	148B3152
150	6	SVA-ST 150 A ANG H-WHEEL	148B3191
150	6	SVA-ST 150 A ANG CAP	148B3192
200	8	SVA-ST 200 A ANG H-WHEEL	148B3231
200	8	SVA-ST 200 A ANG CAP	148B3232

SOC			
15	1/2	SVA-ST 15 SOC ANG H-WHEEL	148B3381
15	1/2	SVA-ST 15 SOC ANG CAP	148B3382
20	3/4	SVA-ST 20 SOC ANG H-WHEEL	148B3461
20	3/4	SVA-ST 20 SOC ANG CAP	148B3462
25	1	SVA-ST 25 SOC ANG H-WHEEL	148B3541
25	1	SVA-ST 25 SOC ANG CAP	148B3542
32	1 1/4	SVA-ST 32 SOC ANG H-WHEEL	148B3621
32	1 1/4	SVA-ST 32 SOC ANG CAP	148B3622
40	1 1/2	SVA-ST 40 SOC ANG H-WHEEL	148B3701
40	1 1/2	SVA-ST 40 SOC ANG CAP	148B3702
50	2	SVA-ST 50 SOC ANG H-WHEEL	148B3036
50	2	SVA-ST 50 SOC ANG CAP	148B3037

FPT			
15	1/2	SVA-ST 15 FPT ANG H-WHEEL	148B3391
15	1/2	SVA-ST 15 FPT ANG CAP	148B3392
20	3/4	SVA-ST 20 FPT ANG H-WHEEL	148B3471
20	3/4	SVA-ST 20 FPT ANG CAP	148B3472
25	1	SVA-ST 25 FPT ANG H-WHEEL	148B3551
25	1	SVA-ST 25 FPT ANG CAP	148B3552
32	1 1/4	SVA-ST 32 FPT ANG H-WHEEL	148B3631
32	1 1/4	SVA-ST 32 FPT ANG CAP	148B3632

Standard version			
Globe			
Size		Type	Code number
mm	in.		
<b>DIN</b>			
15	1/2	SVA-ST 15 D STR H-WHEEL	148B3401
15	1/2	SVA-ST 15 D STR CAP	148B3402
20	3/4	SVA-ST 20 D STR H-WHEEL	148B3481
20	3/4	SVA-ST 20 D STR CAP	148B3482
25	1	SVA-ST 25 D STR H-WHEEL	148B3561
25	1	SVA-ST 25 D STR CAP	148B3562
32	1 1/4	SVA-ST 32 D STR H-WHEEL	148B3641
32	1 1/4	SVA-ST 32 D STR CAP	148B3642
40	1 1/2	SVA-ST 40 D STR H-WHEEL	148B3711
40	1 1/2	SVA-ST 40 D STR CAP	148B3712
50	2	SVA-ST 50 D STR H-WHEEL	148B3038
50	2	SVA-ST 50 D STR CAP	148B3039
65	2 1/2	SVA-ST 65 D STR H-WHEEL	148B3050
65	2 1/2	SVA-ST 65 D STR CAP	148B3051
80	3	SVA-ST 80 D STR H-WHEEL	148B3081
80	3	SVA-ST 80 D STR CAP	148B3082
100	4	SVA-ST 100 D STR H-WHEEL	148B3121
100	4	SVA-ST 100 D STR CAP	148B3122
125	5	SVA-ST 125 D STR H-WHEEL	148B3161
125	5	SVA-ST 125 D STR CAP	148B3162
150	6	SVA-ST 150 D STR H-WHEEL	148B3201
150	6	SVA-ST 150 D STR CAP	148B3202
200	8	SVA-ST 200 D STR H-WHEEL	148B3241
200	8	SVA-ST 200 D STR CAP	148B3242

ANSI			
15	1/2	SVA-ST 15 A STR H-WHEEL	148B3411
15	1/2	SVA-ST 15 A STR CAP	148B3412
20	3/4	SVA-ST 20 A STR H-WHEEL	148B3491
20	3/4	SVA-ST 20 A STR CAP	148B3492
25	1	SVA-ST 25 A STR H-WHEEL	148B3571
25	1	SVA-ST 25 A STR CAP	148B3572
32	1 1/4	SVA-ST 32 A STR H-WHEEL	148B3651
32	1 1/4	SVA-ST 32 A STR CAP	148B3652
40	1 1/2	SVA-ST 40 A STR H-WHEEL	148B3721
40	1 1/2	SVA-ST 40 A STR CAP	148B3722
50	2	SVA-ST 50 A STR H-WHEEL	148B3040
50	2	SVA-ST 50 A STR CAP	148B3041
65	2 1/2	SVA-ST 65 A STR H-WHEEL	148B3052
65	2 1/2	SVA-ST 65 A STR CAP	148B3053
80	3	SVA-ST 80 A STR H-WHEEL	148B3091
80	3	SVA-ST 80 A STR CAP	148B3092
100	4	SVA-ST 100 A STR H-WHEEL	148B3131
100	4	SVA-ST 100 A STR CAP	148B3132
125	5	SVA-ST 125 A STR H-WHEEL	148B3171
125	5	SVA-ST 125 A STR CAP	148B3172
150	6	SVA-ST 150 A STR H-WHEEL	148B3211
150	6	SVA-ST 150 A STR CAP	148B3212
200	8	SVA-ST 200 A STR H-WHEEL	148B3251
200	8	SVA-ST 200 A STR CAP	148B3252

SOC			
15	1/2	SVA-ST 15 SOC STR H-WHEEL	148B3421
15	1/2	SVA-ST 15 SOC STR CAP	148B3422
20	3/4	SVA-ST 20 SOC STR H-WHEEL	148B3501
20	3/4	SVA-ST 20 SOC STR CAP	148B3502
25	1	SVA-ST 25 SOC STR H-WHEEL	148B3581
25	1	SVA-ST 25 SOC STR CAP	148B3582
32	1 1/4	SVA-ST 32 SOC STR H-WHEEL	148B3661
32	1 1/4	SVA-ST 32 SOC STR CAP	148B3662
40	1 1/2	SVA-ST 40 SOC STR H-WHEEL	148B3731
40	1 1/2	SVA-ST 40 SOC STR CAP	148B3732
50	2	SVA-ST 50 SOC STR H-WHEEL	148B3042
50	2	SVA-ST 50 SOC STR CAP	148B3043

FPT			
15	1/2	SVA-ST 15 FPT STR H-WHEEL	148B3431
15	1/2	SVA-ST 15 FPT STR CAP	148B3432
20	3/4	SVA-ST 20 FPT STR H-WHEEL	148B3511
20	3/4	SVA-ST 20 FPT STR CAP	148B3512
25	1	SVA-ST 25 FPT STR H-WHEEL	148B3591
25	1	SVA-ST 25 FPT STR CAP	148B3592
32	1 1/4	SVA-ST 32 FPT STR H-WHEEL	148B3671
32	1 1/4	SVA-ST 32 FPT STR CAP	148B3672

D = Butt-weld DIN  
A = Butt-weld ANSI  
SOC = Socket welding  
FPT = Inside pipe thread

ANG = Angle  
STR = Globe

CAP = Seal cap  
H-WHEEL = Hand wheel

**Ordering**  
(cont.)

Example:  
SVA-LT 20, Butt-weld, ANSI,  
angle with cap = **148B3455**

**Important!**

Where products need to be certified according to specific certification societies or where higher pressures are required, the relevant information should be included at the time of order.

The table below is used to identify the valve required.

Low temperature version			
Angle			
Size		Type	Code number
mm	in.		

DIN			
15	1/2	SVA-LT 15 D ANG H-WHEEL	148B3364
15	1/2	SVA-LT 15 D ANG CAP	148B3365
20	3/4	SVA-LT 20 D ANG H-WHEEL	148B3444
20	3/4	SVA-LT 20 D ANG CAP	148B3445
25	1	SVA-LT 25 D ANG H-WHEEL	148B3524
25	1	SVA-LT 25 D ANG CAP	148B3525
32	1 1/4	SVA-LT 32 D ANG H-WHEEL	148B3604
32	1 1/4	SVA-LT 32 D ANG CAP	148B3605
40	1 1/2	SVA-LT 40 D ANG H-WHEEL	148B3684
40	1 1/2	SVA-LT 40 D ANG CAP	148B3685
50	2	SVA-LT 50 D ANG H-WHEEL	148B3264
50	2	SVA-LT 50 D ANG CAP	148B3265
65	2 1/2	SVA-LT 65 D ANG H-WHEEL	148B3324
65	2 1/2	SVA-LT 65 D ANG CAP	148B3325
80	3	SVA-LT 80 D ANG H-WHEEL	148B3064
80	3	SVA-LT 80 D ANG CAP	148B3065
100	4	SVA-LT 100 D ANG H-WHEEL	148B3104
100	4	SVA-LT 100 D ANG CAP	148B3105
125	5	SVA-LT 125 D ANG H-WHEEL	148B3144
125	5	SVA-LT 125 D ANG CAP	148B3145
150	6	SVA-LT 150 D ANG H-WHEEL	148B3184
150	6	SVA-LT 150 D ANG CAP	148B3185
200	8	SVA-LT 200 D ANG H-WHEEL	148B3224
200	8	SVA-LT 200 D ANG CAP	148B3225

ANSI			
15	1/2	SVA-LT 15 A ANG H-WHEEL	148B3374
15	1/2	SVA-LT 15 A ANG CAP	148B3375
20	3/4	SVA-LT 20 A ANG H-WHEEL	148B3454
20	3/4	SVA-LT 20 A ANG CAP	148B3455
25	1	SVA-LT 25 A ANG H-WHEEL	148B3534
25	1	SVA-LT 25 A ANG CAP	148B3535
32	1 1/4	SVA-LT 32 A ANG H-WHEEL	148B3614
32	1 1/4	SVA-LT 32 A ANG CAP	148B3615
40	1 1/2	SVA-LT 40 A ANG H-WHEEL	148B3694
40	1 1/2	SVA-LT 40 A ANG CAP	148B3695
50	2	SVA-LT 50 A ANG H-WHEEL	148B3274
50	2	SVA-LT 50 A ANG CAP	148B3275
65	2 1/2	SVA-LT 65 A ANG H-WHEEL	148B3334
65	2 1/2	SVA-LT 65 A ANG CAP	148B3335
80	3	SVA-LT 80 A ANG H-WHEEL	148B3074
80	3	SVA-LT 80 A ANG CAP	148B3075
100	4	SVA-LT 100 A ANG H-WHEEL	148B3114
100	4	SVA-LT 100 A ANG CAP	148B3115
125	5	SVA-LT 125 A ANG H-WHEEL	148B3154
125	5	SVA-LT 125 A ANG CAP	148B3155
150	6	SVA-LT 150 A ANG H-WHEEL	148B3194
150	6	SVA-LT 150 A ANG CAP	148B3195
200	8	SVA-LT 200 A ANG H-WHEEL	148B3234
200	8	SVA-LT 200 A ANG CAP	148B3235

SOC			
15	1/2	SVA-LT 15 SOC ANG H-WHEEL	148B3384
15	1/2	SVA-LT 15 SOC ANG CAP	148B3385
20	3/4	SVA-LT 20 SOC ANG H-WHEEL	148B3464
20	3/4	SVA-LT 20 SOC ANG CAP	148B3465
25	1	SVA-LT 25 SOC ANG H-WHEEL	148B3544
25	1	SVA-LT 25 SOC ANG CAP	148B3545
32	1 1/4	SVA-LT 32 SOC ANG H-WHEEL	148B3624
32	1 1/4	SVA-LT 32 SOC ANG CAP	148B3625
40	1 1/2	SVA-LT 40 SOC ANG H-WHEEL	148B3704
40	1 1/2	SVA-LT 40 SOC ANG CAP	148B3705
50	2	SVA-LT 50 SOC ANG H-WHEEL	148B3284
50	2	SVA-LT 50 SOC ANG CAP	148B3285

FPT			
15	1/2	SVA-LT 15 FPT ANG H-WHEEL	148B3394
15	1/2	SVA-LT 15 FPT ANG CAP	148B3395
20	3/4	SVA-LT 20 FPT ANG H-WHEEL	148B3474
20	3/4	SVA-LT 20 FPT ANG CAP	148B3475
25	1	SVA-LT 25 FPT ANG H-WHEEL	148B3554
25	1	SVA-LT 25 FPT ANG CAP	148B3555
32	1 1/4	SVA-LT 32 FPT ANG H-WHEEL	148B3634
32	1 1/4	SVA-LT 32 FPT ANG CAP	148B3635

Low temperature version			
Globe			
Size		Type	Code number
mm	in.		

DIN			
15	1/2	SVA-LT 15 D STR H-WHEEL	148B3404
15	1/2	SVA-LT 15 D STR CAP	148B3405
20	3/4	SVA-LT 20 D STR H-WHEEL	148B3484
20	3/4	SVA-LT 20 D STR CAP	148B3485
25	1	SVA-LT 25 D STR H-WHEEL	148B3564
25	1	SVA-LT 25 D STR CAP	148B3565
32	1 1/4	SVA-LT 32 D STR H-WHEEL	148B3644
32	1 1/4	SVA-LT 32 D STR CAP	148B3645
40	1 1/2	SVA-LT 40 D STR H-WHEEL	148B3714
40	1 1/2	SVA-LT 40 D STR CAP	148B3715
50	2	SVA-LT 50 D STR H-WHEEL	148B3294
50	2	SVA-LT 50 D STR CAP	148B3295
65	2 1/2	SVA-LT 65 D STR H-WHEEL	148B3344
65	2 1/2	SVA-LT 65 D STR CAP	148B3345
80	3	SVA-LT 80 D STR H-WHEEL	148B3084
80	3	SVA-LT 80 D STR CAP	148B3085
100	4	SVA-LT 100 D STR H-WHEEL	148B3124
100	4	SVA-LT 100 D STR CAP	148B3125
125	5	SVA-LT 125 D STR H-WHEEL	148B3164
125	5	SVA-LT 125 D STR CAP	148B3165
150	6	SVA-LT 150 D STR H-WHEEL	148B3204
150	6	SVA-LT 150 D STR CAP	148B3205
200	8	SVA-LT 200 D STR H-WHEEL	148B3244
200	8	SVA-LT 200 D STR CAP	148B3245

ANSI			
15	1/2	SVA-LT 15 A STR H-WHEEL	148B3414
15	1/2	SVA-LT 15 A STR CAP	148B3415
20	3/4	SVA-LT 20 A STR H-WHEEL	148B3494
20	3/4	SVA-LT 20 A STR CAP	148B3495
25	1	SVA-LT 25 A STR H-WHEEL	148B3574
25	1	SVA-LT 25 A STR CAP	148B3575
32	1 1/4	SVA-LT 32 A STR H-WHEEL	148B3654
32	1 1/4	SVA-LT 32 A STR CAP	148B3655
40	1 1/2	SVA-LT 40 A STR H-WHEEL	148B3724
40	1 1/2	SVA-LT 40 A STR CAP	148B3725
50	2	SVA-LT 50 A STR H-WHEEL	148B3304
50	2	SVA-LT 50 A STR CAP	148B3305
65	2 1/2	SVA-LT 65 A STR H-WHEEL	148B3354
65	2 1/2	SVA-LT 65 A STR CAP	148B3355
80	3	SVA-LT 80 A STR H-WHEEL	148B3094
80	3	SVA-LT 80 A STR CAP	148B3095
100	4	SVA-LT 100 A STR H-WHEEL	148B3134
100	4	SVA-LT 100 A STR CAP	148B3135
125	5	SVA-LT 125 A STR H-WHEEL	148B3174
125	5	SVA-LT 125 A STR CAP	148B3175
150	6	SVA-LT 150 A STR H-WHEEL	148B3214
150	6	SVA-LT 150 A STR CAP	148B3215
200	8	SVA-LT 200 A STR H-WHEEL	148B3254
200	8	SVA-LT 200 A STR CAP	148B3255

SOC			
15	1/2	SVA-LT 15 SOC STR H-WHEEL	148B3424
15	1/2	SVA-LT 15 SOC STR CAP	148B3425
20	3/4	SVA-LT 20 SOC STR H-WHEEL	148B3504
20	3/4	SVA-LT 20 SOC STR CAP	148B3505
25	1	SVA-LT 25 SOC STR H-WHEEL	148B3584
25	1	SVA-LT 25 SOC STR CAP	148B3585
32	1 1/4	SVA-LT 32 SOC STR H-WHEEL	148B3664
32	1 1/4	SVA-LT 32 SOC STR CAP	148B3665
40	1 1/2	SVA-LT 40 SOC STR H-WHEEL	148B3734
40	1 1/2	SVA-LT 40 SOC STR CAP	148B3735
50	2	SVA-LT 50 SOC STR H-WHEEL	148B3314
50	2	SVA-LT 50 SOC STR CAP	148B3315

FPT			
15	1/2	SVA-LT 15 FPT STR H-WHEEL	148B3434
15	1/2	SVA-LT 15 FPT STR CAP	148B3435
20	3/4	SVA-LT 20 FPT STR H-WHEEL	148B3514
20	3/4	SVA-LT 20 FPT STR CAP	148B3515
25	1	SVA-LT 25 FPT STR H-WHEEL	148B3594
25	1	SVA-LT 25 FPT STR CAP	148B3595
32	1 1/4	SVA-LT 32 FPT STR H-WHEEL	148B3674
32	1 1/4	SVA-LT 32 FPT STR CAP	148B3675

D = Butt-weld DIN  
A = Butt-weld ANSI  
SOC = Socket welding  
FPT = Inside pipe thread

ANG = Angle  
STR = Globe

CAP = Seal cap  
H-WHEEL = Hand wheel





---

Danfoss can accept no responsibility for possible errors in catalogues, brochures and other printed material. Danfoss reserves the right to alter its products without notice. This also applies to products already on order provided that such alterations can be made without subsequential changes being necessary in specifications already agreed. All trademarks in this material are property of the respective companies. Danfoss and the Danfoss logotype are trademarks of Danfoss A/S. All rights reserved.

---



DK-6430 Nordborg  
Denmark