

THROUGH-THE-TUBE PLUGGING™ WITH CPI / PERMA PLUGS

CPI / Perma Plugs are part of the Pop-A-Plug® Tube Plugging System. Unlike other tube plug designs, and under the proper conditions, CPI / Perma Plugs can be passed through the length of a straight heat exchanger tube and successfully installed at the far end of the tube without having direct access to both tube ends. This procedure outlines the information required to evaluating a heat exchanger for the Through-the-Tube plugging procedure, the limitations of the technique, and the installation process.

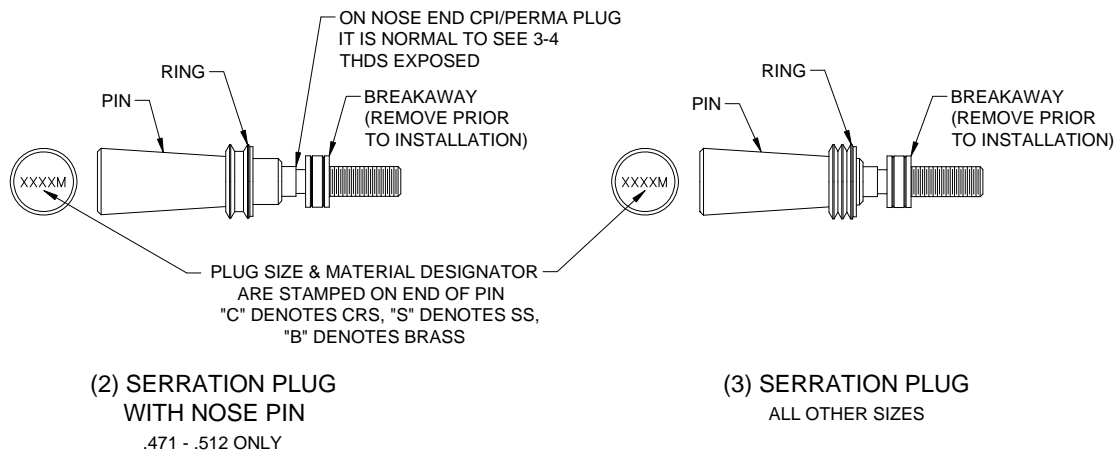

WARNING! SUCCESSFULLY INSTALLING CPI / PERMA PLUGS BY PASSING THEM THROUGH-THE-TUBE REQUIRES THAT THE OPERATOR CAREFULLY FOLLOW THIS PROCEDURE. THE OPERATOR SHOULD BECOME FAMILIAR WITH THIS PLUGGING PROCEDURE AND POSSESS A CLEAR UNDERSTANDING OF HOW TO INSTALL CPI / PERMA PLUGS AT THE NEAR END BEFORE ATTEMPTING THROUGH-THE-TUBE PLUGGING.

EVALUATING THE APPLICATION - INFORMATION REQUIRED:

1. **Tube Size.**

What is the actual tube ID?

2. **The tube-to-tubesheet connection.**

Is the tube-to-sheet connection expanded, welded, or both? If the tube is expanded the length of the expanded area is required to determine the position where the plug will be installed within the tube. **CPI / PERMA PLUGS MUST NEVER BE INSTALLED IN THE TRANSITION ZONE BETWEEN EXPANDED AND UNEXPANDED AREA OF THE TUBE.** If the tube is seal welded to the tubesheet then the weld material at the near tube end will need to be removed by lightly reaming with a tapered reamer.



EST Group
2701 Township Line Rd
Hatfield, PA 19440-1770 USA
(P) 215.721.1100
800.355.7044
(F) 215.721.1101
est-info@curtisswright.com
<http://estgroup.cwfc.com>

Europe / Middle East / Africa
EST Group B.V.
Hoon 312a
2404 HL Alphen aan den Rijn
The Netherlands
(P) +31.172.418841
(F) +31.172.418849
est-emea@curtisswright.com

Asia
EST Group Asia
35 Tannery Rd, #11-10 Tannery Block
Ruby Industrial Complex
Singapore 247740
(P) +65.6745.8560
(F) +65.6742.8700
est-asia@curtisswright.com

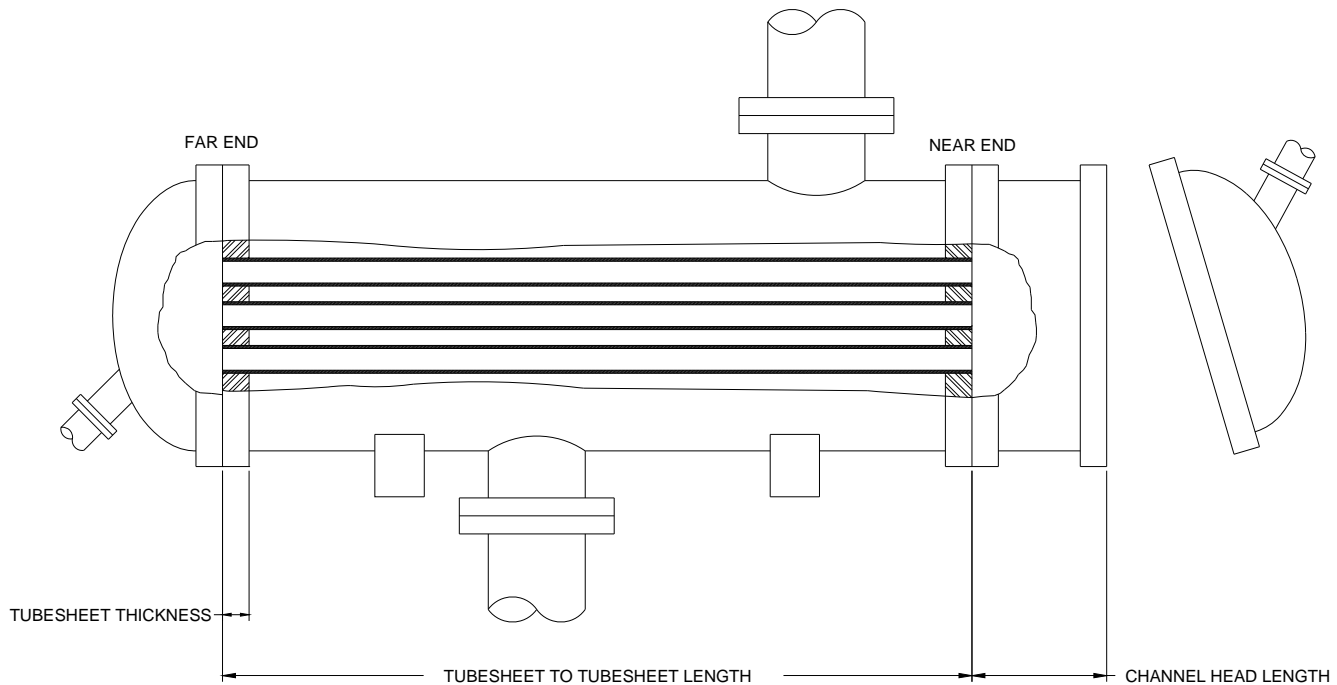
FIGURE 2. Simplified View of a Straight Tube Heat Exchanger**3. Tubesheet-to-tubesheet length.**

What is the distance from the outer face of the near tubesheet to the outer face of the far tubesheet?

4. Tubesheet Thickness.

What is the thickness of the far end tubesheet?

5. Heat Exchanger Channel.

Is there a channel head present at the near end? If so, what is the length of the channel head?

6. Existing Obstructions

Are there any obstructions (division plates, stud bolts, limited clearance overhead, etc.) that may interfere with any of the Pop-A-Plug System equipment? Do any of the obstructions require that the Pull Rod and Tube sections be a specific length?

LIMITATIONS OF THIS TECHNIQUE

While the Through-the-Tube plugging technique has proven to be both effective and reliable means for plugging tubes, several external factors can limit its success. These factors should be recognized and understood prior to starting.

- 1. Condition of the Tubes.** The tubes to be plugged must be clean and free of any deposits. Deposits within the tubes can prevent the proper plug size from fitting through the tube to the far end of the heat exchanger. EST recommends hydroblasting and / or the use of aggressive tube cleaning brushes to clean the tubes. Some deposits may require chemical cleaning. Hard deposits that cannot be removed by hydroblasting, brushing, or chemical cleaning may require either drilling or rodding.



EST Group
2701 Township Line Rd
Hatfield, PA 19440-1770 USA
(P) 215.721.1100
800.355.7044
(F) 215.721.1101
est-info@curtisswright.com
http://estgroup.cwfc.com

Europe / Middle East / Africa
EST Group B.V.
Hoon 312a
2404 HL Alphen aan den Rijn
The Netherlands
(P) +31.172.418841
(F) +31.172.418849
est-emea@curtisswright.com

Asia
EST Group Asia
35 Tannery Rd, #11-10 Tannery Block
Ruby Industrial Complex
Singapore 247740
(P) +65.6745.8560
(F) +65.6742.8700
est-asia@curtisswright.com

2. **Damaged Tubes.** Tubes that are extremely bowed, bent, or have failed as a result of tube denting, implosion or other tube ID altering factor may not allow the plug to be passed through the tube to the far end.

PRIOR TO PLUGGING

1. Clean the tube(s) thoroughly.
2. If the service of the heat exchanger permits, pierce the wall of the tube(s) in a location just beyond the tubesheet. The puncture should be cleanly through the tube wall.

DETERMINING THE PROPER CPI / PERMA PLUG SIZE

CPI / Perma Plugs and plug installation equipment will be selected based upon the tube ID. Actual tube measurements are best. Ideally the measurements should be taken at two locations, 90 degrees apart, at a point about 1" (25.4 mm) deep within the tube end. Further a number of tubes in both the inlet and outlet pass should be measured. If actual tube measurements are not available then the tube data (tube OD and wall thickness, or gage) may be obtained from the heat exchanger data sheet provided by the manufacturer. The tube data and the sizing guide shown in Appendix 1 may be used to determine the suggested CPI / Perma Plug size. **Note: A careful evaluation of the repair history for the heat exchanger is also advised. If the tube bundle and/or tubes have been replaced, the actual tube size may vary considerably from the tube size indicated on the heat exchanger datasheet.**

CALCULATE INSTALLATION DEPTH FOR FAR END PLUG

The CPI/Perma Plug must be installed into the tubesheet area of the tube only. EST recommends that the plug be positioned in the middle of the rolled area of the far end tube or the middle of the tubesheet if the tube is not rolled. To determine the proper **Installation Depth** subtract one half of the far end tube roll length from the tubesheet to tubesheet length. Refer to Figure 2.

Example: Tubesheet face to tubesheet face = 10 ft. = 120 in.
Far end tube roll length or Tubesheet thickness if unrolled = 4"
Installation depth = 120" - [1/2 x 4"] = 118"
In this case the Installation Depth would be equal to 118"

REQUIRED INSTALLATION EQUIPMENT

CPI / Perma Plug installation hardware is dedicated to specific CPI / Perma Plug size(s) only. The following equipment is required:

1. A sufficient supply of CPI / Perma Plugs in the proper size and plug material.
2. Through-The-Tube Thread Adapter Kit(s) for the indicated plug size(s). Refer to the section titled Through-The-Tube Adapter Kit for more information on the Adapter Kits.
3. A Pop-A-Plug System Ram Package. Based on the plug size and material select either the Small Ram, Part Number PAP-6600, or Large Ram Package, Part Number PAP-1750. **Note: V-1334 plug sizes and larger must be installed using the Large Ram.**
4. Air Regulator Assembly, Part Number REG-TTT.



EST Group
2701 Township Line Rd
Hatfield, PA 19440-1770 USA
(P) 215.721.1100
800.355.7044
(F) 215.721.1101
est-info@curtisswright.com
http://estgroup.cwfc.com

Europe / Middle East / Africa
EST Group B.V.
Hoon 312a
2404 HL Alphen aan den Rijn
The Netherlands
(P) +31.172.418841
(F) +31.172.418849
est-emea@curtisswright.com

Asia
EST Group Asia
35 Tannery Rd, #11-10 Tannery Block
Ruby Industrial Complex
Singapore 247740
(P) +65.6745.8560
(F) +65.6742.8700
est-asia@curtisswright.com

5. A sufficient supply of Pull Rod and Tube Extensions to allow the CPI / Perma Plug to be positioned at the far end of the heat exchanger.
6. Additional Pop-A-Plug installation hardware is suggested as spares.
 - 6.1. 1 additional Plug Positioner for each CPI / Perma Plug size.
 - 6.2. 1 additional Channel Head Pull Rod Assembly (4 ft. or 6 ft.)
7. (2) small pipe wrenches (6" or smaller) or (2) pair of Vise Grips.
8. 30' tape measure.

ASSEMBLY OF HYDRAULIC EQUIPMENT:

Installation of CPI / Perma Plugs at the far end of the heat exchanger requires that the Hydraulic Pump be operated to the installation pressure specified for the individual plug size and material. The pulling pressures will also vary by the hydraulic ram used during installation. Installation pressures are shown in either Table 1, for installations with the Small Ram, and Table 2, for installations with the Large Ram. Use of the Air Regular Assembly, Part Number REG-TTT, is mandatory.

1. Connect the Air Regulator assembly to the air input connection on the Hydraulic Pump, refer to Figure 3 below.
2. Connect the air supply to the Air Regulator input and set regulator to produce the proper hydraulic pressure by performing the following steps.
 - a. Disconnect any items connected to the Hydraulic Pump output.
 - b. Turn the Air Regulator adjustment knob fully counterclockwise.
 - c. Depress the Hydraulic Pump pedal while viewing the pressure gauge. While keeping pump pedal depressed, slowly adjust the Air Regulator knob clockwise to activate the pump. Continue operating the pump until the proper hydraulic pressure required for the CPI / Perma plug size and material is achieved. Refer to Table 1 for plug installations using the Small Ram, or Table 2 for installations using the Large Ram.

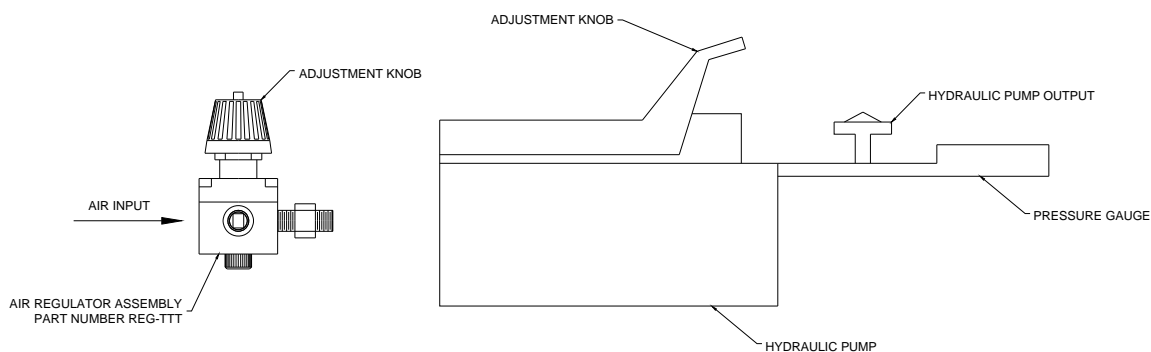

FIGURE 3. Air Regulator Assembly And Hydraulic Pump

- d. Depress the release end of the Hydraulic Pump pedal to release the built-up pressure. Repressurize the Pump to verify that the proper hydraulic pressure has been set. Adjust Air Regulator as necessary. Release pressure.
- e. Connect one end of the hydraulic hose to the Pump output. The other end of the hose is to be connected to the Hydraulic Ram. Verify that all quick connects are fully tightened. The ram is now ready for use.

THROUGH-THE-TUBE ADAPTER KIT

The Through-The-Tube Adapter Kit includes a Through-The-Tube Adapter and a supply of Through-The-Tube Studs as shown in Figure 4. The Through-The-Tube (TTT) Adapter has a right hand male thread on one end and left-hand female thread on the other. The TTT Studs are threaded with both left and right hand threads. TTT Adapter Kits are plug size specific and are to be used in through-the-tube plugging applications in place of the breakaway supplied with the CPI / Perma Plugs. The applicable Adapter Kits for given plug sizes are shown in Tables 1 and 2. Adapter Kits should be installed as outlined in the following section.

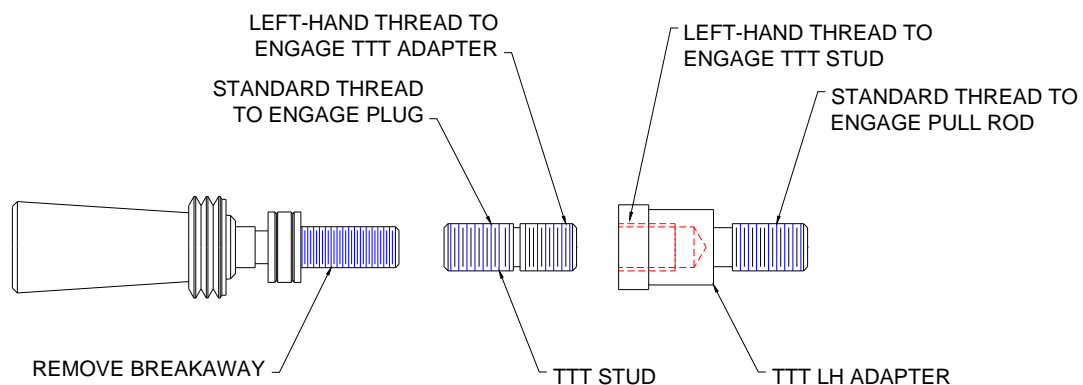

FIGURE 4. Through-The-Tube Adapter Kit and CPI / Perma Plug

PULL ROD ASSEMBLY FOR THROUGH THE TUBE PLUGGING, See Figure 5.

The Pull Rod sections need to be assembled to achieve the desired length. The overall suggested length is approximately equal to the heat exchanger tubesheet to tubesheet length plus the length of the channel head (if applicable).

NOTE: Pull Rod Extensions are shipped from the factory with the Pull Rods inside the Compression Tube. To speed the assembly process of the Pull Rod Extensions remove all Pull Rods from the mating Compression Tubes prior to continuing. The Pull Rods should be assembled on the ground to minimize bending. If space is limited, the Pull Rod Extensions can be assembled piece by piece in the heat exchanger tube to be plugged.

1. Remove breakaway from the CPI/Perma Plug to be installed through the tube. Note: Do not grip or in any way mar the surface of the tapered pin when unscrewing the breakaway. Discard the breakaway once removed.
2. Thread the right hand threaded end of the TTT Stud clockwise into the plug.



EST Group
2701 Township Line Rd
Hatfield, PA 19440-1770 USA
(P) 215.721.1100
800.355.7044
(F) 215.721.1101
est-info@curtisswright.com
http://estgroup.cwfc.com

Europe / Middle East / Africa
EST Group B.V.
Hoon 312a
2404 HL Alphen aan den Rijn
The Netherlands
(P) +31.172.418841
(F) +31.172.418849
est-emea@curtisswright.com

Asia
EST Group Asia
35 Tannery Rd, #11-10 Tannery Block
Ruby Industrial Complex
Singapore 247740
(P) +65.6745.8560
(F) +65.6742.8700
est-asia@curtisswright.com

3. Holding the plug thread it into the female left hand thread of the TTT Adapter until fully engaged. **NOTE: Do not re-tighten after contact or plug / adapter kit assembly may unthread. The pulling stud will remain with the plug after installation. DO NOT USE A THREAD LOCKING AGENT.**
4. Thread a TTT Adapter into the end of the first Extension Rod and tighten by hand.

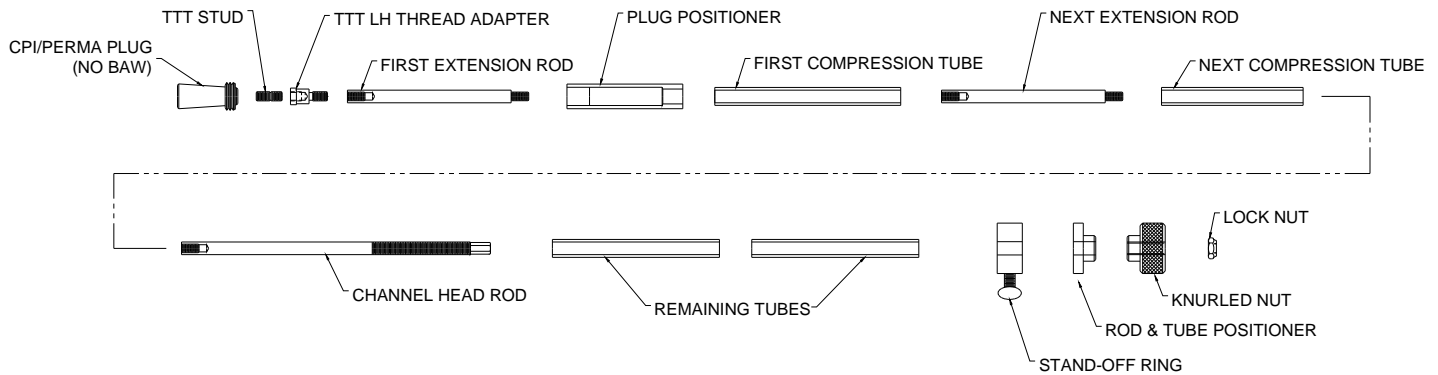

FIGURE 5. Pull Rod Assembly Set-up

WARNING! DURING THESE INSTALLATION PROCEDURES CARE MUST BE EXERCISED SO THAT THE EXTENSION RODS DO NOT ROTATE DURING TIGHTENING OR LOOSENING OF OTHER CONNECTIONS. FAILURE TO HEED THIS WARNING MAY RESULT IN THE THRU-THE-TUBE ADAPTOR PREMATURELY DISENGAGING FROM THE PLUG.

5. Install the Plug Positioner, with arrow pointing toward plug, onto the first Extension Rod. The Plug Positioner should be installed so it rests against the plug.
6. Install the 6-inch long Tube, supplied as part of the Channel Head Assembly, onto the first Extension Rod so it is against the back of the Plug Positioner.
7. Thread the next Extension Rod onto the previous Extension Rod and firmly hand tighten. Keep both Rods straight to make certain that the joint is not subjected to bending while tightening.
8. Install the next Extension Tube over the Extension Rods.
9. Repeat steps 7 and 8 until the desired Extension length has been achieved. The desired length is approximately equal to the heat exchanger tubesheet to tubesheet length plus the length of the channel (if applicable).
10. The Channel Head Rod should be threaded onto the Extension Rods and firmly hand tighten. Keep both Rods straight to make certain that the joint is not subjected to bending while tightening. After tightening, verify that the joint cannot be loosened by hand. If it can, retighten. This is the last Rod section.
11. Install the remaining Tubes onto the Rod assembly. Remove slack from the Rod and Tube assembly by holding the last Tube and pulling on the Channel Head Rod.

12. Set the Stand-Off Ring. A Stand-Off Ring is used to set the proper Installation Depth prior to installing the plug. The Stand-Off Ring locks onto an Extension Tube by tightening a thumb screw, refer to Figure 6. Make a measurement from the middle of the ring back along the Extensions for a distance equal to the Installation Depth. Using a file, mark the Extension at that point. The mark is permanent and will allow you to check that the Stand-Off Ring is in the proper position prior to each plug installation. Slide the Stand-Off Ring to the mark and firmly tighten the thumbscrew.

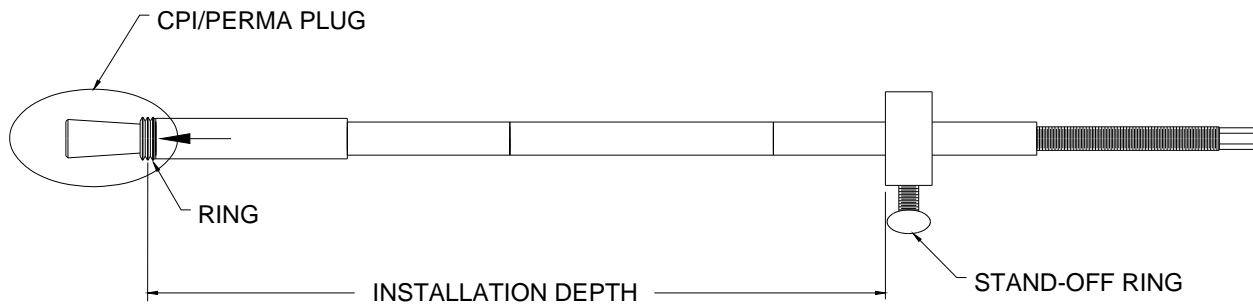

FIGURE 6. Setting Stand-Off Ring

13. Install the Rod & Tube Positioner onto the Rod assembly with arrow pointing toward the plug.
14. Thread the Knurled Nut onto the exposed threads of the Channel Head Rod to hold the assembly together during the next step. **NOTE: Do not allow the rod to turn while threading on Knurled Nut as it could result in disengaging the TTT Adapter.**
15. Plug should now be positioned for installation. When maneuvering the Pull Rod set-up make certain that it is adequately supported to avoid bending. Slide the set-up, plug end first, into the heat exchanger tube to be plugged until the standoff ring is against the tube end. Remove slack from the Rod and Tube assembly by holding the last Tube and pulling on the Channel Head Rod.
16. Remove the Knurled Nut from the Channel Head Rod without turning rod.
17. Slide the hydraulic Ram onto exposed Channel Head Rod. The Ram should be installed so the Ram piston strokes toward the operator.
18. Thread Knurled Nut onto the Channel Head Rod and firmly tighten against the Ram. Do not allow the rod to turn while threading on Knurled Nut as it could result in disengaging the TTT Adapter.
19. Install the Ram Safety Cable then the locknut onto the Pull Rod and hand tighten. Verify that the Stand-Off Ring is against the tube end.
20. While viewing the pressure gauge, press the Pump pedal to slowly pressurize the Ram. The Air Regulator, previously adjusted, will allow only the set pressure to build. If it appears that the proper installation pressure is going to be exceeded, STOP and readjust Regulator as specified above. Continue to operate the Pump until the Ram bottoms out or the previously set installation pressure is reached.

NOTE: When the Ram piston bottoms out the hydraulic pressure will reach the set pressure only because the piston is at the end of its travel. At this point it is still necessary to continue to step 19.

21. Release hydraulic pressure to allow the Ram to fully retract. Hold Ram handle while pulling on the Knurled Nut to remove any slack from the set-up. Thread Knurled Nut so it is against the Ram and firmly tighten. Do not allow rod to turn when tightening the Knurled Nut.
22. While viewing the pressure gauge, press the Pump pedal to slowly pressurize the Ram. Continue to operate the Pump until the Ram bottoms out or the proper installation pressure is reached. If the Ram bottoms out, repeat step 19. If the proper installation pressure has been reached and the Knurled Nut cannot be hand tightened by more than 1/4 of a turn after the hydraulic pressure is released, the plug has been properly installed. If the proper installation pressure has been reached and the Knurled Nut can be hand tightened more than 1/4 of a turn after the hydraulic pressure is released, repeat steps 19 and 20 until the Knurled Nut cannot be hand tightened by more than 1/4 of a turn after the hydraulic pressure is released.

NOTE: Additional Adjustment of the Regulator may be necessary during this step.

NOTE: Having to repeat steps 19 and 20, 4 to 5 times is not uncommon.

23. Released hydraulic pressure to allow the Ram to fully retract.
24. Remove the Knurled Nut and hydraulic Ram from the Rod. Do not allow the rod to turn while threading off the Knurled Nut.
25. Reinstall the Knurled Nut to ensure that no parts slip off of the Rod. Apply a light pulling force while turning the Rod clockwise to unthread the Pull Rod set-up from the installed plug. The Dual Thread Pulling Stud will remain with the installed plug. When disengaged withdraw the Pull Rod set-up from the tube. When maneuvering the Pull Rod set-up, make certain that it is adequately supported to avoid bending.

QUESTIONS? Contact EST Group Customer Service at any of the following locations with questions.

In USA and Canada: tel: 800-355-7044, fax: 215-721-1101, e-mail: est-info@curtisswright.com

In Europe: tel: +31-172-418841, fax: +31-172-418849; e-mail: est-emea@curtisswright.com

In Asia: tel: +65-6745-8560, fax: +65-6742-8700, e-mail: est-asia@curtisswright.com

On the Internet: <http://estgroup.cwfc.com>

EST Group is a business unit of Curtiss-Wright Flow Control Company. **EST Group** provides a complete range of repair products, services and replacement parts covering the life cycle of tubular heat exchangers and condensers; additionally EST Group provides products and services to facilitate pressure testing pipe, piping systems, pressure vessels and their components. Visit EST Group on the Internet at <http://estgroup.cwfc.com>.



EST Group
2701 Township Line Rd
Hatfield, PA 19440-1770 USA
(P) 215.721.1100
800.355.7044
(F) 215.721.1101
est-info@curtisswright.com
<http://estgroup.cwfc.com>

Europe / Middle East / Africa
EST Group B.V.
Hoon 312a
2404 HL Alphen aan den Rijn
The Netherlands
(P) +31.172.418841
(F) +31.172.418849
est-emea@curtisswright.com

Asia
EST Group Asia
35 Tannery Rd, #11-10 Tannery Block
Ruby Industrial Complex
Singapore 247740
(P) +65.6745.8560
(F) +65.6742.8700
est-asia@curtisswright.com

**TABLE 1. Hydraulic Installation Pressures For Use With Small Ram Package (PAP-6600) Only.
(See Table 2 for Large Ram)**

CPI / PERMA PLUG SIZE	THROUGH-THE-TUBE ADAPTER KIT		SMALL RAM INSTALLATION PRESSURE (PSI)	
	BRASS PLUGS	STAINLESS STEEL & CARBON STEEL PLUGS	BRASS PLUGS	STAINLESS STEEL & CARBON STEEL PLUGS
.471	TTT-1032	TTT-1228	1900	2100
.491		TTT-1228	2100	2100
.512		TTT-1228	2100	2100
.524		TTT-1228	2100	3000
.555		TTT-1228	2100	3000
.584		TTT-1428	2100	3100
.621		TTT-1428	2100	3100
.649		TTT-1428	2100	4000
.670		TTT-1428	2100	4000
.712		TTT-1428	3100	4000
.735		TTT-1428	3100	4000
.774		TTT-51624	3100	5300
.804		TTT-51624	3100	5300
.837		TTT-51624	3100	5300
.853		TTT-51624	3100	5300
.899		TTT-51624	3100	5300
.919		TTT-51624	4000	5300
.962		TTT-51624	4000	5300
.979		TTT-51624	4000	5300
1.024		TTT-51624	4000	6600
1.054		TTT-51624	4000	6600
1.087		TTT-51624	4000	6600
1.103		TTT-51624	4000	6600
1.149		TTT-51624	4000	6600
1.171		TTT-51624	4000	6600
1.212		TTT-51624	5300	6600

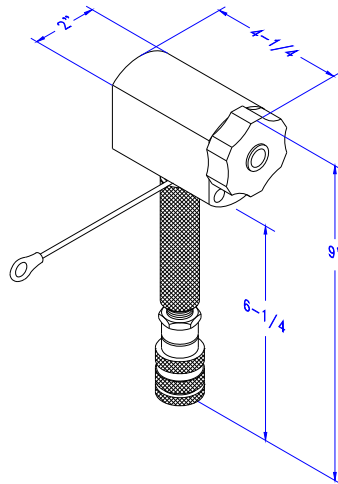

FIGURE 7. Small (White) Ram, Model PAP-6600

**TABLE 2. Hydraulic Installation Pressures For Use With Large Ram Package (PAP-1750) Only.
(See Table 1 for Small Ram)**

CPI / PERMA PLUG SIZE	THROUGH-THE-TUBE ADAPTER KIT		LARGE RAM INSTALLATION PRESSURE (PSI)	
	BRASS PLUGS	STAINLESS STEEL & CARBON STEEL PLUGS	BRASS PLUGS	STAINLESS STEEL & CARBON STEEL PLUGS
.471	TTT-1032	TTT-1228	714	789
.491		TTT-1228	789	789
.512		TTT-1228	789	789
.524		TTT-1228	789	1127
.555		TTT-1228	789	1127
.584		TTT-1428	789	1165
.621		TTT-1428	789	1165
.649		TTT-1428	789	1503
.670		TTT-1428	789	1503
.712		TTT-1428	1165	1503
.735		TTT-1428	1165	1503
.774		TTT-51624	1165	1991
.804		TTT-51624	1165	1991
.837		TTT-51624	1165	1991
.853		TTT-51624	1165	1991
.899		TTT-51624	1165	1991
.919		TTT-51624	1503	1991
.962		TTT-51624	1503	1991
.979		TTT-51624	1503	1991
1.024		TTT-51624	1503	2479
1.054		TTT-51624	1503	2479
1.087		TTT-51624	1503	2479
1.103		TTT-51624	1503	2479
1.149		TTT-51624	1503	2479
1.171		TTT-51624	1503	2479
1.212		TTT-51624	1991	2479
1.334		TTT-1220	2000	3200
1.456		TTT-1220	N/A	4300
1.578		TTT-1220	N/A	4300
1.700		TTT-1220	N/A	4300
1.822		TTT-1220	N/A	4300
1.944		TTT-1220	N/A	4300

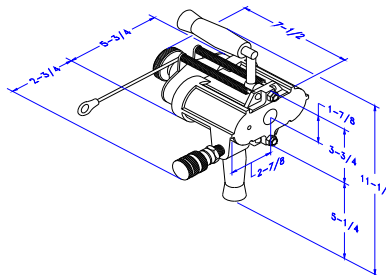

FIGURE 8. Large (Orange) Ram, Model PAP-1750

	EST Group 2701 Township Line Rd Hatfield, PA 19440-1770 USA (P) 215.721.1100 800.355.7044 (F) 215.721.1101 est-info@curtisswright.com http://estgroup.cwfc.com	Europe / Middle East / Africa EST Group B.V. Hoorn 312a 2404 HL Alphen aan den Rijn The Netherlands (P) +31.172.418841 (F) +31.172.418849 est-emea@curtisswright.com	Asia EST Group Asia 35 Tannery Rd, #11-10 Tannery Block Ruby Industrial Complex Singapore 247740 (P) +65.6745.8560 (F) +65.6742.8700 est-asia@curtisswright.com
---	--	--	---

**APPENDIX 1. Recommended CPI / Perma Plug Sizes For Use In
Through-The-Tube Plugging Applications Only**

WALL THICKNESS			TUBE OD				
BWG	DECIMAL		5/8"	3/4"	7/8"	1"	1-1/4"
10	.134	UNROLLED ID		.482	.607	.732	.982
		ROLLED ID		.509	.634	.759	1.009
		PLUG PART #	N/A	V-471	V-584	V-712	V-962
11	.120	UNROLLED ID		.510	.635	.760	1.010
		ROLLED ID		.534	.659	.784	1.034
		PLUG PART #	N/A	V-491	V-621	V-735	V-979
12	.109	UNROLLED ID		.532	.657	.782	1.032
		ROLLED ID		.554	.679	.804	1.054
		PLUG PART #	N/A	V-512	V-621	V-735	V-979
13	.095	UNROLLED ID		.560	.685	.810	1.060
		ROLLED ID		.579	.704	.829	1.079
		PLUG PART #	N/A	V-524	V-649	V-774	V-1024
14	.083	UNROLLED ID		.584	.709	.834	1.084
		ROLLED ID		.601	.726	.851	1.101
		PLUG PART #	N/A	V-555	V-670	V-804	V-1054
15	.072	UNROLLED ID	.481	.606	.731	.856	1.106
		ROLLED ID	.495	.620	.745	.870	1.120
		PLUG PART #	V-471	V-584	V-712	V-837	V-1054
16	.065	UNROLLED ID	.495	.620	.745	.870	1.120
		ROLLED ID	.508	.633	.758	.883	1.133
		PLUG PART #	V-471	V-584	V-712	V-837	V-1054
17	.058	UNROLLED ID	.509	.634	.759	.884	1.134
		ROLLED ID	.521	.646	.771	.896	1.146
		PLUG PART #	V-491	V-621	V-735	V-853	V-1103
18	.049	UNROLLED ID	.527	.652	.777	.902	1.152
		ROLLED ID	.537	.662	.787	.912	1.162
		PLUG PART #	V-512	V-621	V-735	V-853	V-1103
19	.042	UNROLLED ID	.541	.666	.791	.916	1.166
		ROLLED ID	.549	.674	.799	.924	1.174
		PLUG PART #	V-524	V-649	V-774	V-853	V-1149
20	.035	UNROLLED ID	.555	.680	.805	.930	1.180
		ROLLED ID	.562	.687	.812	.937	1.187
		PLUG PART #	V-524	V-649	V-774	V-853	V-1149
21	.032	UNROLLED ID	.561	.686	.811	.936	1.186
		ROLLED ID	.567	.692	.817	.942	1.192
		PLUG PART #	V-524	V-670	V-774	V-919	V-1149
22	.028	UNROLLED ID	.569	.694	.819	.944	1.194
		ROLLED ID	.575	.700	.825	.950	1.200
		PLUG PART #	V-524	V-670	V-774	V-919	V-1171
23	.025	UNROLLED ID	.575	.700	.825	.950	1.200
		ROLLED ID	.580	.705	.830	.955	1.205
		PLUG PART #	V-555	V-670	V-804	V-919	V-1171
24	.022	UNROLLED ID	.581	.706	.831	.956	1.206
		ROLLED ID	.585	.710	.835	.960	1.210
		PLUG PART #	V-555	V-670	V-804	V-919	V-1171

NOTE: Plug Part Numbers above do not include material designation. For recommended sizes in near end applications refer to CPI / Perma Plug rolled tube sizing chart shown in (DC1221).



EST Group
2701 Township Line Rd
Hatfield, PA 19440-1770 USA
(P) 215.721.1100
800.355.7044
(F) 215.721.1101
est-info@curtisswright.com
http://estgroup.cwfc.com

Europe / Middle East / Africa
EST Group B.V.
Hoorn 312a
2404 HL Alphen aan den Rijn
The Netherlands
(P) +31.172.418841
(F) +31.172.418849
est-emea@curtisswright.com

Asia
EST Group Asia
35 Tannery Rd, #11-10 Tannery Block
Ruby Industrial Complex
Singapore 247740
(P) +65.6745.8560
(F) +65.6742.8700
est-asia@curtisswright.com