

 BY JOHNSON CONTROLS	OPTIVIEW™ CONTROL CENTER NON-YORK CENTRIFUGAL LIQUID CHILLERS	
RENEWAL PARTS	NEW RELEASE	Form 160.10-RP1 (310)

**OPTIVIEW™ CONTROL CENTER
 025-37843-100**

- Retrofit Kits**
375-47040-101
375-47040-102
375-47040-103
375-47041-101
- 375-47045-101**
375-47045-102
375-47045-103

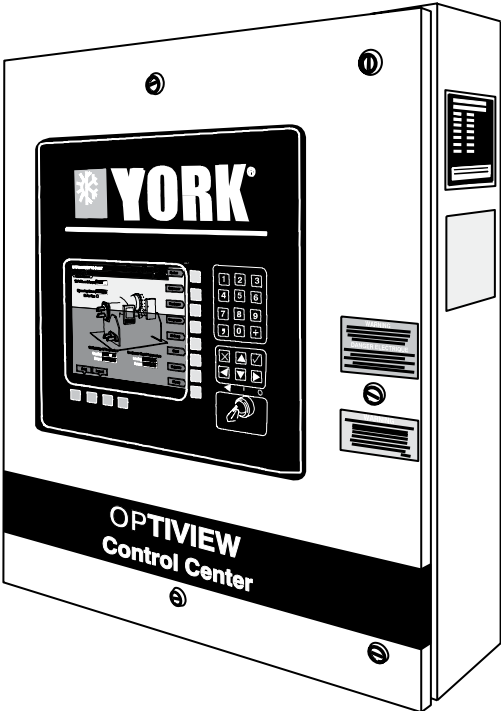

IMPORTANT!

READ BEFORE PROCEEDING!

GENERAL SAFETY GUIDELINES

This equipment is a relatively complicated apparatus. During installation, operation maintenance or service, individuals may be exposed to certain components or conditions including, but not limited to: refrigerants, materials under pressure, rotating components, and both high and low voltage. Each of these items has the potential, if misused or handled improperly, to cause bodily injury or death. It is the obligation and responsibility of operating/service personnel to identify and recognize these inherent hazards, protect themselves, and proceed safely in completing their tasks. Failure to comply with any of these requirements could result in serious damage to the equipment and the property in

which it is situated, as well as severe personal injury or death to themselves and people at the site.

This document is intended for use by owner-authorized operating/service personnel. It is expected that this individual possesses independent training that will enable them to perform their assigned tasks properly and safely. It is essential that, prior to performing any task on this equipment, this individual shall have read and understood this document and any referenced materials. This individual shall also be familiar with and comply with all applicable governmental standards and regulations pertaining to the task in question.

SAFETY SYMBOLS

The following symbols are used in this document to alert the reader to specific situations:



Indicates a possible hazardous situation which will result in death or serious injury if not proper care is not taken.



Identifies a hazard which could lead to damage to the machine, damage to other equipment and/or environmental pollution if proper care is not taken or instructions and are not followed.



Indicates a potentially hazardous situation which will result in possible injuries or damage to equipment if proper care is not taken.

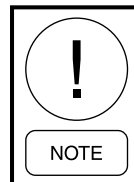

Highlights additional information useful to the technician in completing the work being performed properly.



External wiring, unless specified as an optional connection in the manufacturer's product line, is not to be connected inside the OptiView cabinet. Devices such as relays, switches, transducers and controls and any external wiring must not be installed inside the micro panel. All wiring must be in accordance with Johnson Controls' published specifications and must be performed only by a qualified electrician. Johnson Controls will NOT be responsible for damage/problems resulting from improper connections to the controls or application of improper control signals. Failure to follow this warning will void the manufacturer's warranty and cause serious damage to property or personal injury.

LIST OF TABLES

TABLE 1 - DOOR (EXTERNAL)	4
TABLE 2 - DOOR (INTERNAL)	5
TABLE 3 - INTERIOR (BACK).....	6
TABLE 4 - INTERIOR (RIGHT SIDE)	7
TABLE 5 - MICROBOARD (1730).....	8
TABLE 6 - MISCELLANEOUS COMPONENTS.....	9
TABLE 7 - TEMPERATURE SENSORS AND PRESSURE TRANSDUCERS.....	10
TABLE 8 - ELECTRICAL COMPONENTS (NOT ILLUSTRATED)	11

Changeability of this Document

This document is subject to change without notice. YORK makes no commitment to automatically update or provide current information to the manual owner. Current information can be obtained at www.york.com, or by contacting the nearest YORK Service office or the YORK Parts Distribution Center.

Operating/service personnel maintain the responsibility of the applicability of this document to the equipment being serviced. Contact the equipment owner prior to performing any work on the chiller to verify equipment modifications and availability of current literature.

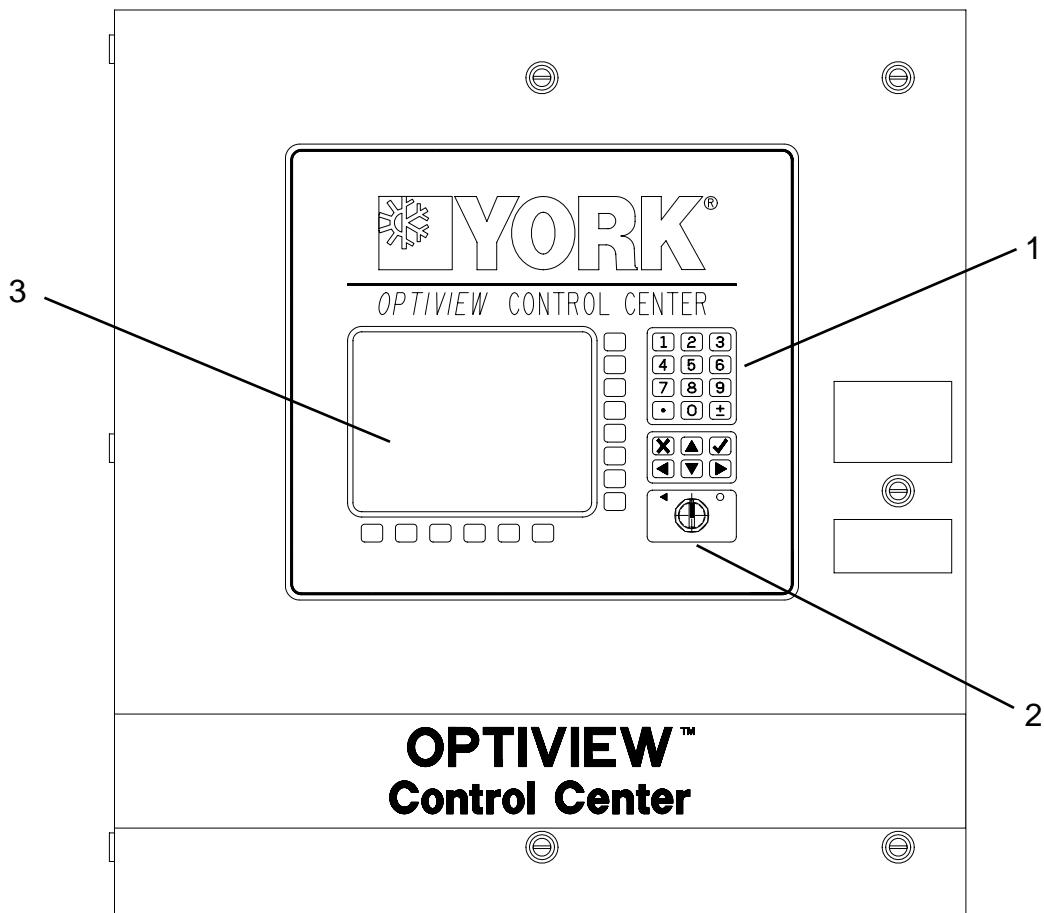

LD12242

TABLE 1 - DOOR (EXTERNAL)

Item	Part No.	Description	Quantity
1	024 30994 000	Keypad	1
2	024 30931 000	Selector Switch	1
3	331 01771 000	Display Kit (See Notes 1 and 2)	1

1. The Display Kit (Item 3) contains a Liquid Crystal Display, Display Interface Board (Item 5), Display Interface Board Ribbon Cable (Item 6), Backlight Bulb (Item 7), Backlight Inverter Board (Item 8), Backlight Inverter Board Ribbon Cable (Item 9), and mounting hardware. All components are matched based on Liquid Crystal Display manufacturer. **Non-compatible components will not operate properly!**

a. The Liquid Crystal Display is only available in kit 331-01771-000 with compatible components.

b. The Display Interface Board (Item 5), Display Interface Board Ribbon Cable (Item 6), Backlight Bulb (Item 7), Backlight Inverter Board (Item 8), and Backlight Inverter Ribbon Cable (Item 9) can be ordered individually per the component parts list label on the side of the display. Refer to Table 2.

2. Display Kit installation requires configuration of Microboard program jumpers. The program jumpers must be configured by a qualified Service Technician following instructions in YORK Service Manual 160.55-M1. Program jumper positions are also noted on the label on the side of the display. Refer to Table 2.

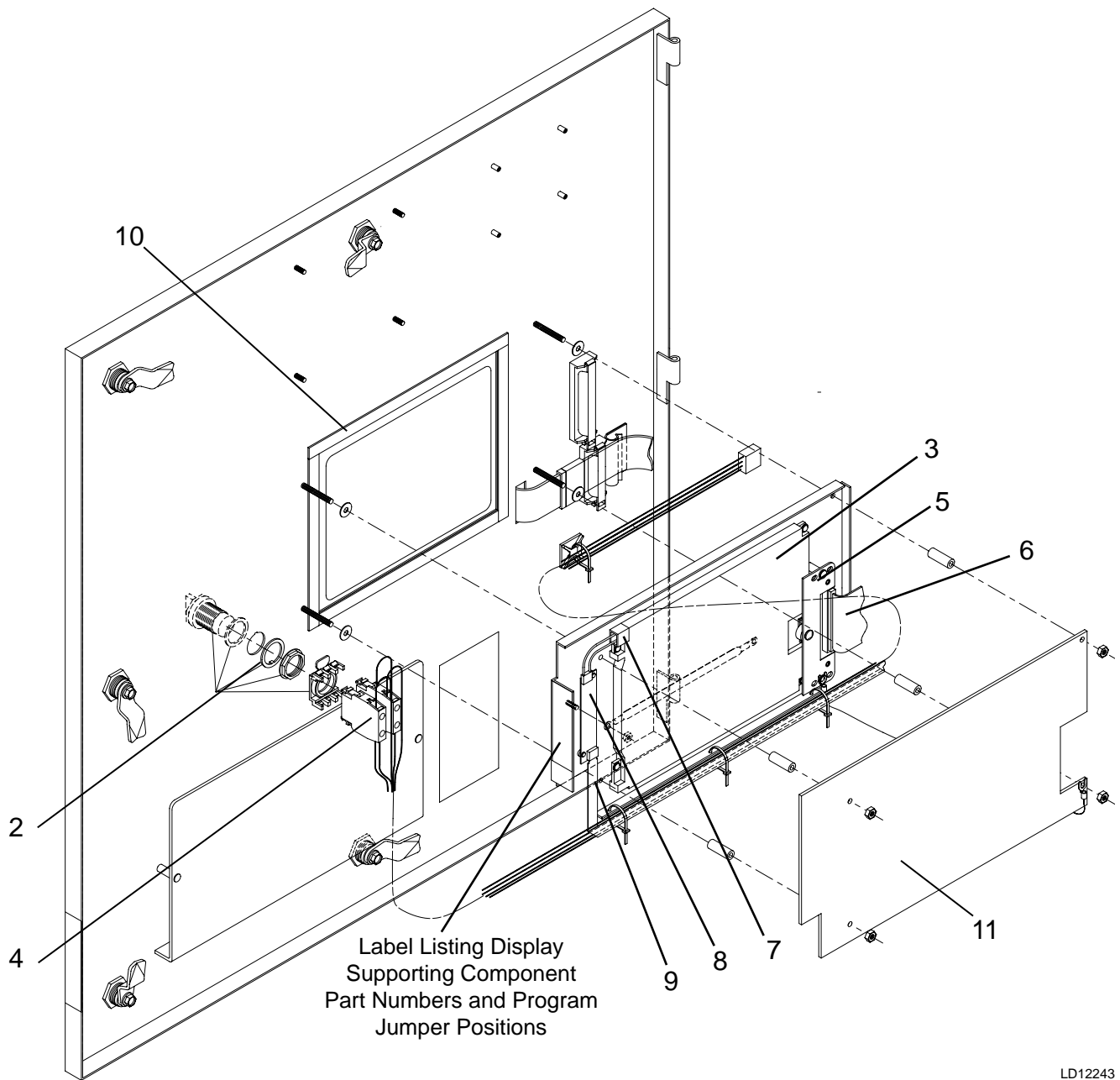

LD12243

TABLE 2 - DOOR (INTERNAL)

Item	Part No.	Description	Quantity
4	024 30932 000	Contact Block	2
5	See Note 1	Display Interface Board	1
6	See Note 1	Display Interface Board Ribbon Cable	1
7	See Note 1	Backlight Bulb	1
8	See Note 1	Backlight Inverter Board	1
9	See Note 1	Backlight Inverter Board Ribbon Cable	1
10	028 07533 000	Neoprene Strip	2.8 Ft.
11	071 02264 346	Display Cover	1

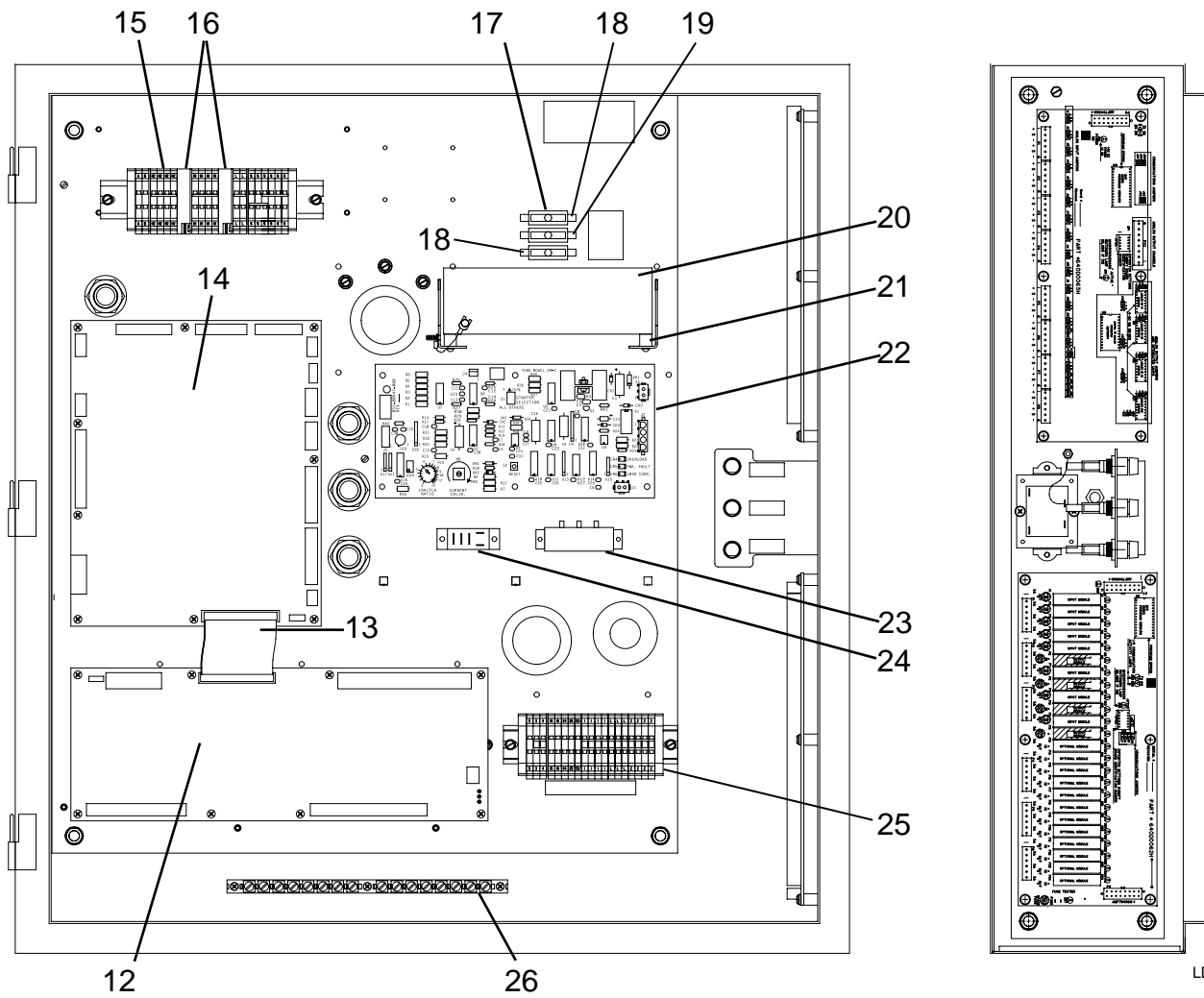

LD12244

TABLE 3 - INTERIOR (BACK)

Item	Part No.	Description	Quantity
12	031 01743 002	Input/Output Board	1
13	031 01779 000	Ribbon Cable	1
14	See Page 8	Microboard	1
15	025 37819 000	Terminal Block (TB7)	1
16	025 14384 000	Fuse (2FU, 3 FU, 7FU, 8FU)	4
17	025 34565 000	Fuseholder	1
18	025 15759 000	Fuse 5A (4FU, 6FU)	2
19	025 34566 000	Fuse 4A (5FU)	1
20	025 34111 000	Power Supply	1
21	021-19191-000	Anit-Vibration Mount	4
22	031 00947 000	CM-2 Current Control Module	1
23	575 00364 001	Resistor Assembly [consists of (2) 025-20789-000 Variable Resistors]	1
24	031 00210 000	Diode Bridge	1
25	025 33290 000	Terminal Block (TB6)	1
26	025 34122 000	Buss Bar (Ground)	1

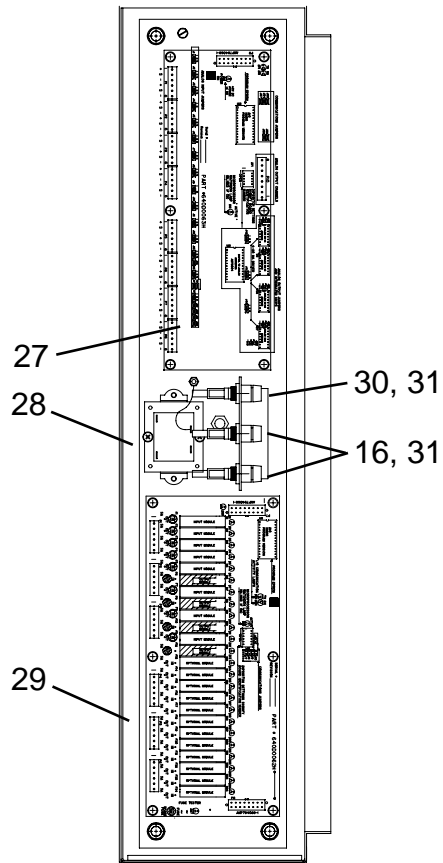

LD12245

TABLE 4 - INTERIOR (RIGHT SIDE)

Item	Part No.	Description	Quantity
27	371 02777 000	Analog Input/Output Board	1
28	025 30889 000	Transformer	1
29	071 03718 000	Digital Input/Output Board	1
29A	025 37818 000	AC Output Module	8
29B	025 37817 000	AC Input Module	4
29C	025 37818 001	DC Output Module	2
30	025 14019 000	Fuse 5A (1FU)	1
31	025 13991 000	Fuseholder (For Items 16, 30)	3

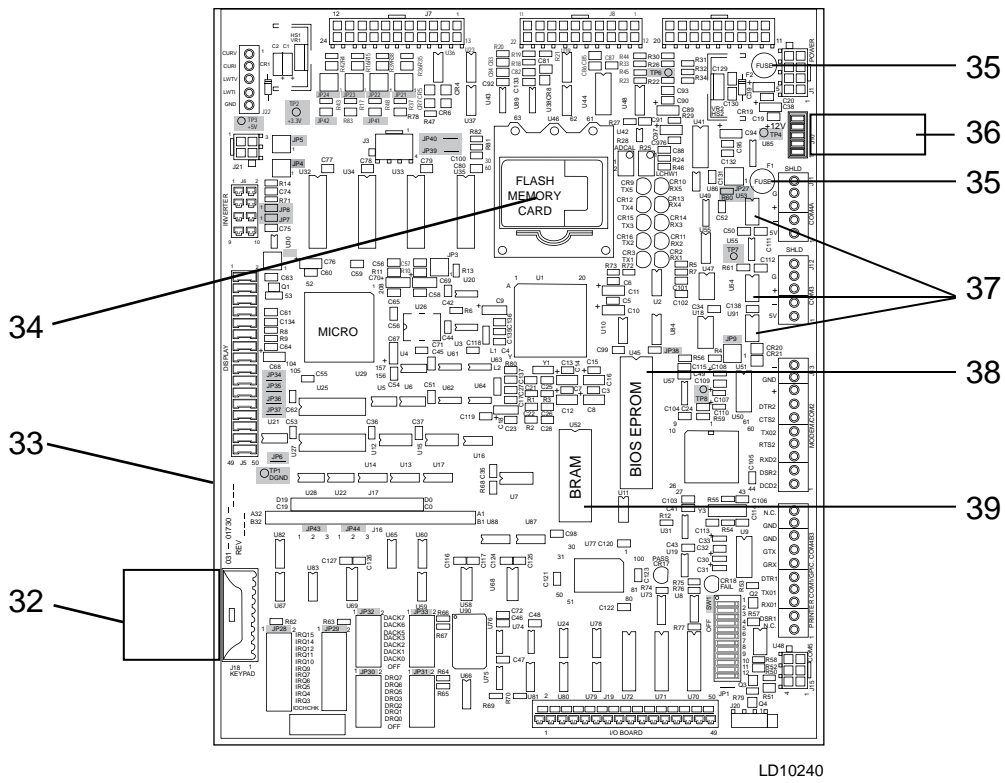

LD10240

TABLE 5 - MICROBOARD (1730)

Item	Part No.	Description	Quantity
32	031 02015 000	Ribbon Cable (To Keypad on Door)	1
33	331 01730 623	Microboard Kit (Carrier only) (See Note 3)	1
	331 01730 626	Microboard Kit (Trane only) (See Note 3)	1
34	031 02403 001	Flash Memory Card (Carrier only) (See Note 4)	1
	031 02406 001	Flash Memory Card (Trane only) (See Note 4)	1
35	025 34592 000	Fuse 5A (F1, F2)	2
36	031 01779 000	Ribbon Cable (To CM-2 Current Control Module)	1
37	031 02074 000	RS-485 Driver IC	3
38	031 01796 002	BIOS Eprom (U45) (See Note 5)	1
39	031 02028 000	BRAM U52 IC	1

Notes:

3. Microboard Kits consist of Flash Memory Card (Item 33), BIOS Eprom (Item 37) and BRAM (Item 38)

4. Flash Memory Card (Item 34) version analysis:

C.MLM.nn.nn.nnn

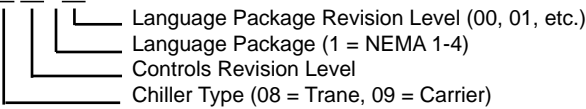

5. BIOS Eprom (Item 38) version analysis:

C.OPT.00.nn

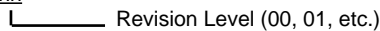

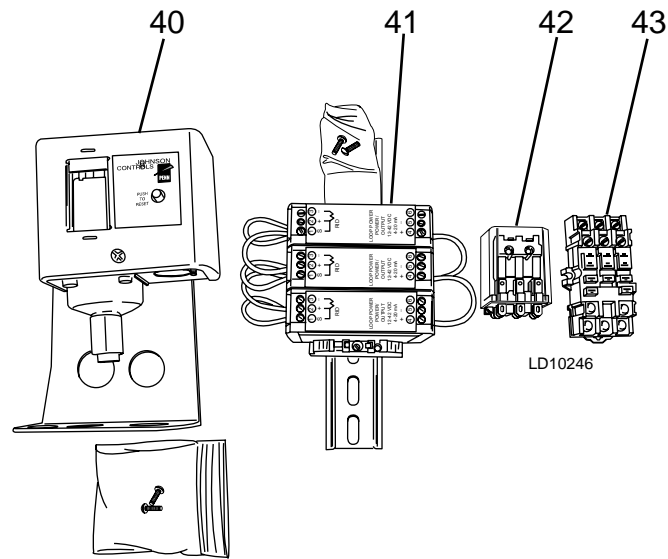

TABLE 6 - MISCELLANEOUS COMPONENTS

Item	Part No.	Description	Quantity
40	225 14385 002	Pressure Control (HPCO)	1
41	025 37826 001	RTD Module (Trane only) (See Note 6)	3
42	025 27509 010	3PDT Relay	1
43	024 24953 000	Relay Socket (For Item 42)	1
---	031 00808 000	Surge Suppressor	Varies

Notes:

6. The RTD Module DIP switches must be set to the proper position. Three (3) required for RTD Assembly 371-03728-000 and 371-03728-601.

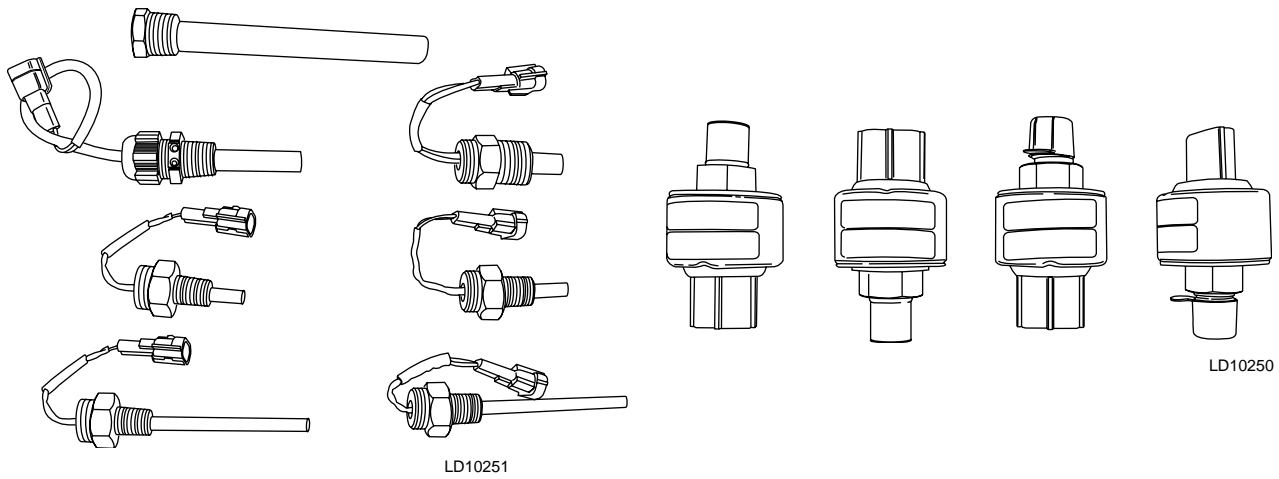

TABLE 7 - TEMPERATURE SENSORS AND PRESSURE TRANSDUCERS

Sensor	Part No.	Description	Quantity
1, 4, 5, 9	025 29964 000	Temperature Sensor, 3/8-18 NPT x 3.00", 3k Ohm	4
2	025 37825 004	Temperature Sensor, 1/2-14 NPT x 0.68", 50k Ohm	1
3	025 37825 002	Temperature Sensor, 1/4-18 NPT x 3.00", 50k Ohm	1
6,7	025 37827 001	Temperature Sensor, 1/4-18 NPT x 0.68", 3k Ohm	2
	025 37827 002	Temperature Sensor, 1/4-18 NPT x 3.00", 3k Ohm	1
15, 16	025 37825 001	Temperature Sensor, 1/4-18 NPT x 0.68", 50k Ohm	2
---	026 32328 000	Thermo Well	4
10	025 29148 003	Pressure Transducer (Carrier Low Pressure and Trane only)	1
	025 28678 001	Pressure Transducer (Carrier High Pressure only) (R-134a only)	
	025 28678 004	Pressure Transducer (Carrier High Pressure only) (R-22 only)	
11	025 29148 103	Pressure Transducer (Carrier Low Pressure and Trane only)	1
	025 28678 104	Pressure Transducer (Carrier High Pressure only) (R-134a only)	
	025 28678 102	Pressure Transducer (Carrier High Pressure only) (R-22 only)	
12	025 29148 009	Pressure Transducer (Carrier Low Pressure and Trane only)	1
	025 28678 001	Pressure Transducer (Carrier High Pressure only)	
13	025 29148 008	Purge Pressure Transducer	1
14	025 29148 004	Pressure Transducer (Carrier Low Pressure and Trane only)	1
	025 28678 001	Pressure Transducer (Carrier High Pressure only)	

Sensor and Transducer Legend:

- | | |
|---|--|
| 1 = Leaving Chilled Liquid Temperature Sensor | 10 = Low Oil Pressure Transducer |
| 2 = Compressor Discharge Temperature Sensor | 11 = Evaporator Pressure Transducer |
| 3 = Oil Sump Temperature Sensor | 12 = Condenser Pressure Transducer |
| 4 = Leaving Condenser Water Temperature Sensor | 13 = Purge Pressure Transducer |
| 5 = Entering Condenser Water Temperature Sensor | 14 = High Oil Pressure Transducer |
| 6 = Drop Leg Refrigerant Temperature Sensor (if used) | 15 = Inboard Bearing Temperature Sensor |
| 7 = Evaporator Refrigerant Temperature Sensor (if used) | 16 = Outboard Bearing Temperature Sensor |
| 8 = Vent Line Solenoid Valve (if used) | |
| 9 = Entering Chilled Liquid Temperature Sensor | |

TABLE 8 - ELECTRICAL COMPONENTS (NOT ILLUSTRATED)

Connector Number	Part No.	Description	Quantity
P1	571 02264 272	Harness, 8" (Includes P1, P2, P30, J32)	1
	025 34144 000	Connector Housing, 8 Position (Microboard)	1
P1	025 34503 000	Connector Housing, 5 Position (Power Supply)	1
P2	025 34504 000	Connector Housing, 13 Position (Power Supply)	1
P2	025 21417 000	Connector Housing, 4 Position (CM-2 Board)	1
P3	025 19667 000	Connector Housing, 2 Position	1
P7	025 34533 000	Connector Housing, 24 Position	1
P8	025 34117 000	Connector Housing, 22 Position	1
P9	025 34116 000	Connector Housing, 20 Position (Microboard)	1
P9	025 34143 000	Connector Housing, 16 Position (Analog & Digital I/O Boards)	2
J10	025 19670 000	Connector Housing, 6 Position (To Display)	1
P10	025 20963 000	Connector Housing, 6 Position (From Display)	1
J30	025 34147 000	Connector Housing, 12 Position	1
P30	025 28384 000	Connector Housing, 12 Position	1
J31	025 27974 000	Connector Housing, 2 Position	1
P31	025 19667 000	Connector Housing, 2 Position	1
J32	025 34557 000	Connector Housing, 8 Position	1
P32	025 34144 000	Connector Housing, 8 Position	1
---	025 19674 000	Contact Socket for P3, P31	4
---	025 25157 000	Contact Sockets for P1 (Power Supply), P2 (Power Supply)	12
---	025 22215 000	Contact Sockets for J10	5
---	025 28386 000	Contact Sockets for P8, P9, P30	18
---	025 34145 000	Contact Sockets for P1 (Microboard), P32	8
---	025 18443 000	Contact Pins for J31	1
---	025 22214 000	Contact Pin for P10	5
---	025 30999 000	Contact Pins for J30	4
---	025 34563 000	Contact Pins for J32	2

See *Electrical Connectors, All Products*, Form 50.20-RP1 for temperature sensor and pressure transducer connectors, shielded cable, and application/extraction tools.



BY JOHNSON CONTROLS

P.O. Box 1592, York, Pennsylvania USA 17405-1592
Copyright © by Johnson Controls 2010
Form 160.10-RP1 (310)
Supersedes: Nothing

Tele. 800-861-1001
www.york.com

Subject to change without notice. Printed in USA
ALL RIGHTS RESERVED