

ROTALOCK VALVES

The function of a Rotalock Valve is to provide a convenient removable access and isolation point for service.

Applications

Rotalock Valves are widely used throughout the refrigeration and air-conditioning industry and are typically installed on Compressors and Pressure Vessels. Henry Technologies' Rotalock Valves are suitable for use with HCFC and HFC refrigerants and their associated oils, as well as other industrial fluids non-corrosive to steel, copper and Teflon.

Main Features

- Industry standard Rotalock thread sizes
- ODS and SAE flare connections
- 1/2" SAE Flare access ports
- Minimal pressure drop
- Removable
- Bi-directional flow
- Seal cap design

Technical Specifications

Maximum working pressure = 500 PSI (34.5 Bar)

Allowable operating temperature = -20°F to +250°F (-29°C to +121°C)

Materials of Construction

The valve and connections are made from plated steel. The connection gasket is made from Teflon. The seal caps are made of plated steel and use a copper gasket.

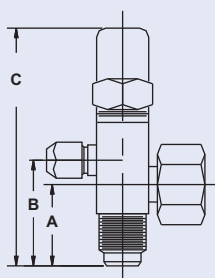

FIG 1

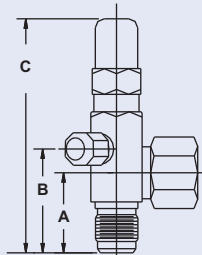

FIG 2

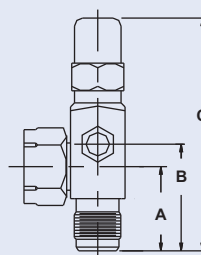

FIG 3

FLARE CONNECTIONS

Part No (with gasket)	Fig No	SAE Flare (inch)	Rotalock Thread Size (inch)	Dimensions (inch)		
				A	B	C
3-030-131	2	1/4	3/4 -16	1.17	1.52	3.42
3-030-122	1	3/8	3/4 -16	1.17	1.52	3.42
3-030-123	2	3/8	3/4 -16	1.17	1.52	3.72
3-030-130	2	3/8	3/4 -16	1.17	1.52	3.42
3-030-108	1	1/2	1 - 14	1.30	1.72	3.75
3-030-135	3	1/2	1 - 14	1.30	1.72	3.75
3-030-112	1	5/8	1 - 14	1.55	1.97	4.00

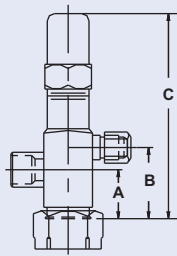

FIG 4

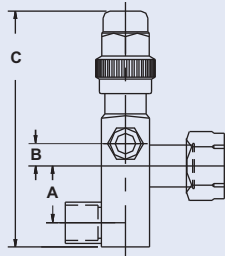

FIG 5

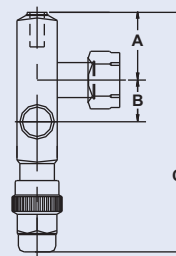

FIG 6

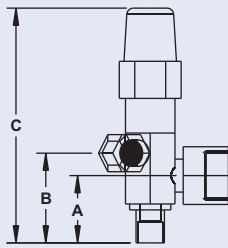

FIG 7

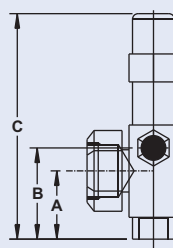

FIG 8

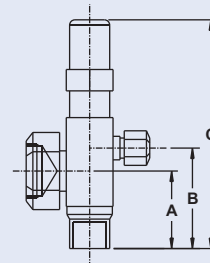

FIG 9

ODS CONNECTIONS

Part No (with gasket)	Fig No	ODS (inch)	Rotalock Thread Size (inch)	Dimensions (inch)		
				A	B	C
3-030-139	7	3/8	3/4 - 16	1.02	1.36	3.56
3-030-133	8	1/2	1 - 14	1.22	1.63	4.06
3-030-140	4	1/2	1 - 14	0.88	1.28	3.69
3-030-127	9	5/8	1 - 14	1.45	1.88	4.28
3-030-150	4	5/8	1 - 14	0.85	1.27	3.63
3-030-152	9	5/8	1 - 14	1.45	1.88	4.36
3-030-163	5	5/8	1 - 14	1.03	0.41	4.28
3-030-164	5	5/8	1 - 14	2.64	0.41	5.89
3-030-167	6	5/8	1 - 14	1.47	2.38	5.20
3-030-186	9	5/8	1 1/4 - 12	1.67	2.34	5.05
3-030-136	9	7/8	1 1/4 - 12	1.69	2.34	5.38
3-030-141	4	7/8	1 1/4 - 12	1.08	1.74	4.77
3-030-142	4	1 1/8	1 1/4 - 12	1.09	1.75	4.78
3-030-143	4	1 3/8	1 3/4 - 12	1.47	2.31	6.19
3-030-160	7	1 3/8	1 3/4 - 12	2.82	3.26	7.16
3-030-162	7	1 5/8	1 3/4 - 12	2.47	3.31	7.16

REPLACEMENT GASKET

Part No	Rotalock Thread Size (inch)
2-023-018	3/4 - 16
2-023-013	1 - 14
2-023-015	1 1/4 - 12
2-023-016	1 3/4 - 12

ROTALOCK ADAPTERS

The function of a Rotalock Adapter is to provide a convenient removable piping connection to system components.

Applications

Rotalock Adapters are used to connect piping to compressors, pressure vessels and other components when an access or isolation point is unneeded. Henry Technologies' Rotalock Adapters are suitable for use with HCFC and HFC refrigerants and their associated oils, as well as other industrial fluids non-corrosive to steel, and Teflon.

Main Features

- Industry standard Rotalock thread sizes
- ODS connections
- Straight-thru and angle designs
- Removable

Technical Specifications

Maximum working pressure = 500 PSI (34.5 Bar)

Allowable operating temperature = -20°F to +250°F (-29°C to +121°C)

Materials of Construction

The adapter body and connections are made from plated steel. The connection gasket is made of Teflon.

Part No	Part No (with gasket)	Connection Size (inch)	Rotalock Thread Size (inch)	Description
2-030-153	N/A	3/8 ODS	3/4 - 16 Female	Straight thru adapter
2-030-159	3-030-001	1 - 14 Male Rotalock	3/4 - 16 Female	Straight thru adapter
2-030-171	3-030-002	3/4 - 16 Male Rotalock	1 - 14 Female	Straight thru adapter
2-030-166	N/A	5/8 ODS	1 - 14 Female	Straight thru adapter
2-030-128	N/A	5/8 ODS	1 - 14 Female	Angle adapter
2-030-137	N/A	7/8 ODS	1 1/4 - 12 Female	Angle adapter

REPLACEMENT GASKET	
Part No	Rotalock Thread Size (inch)
2-023-018	3/4 - 16
2-023-013	1 - 14
2-023-015	1 1/4 - 12
2-023-016	1 3/4 - 12