



User Instructions

Tracer™ TU Communication Adapter

The Tracer TU Communication Adapter (referred to simply as “the Adapter”) makes your job easier by allowing the Tracer TU service tool to connect to a remote, hard to reach unit controller through a zone sensor.

This instruction sheet first describes the components included with the Adapter. It then explains Adapter connection and operation.

Packaged Contents

This order number includes the following items:

- One (1) Tracer TU Communications Adapter
- One (1) USB connector for use between a laptop PC and the Adapter.
- One (1) cable equipped with RJ22 modular plugs.

Note: *Visually inspect contents for obvious defects or damage. All components have been thoroughly inspected before leaving the factory. Any claims for damage incurred during shipment should be filed with the carrier.*

Connecting and Starting the Adapter

Complete the following steps to start the Adapter and connect it to a unit controller as shown in Figure 1 on the following page.

1. Connect the Adapter to your laptop using the standard USB cable.
2. Connect the Adapter to a zone sensor using the RJ22 cable.

Notes:

- *The Adapter is designed exclusively for use with the new generation of Trane controllers (UCxxx). Do not use the Adapter with ZN, VV, AH LonTalk communicating controls.*
- *Before you use the Adapter, ensure that the zone sensor has wired communication with the unit controller. (See the sensor’s installation instructions for details.)*

Figure 1. Connecting to a zone sensor through the Adapter

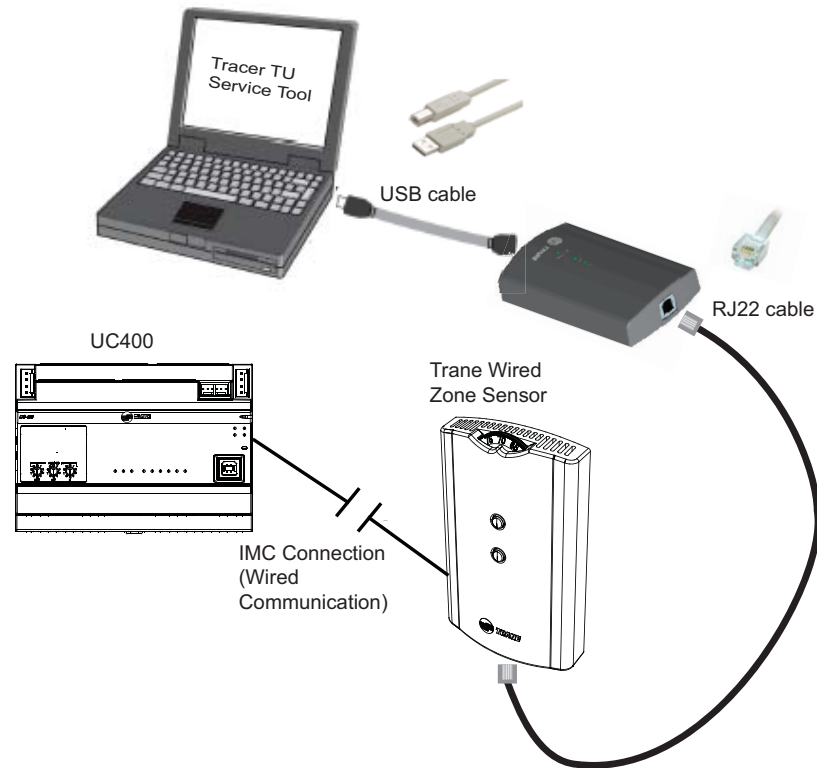

Adapter Operations

Once the Adapter is connected and communication with the unit controller has been established, you can use the Tracer TU service tool as if you were directly connected to the controller.

Adapter power

The USB cable connecting the laptop to the Adapter provides power through the laptop USB port. No other connection is necessary to power the Adapter.

Note: *USB allows a number of devices to share a link. Any USB host (laptop) is required to provide 500 mA at 5 Vdc. The power requirements of the Adapter have been minimized so that the Adapter can share the USB link with other devices. However, the total current draw of all connected devices cannot exceed 500 mA.*

Notice:

Excessive Current Draw

In rare situations, a short in the Adapter can cause current draw in excess of 500 mA. If this does occur, most computers issue a message and automatically shut down the USB port. You are advised to pull the USB cable quickly and contact Trane about this problem.

Tracer™ TU Communication Adapter

Normal operation

Connecting the Adapter to a laptop PC starts the Adapter. A successful start is indicated when the Status LED changes from solid red to solid green. (See Figure 2.)

When communication with the unit controller is established, the Receive LED flashes amber as data is received from the unit controller, and the Transmit LED flashes green as data is sent from the Adapter to the unit controller. (See Figure 2.)

Figure 2. Adapter communication status indicated by LEDs

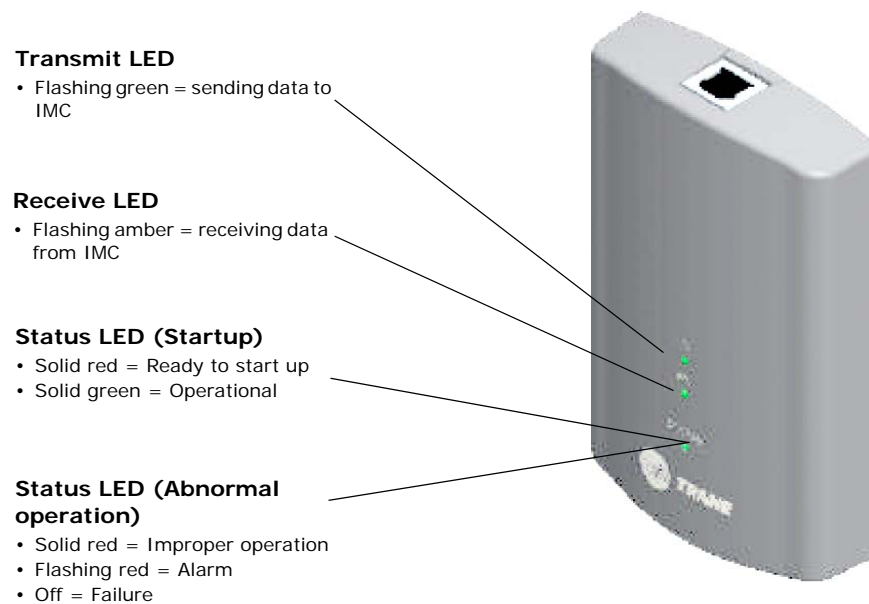

Abnormal operation

The Status LED can also indicate abnormal operation. A shift from solid green to flashing red indicates that an internal alarm has occurred. A solid red Status LED indicates that the Adapter has encountered an error condition or improper operation.

In these situations, disconnect and reconnect the Adapter directly, or (1) click the Safely Remove Hardware icon, (2) select the Adapter, (3) click Stop, (4) remove the USB cable from the laptop USB port, and (5) reconnect it to the USB port.

The following table lists possible running conditions or error causes and their corresponding Status LED indicators.

Running Condition/Error Cause	LED Status	Operating Phase
No power	Off	Start up
Ready to start up	Solid red	Start up
Boot failure	Solid red	Start up
Normal operation	Solid green	Operational
USB communication error	Solid red	Operational
RS485 communication error	Solid red	Operational

Turning off the Adapter

To turn off the Adapter, disconnect the USB cable connecting it to your laptop.

Best Practices

To make the most effective use of the Adapter, observe the following best practices.

- The Adapter is best suited for making changes to selected setpoints or point configurations. However, if you must make extensive changes to configuration variables or setpoints, it is best to connect directly to the controller with a USB cable.
- Avoid updating device application firmware through the Adapter.
- Avoid transferring large TGP2 files or performing backup and restore operations.
- Use care when detaching the RJ22 connector from the zone sensor. The RJ22 is a locking connector. If pulled sharply, it can damage the zone sensor.

Adapter Dimensions

Figure 3 shows the dimensions of the Adapter in millimeters and inches (mm [inches]).

Figure 3. Adapter dimensions

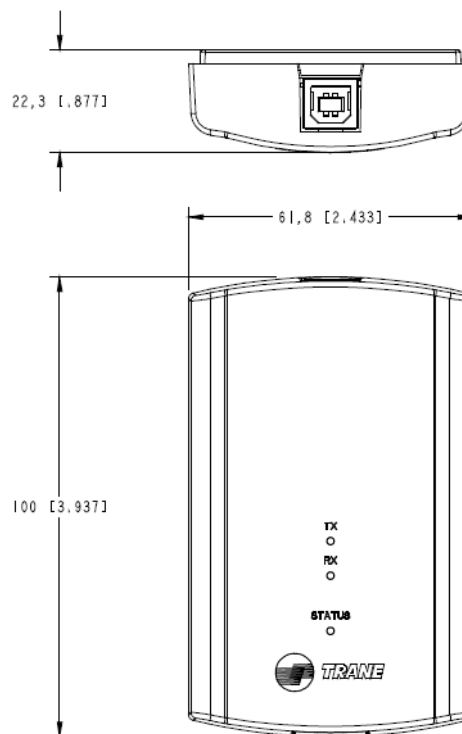

Trane and the Trane logo are trademarks of Trane in the United States and other countries. All trademarks referenced in this document are the trademarks of their respective owners.

Literature Order Number	X39641115-01A
Date	September 2008
Supersedes	New

www.trane.com

For more information, contact your local Trane office or e-mail us at comfort@trane.com

Trane has a policy of continuous product and product data improvement and reserves the right to change design and specifications without notice.